

# DEVELOPMENT SITE PLAN

266 MAIN STREET  
 41 WHARF STREET  
 43 WHARF STREET  
 45 WHARF STREET  
 47 WHARF STREET

VILLAGE OF WELLINGTON  
 COUNTY OF PRINCE EDWARD

SCALE 1:500



## LEGEND

- EXISTING COMMERCIAL BUILDING
- EXISTING TOURIST ACCOMMODATION (12 UNITS)
- PROPOSED TOURIST ACCOMMODATION (6 UNITS)
- DECK AREA
- LANDSCAPED AREA / EXISTING VEGETATION
- ASPHALT AREA
- TOURIST ACCOMMODATION PARKING-DRAKE MOTOR INN (18 SPACES)
- BREWERY PARKING (EXISTING) (16 SPACES)
- DRAKE DEVONSHIRE INN PARKING (48 SPACES)
- SURPLUS PARKING / FUTURE LANDSCAPED AREA (19 SPACES)
- WALKWAY/PATIO AREA
- LANE CREEK
- TREE LINE
- RETAINING WALL
- EXISTING FLOODPLAIN
- PROPOSED FLOODPLAIN
- 6m SETBACK FROM FLOODPLAIN
- EXISTING BUILDING
- PROPOSED SEVERANCE/LOT LINE
- EXISTING TREES TO BE RETAINED

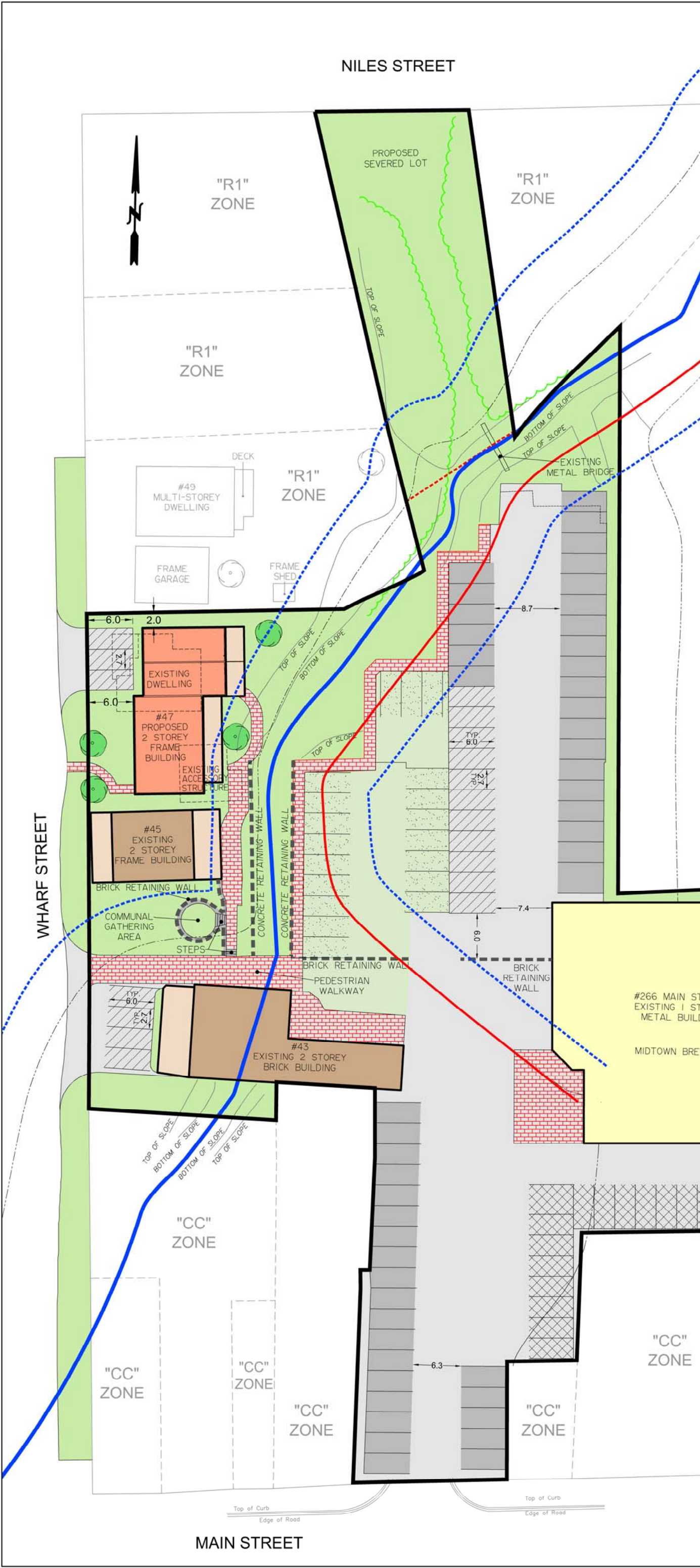

No.	REVISION	DATE	APPR'D
DRAWN BY: D.B. & A.C		CHECKED BY: R.F.A.	DATE: 07/13/21

JULY 13, 2021

**RFA**  
 PLANNING CONSULTANT INC.  
 211 Dundas Street East, Suite 202  
 Belleville, Ontario, K8N 1E2