

RR2

**PROPOSED SEVERED LOT A**  
3.00 ha

LOT 77  
CONCESSION 6

**PROPOSED RETAINED LOT**  
7.94 ha  
(L.O.S 98.7%)

**PROPOSED SEVERED LOT B**  
1.75 ha

COUNTY ROAD No. 2

\*NOTE: MDS SETBACK IS 104m SOUTH OF SOUTHERN PROPERTY LINE

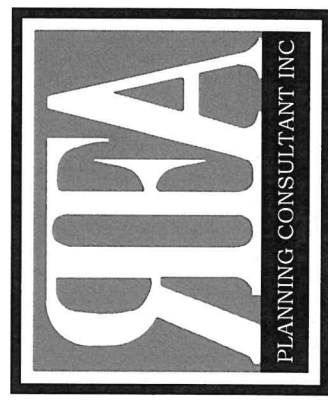

211 Dundas Street East, Suite 202,  
Belleville, Ontario, K8N 1E2  
JOB No. 802-CS

- LEGEND**
- (S) EXISTING SEPTIC SYSTEM
  - (W) EXISTING WELL
  - ▭ EXISTING DRIVEWAY
  - ▭ EXISTING BUILDING

**LAND USE SUMMARY**

PROPOSED RETAINED LOT	AREA (ha)	AREA (%)
PROPOSED SEVERED LOT A	7.94	62.5
PROPOSED SEVERED LOT B	3.00	23.7
TOTAL SITE AREA	12.70	100.0%

**METRIC NOTE:**  
ALL DIMENSIONS ARE IN METRES AND CAN BE CONVERTED TO FEET BY DIVIDING BY 0.3048.  
**CONTOURS NOTE:**  
EXISTING TOPOGRAPHY PREPARED BY GREER GALLOWAY. CONTOURS SHOWN AT INTERVALS OF 0.3M.

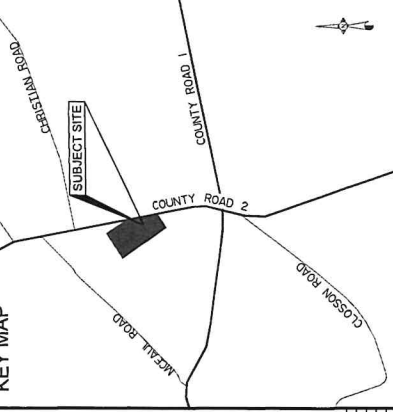

**CONSENT SKETCH**  
MICHELLE NORLOCK  
PART OF LOT 77, CONCESSION 6  
PART 5 AND 7, PLAN 47R-3571  
TOWNSHIP OF HILLIER  
COUNTY OF PRINCE EDWARD

SCALE: 1:1500  
DATE: JUNE 3, 2021

DATE	BY

DATE: 06/03/21