

VICT LAND
ORIAL SCAP
TAY ARCHI
LOR TECT

VTLA STUDIO
VICTORIA TAYLOR
LANDSCAPE ARCHITECT MES MLA OALA CSLA

240 STERLING ROAD TORONTO M6R 2B9
+1 416 837 0344 VTLA.CA

THE WELLINGTON HOTEL





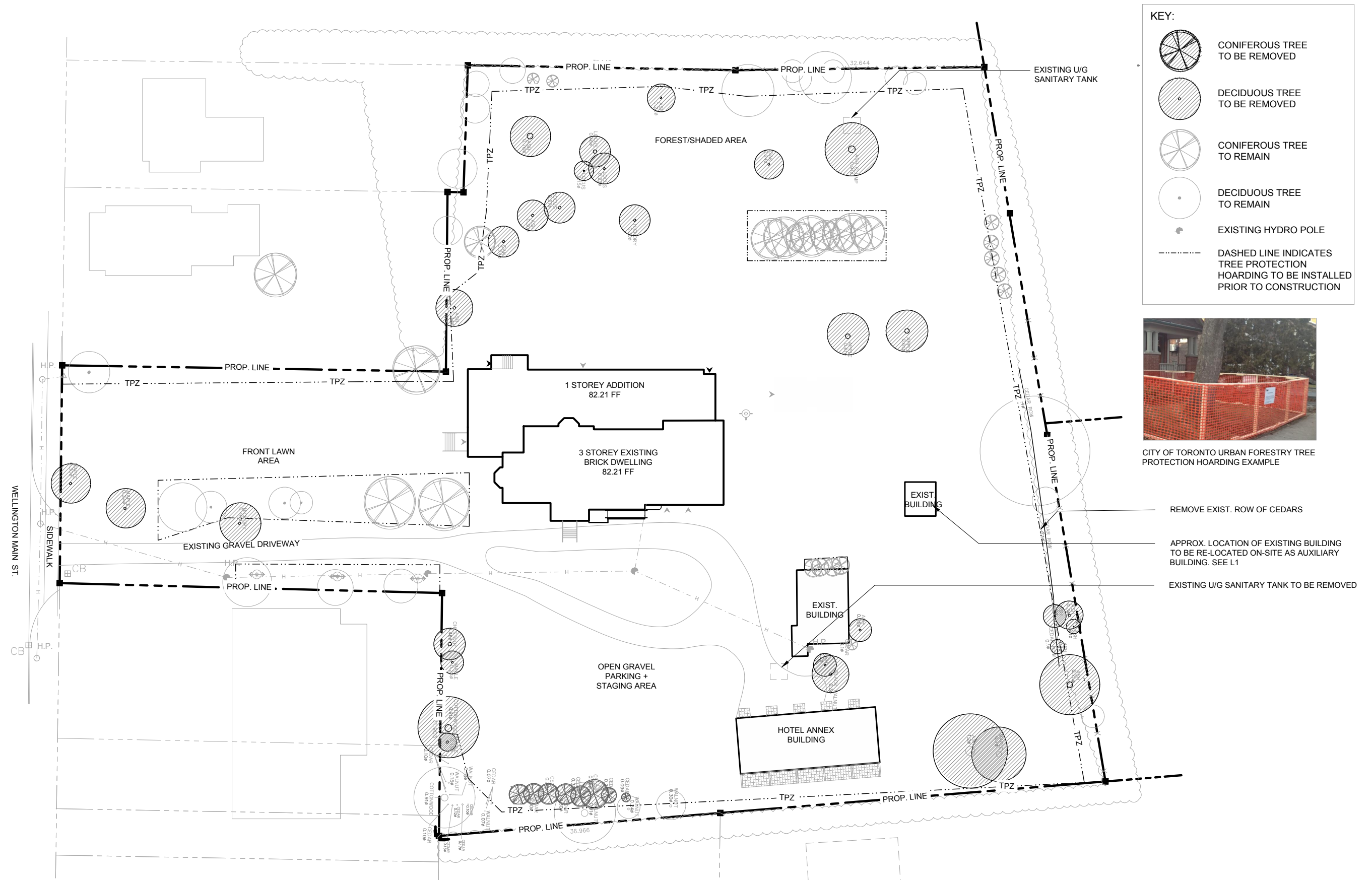

192 MAIN STREET, WELLINGTON ON K0K3L0

ISSUED: 2 DECEMBER, 2021, FOR SITE PLAN APPROVAL

L0 EXISTING SITE - TREE PROTECTION + TREE REMOVAL
L1 LANDSCAPE LAYOUT MASTER PLAN



KEY:

-  CONIFEROUS TREE TO BE REMOVED
-  DECIDUOUS TREE TO BE REMOVED
-  CONIFEROUS TREE TO REMAIN
-  DECIDUOUS TREE TO REMAIN
-  EXISTING HYDRO POLE
-  DASHED LINE INDICATES TREE PROTECTION HOARDING TO BE INSTALLED PRIOR TO CONSTRUCTION



CITY OF TORONTO URBAN FORESTRY TREE PROTECTION HOARDING EXAMPLE

- REMOVE EXIST. ROW OF CEDARS
- APPROX. LOCATION OF EXISTING BUILDING TO BE RE-LOCATED ON-SITE AS AUXILIARY BUILDING. SEE L1
- EXISTING U/G SANITARY TANK TO BE REMOVED

VICTORIA TAYLOR
LANDSCAPE ARCHITECT

**VICTORIA TAYLOR
LANDSCAPE ARCHITECT** MLA OALA
240 STERLING ROAD TORONTO M6R 2B9
+1 416 837 0344 VICTORIATAYLOR.CA

PROJECT: **THE WELLINGTON HOTEL**
192 MAIN STREET, WELLINGTON, PEC
DRAWING: **TREE PROTECTION + REMOVAL**
DATE: DECEMBER 2021
SCALE: 1:500
DRAWN BY: VTLA

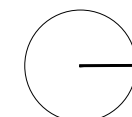

ISSUED RECORD:

No.	YY MM DD	Issued
1	21 11 08	FOR CLIENT RECORDS
2	21 12 02	FOR SITE PLAN APPROVAL
3		
4		
5		
6		
7		
8		

THIS DRAWING IS THE PROPERTY OF THE LANDSCAPE ARCHITECT AND MAY NOT BE REPRODUCED OR USED WITHOUT THE PERMISSION OF THE LANDSCAPE ARCHITECT. THE CONTRACTOR IS RESPONSIBLE FOR CHECKING AND VERIFYING ALL LEVELS AND DIMENSIONS AND SHALL REPORT ANY DISCREPANCIES TO THE LANDSCAPE ARCHITECT OR OBTAIN CLARIFICATION PRIOR TO COMMENCING WORK.
ALL MATERIALS AND WORKMANSHIP SHALL COMPLY WITH THE REQUIREMENT OF THE ONTARIO BUILDING CODE LATEST EDITION AND ALL OTHER ACTS ADMINISTERED BY ALL AUTHORITIES HAVING JURISDICTION. THESE DRAWINGS TO BE READ IN CONJUNCTION WITH ALL OTHER CONTRACT DOCUMENTS AND SPECIFICATIONS. ALL DIMENSIONS GIVEN IN MILLIMETRES UNLESS OTHERWISE STATED.

L0

MIN. 1.5M WIDTH/1.5M HEIGHT PLANTED BUFFER ALONG PROPERTY LINE AS TREE/SHRUB MATRIX (SPECIES + QTY TBD)

PROP. 3M HIGH WOOD PRIVACY FENCE STARTS FENCE DESIGN + PLACEMENT OF PIP CON. FTGS (TYP.) TBD

2.4M MAX HEIGHT HEDGE AS SHOWN IN KEY PLANTED 28" O.C. QTY TBD

FREE STANDING ENTRY ELEMENT TO COURTYARD W/ PIP CONC. FTGS (TYP)

1 X SPECIMEN DECIDUOUS TREE (SPECIES TBD)

PLANTING (BY HOTEL) ON ADJ. PROPERTY IN COLLABORATION W/ ADJ. PROP. OWNER

2 x QUERCUS ROBUR 'FASTIGIATA' OR 'CRIMSON SPIRE'

MED. HEIGHT DEC. HEDGE SPIRAEA X VANHOUTTEI QTY TBD

3M HEIGHT WOOD SCREEN (DESIGN TBD) SURROUNDS TRANSFORMER + GENERATOR HOTEL SIGNAGE (DESIGN BY OTHERS) FASTENED ON THREE SIDES FOR PUBLIC VISIBILITY GENERATOR + TRANSFORMER INSTALLED ON CONCRETE SLAB (REFER TO CIVIL)

NEW CURB CUT FOR FIRE ROUTE

LOWER EVERGREEN HEDGE TAXUS X MEDIA 'HICKSII' ON EITHER SIDE OF ENTRANCE WALKWAY + SURROUNDING SOUTH COURTYARD QTY TBD

FEATURE ELEMENT WITH GAS FLAME (U/G GAS LINE BY OTHERS)

THUJA OCCIDENTALIS QTY AS SHOWN WITH CORNUS SERICEA QTY TBD

1 X SPECIMEN DECIDUOUS TREE (SPECIES TBD) W/ LOW SHRUB UNDERSTORY

H.P. (TO BE RELOCATED BY OTHERS)

NEW CONC. CURB (SEE CIVIL DWGS.)

1 X SALIX ALBA 'TRISTIS'

NEW CONC. CURB (SEE CIVIL DWGS.)

H.P. (TO BE RELOCATED BY OTHERS)

3 X ELECTRIC VEHICAL CHARGING STATIONS

4 X SPECIMEN DECIDUOUS TREE (SPECIES TBD) 40MM CALIPER

PROP. WOOD PRIVACY FENCE FASTENED TO CONC. RET. WALL (SEE CIVIL DWGS). DESIGN (TBD) MATCHES ALL PERIMETER WOOD FENCING MAX. HEIGHT TO CONFORM TO LOCAL BYLAW

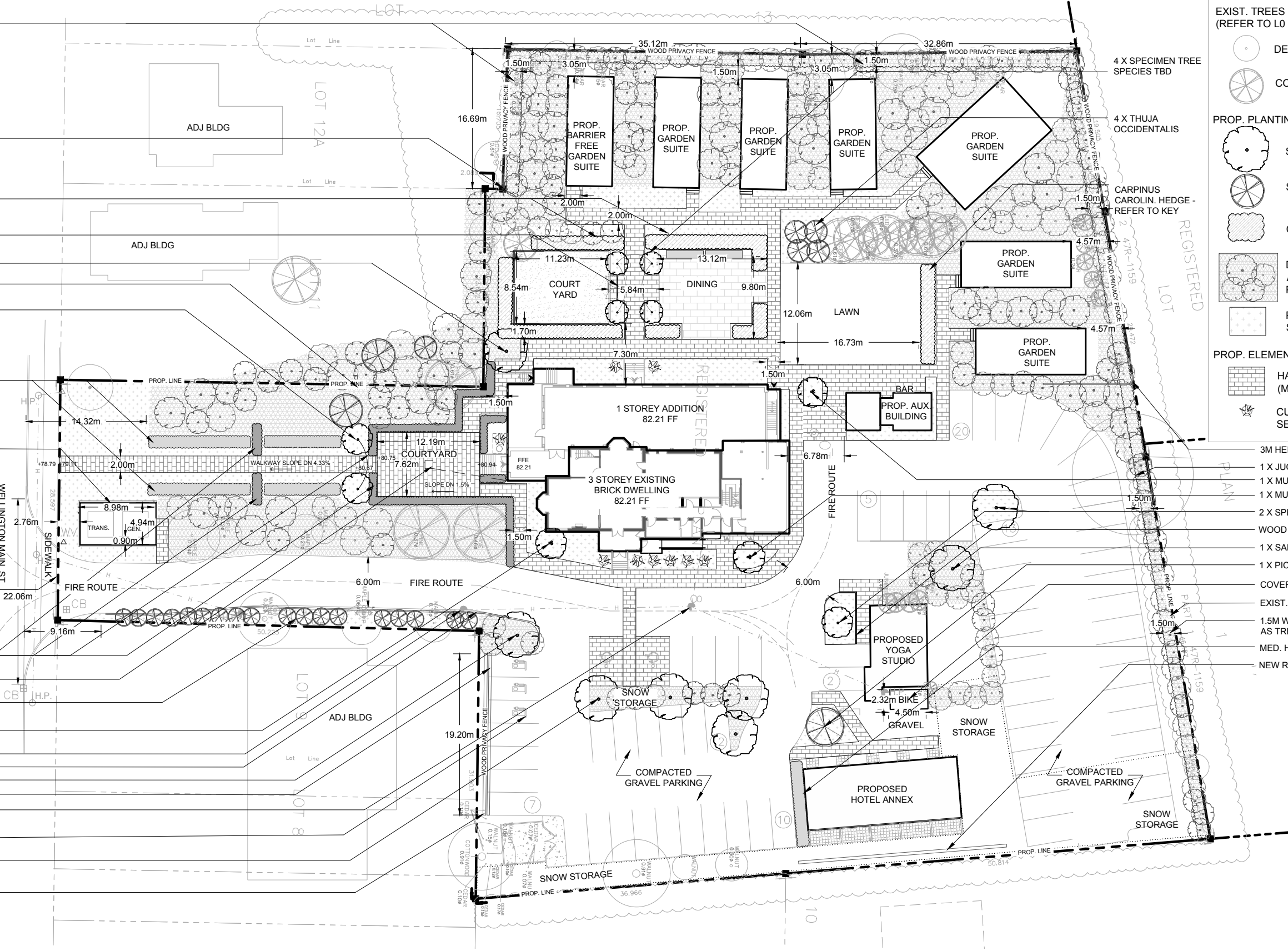

KEY:

EXIST. TREES
(REFER TO L0 FOR TREE PROTECTION ZONES, SPECIES + LOCATION)

- DECIDUOUS TREE
- CONIFEROUS TREE

PROP. PLANTING

- SPECIMEN DECIDUOUS TREE
- SPECIMEN CONIFEROUS TREE
- CARPINUS CAROLIN. HEDGE - REFER TO KEY
- CARPINUS CAROLIN. MAX 2.4M HEIGHT HEDGE
- DECIDUOUS TREE/SHRUB MATRIX SPECIES + QTY TBD AS PER SUN/SHADE + SOIL CONDITIONS. DETAILED PLANTING PLAN TBD
- PERENNIALS/GRASSES/GROUND COVER MATRIX. SPECIES + QTY TBD. DETAILED PLANTING PLAN TBD

PROP. ELEMENTS

- HARDSCAPE WALKWAYS ON GRAVEL BASE (MATERIALS TBD)
- CUSTOM STEEL RAISED PLANTERS FOR SEASONAL PLANTING

- 3M HEIGHT WOOD PRIVACY FENCE ENDS. DESIGN TBD
- 1 X JUGLANS NIGRA (EXIST.) TO BE PROTECTED AS PER L0
- 1 X MULTI-STEM TREE (SPECIES TBD)
- 1 X MULTI-STEM TREE (SPECIES TBD)
- 2 X SPECIMEN DECIDUOUS TREES (SPECIES TBD)
- WOOD PRIVACY SCREEN (DESIGN TBD)
- 1 X SALIX ALBA 'TRISTIS'
- 1 X PICEA GLAUCA (250CM POT)
- COVERED BIKE STORAGE FOR 8-10 BIKES (DESIGN BY OTHERS)
- EXIST. CHAIN LINK FENCE REMAINS
- 1.5M WIDTH/1.5M HEIGHT PLANTED BUFFER ALONG PROP LINE AS TREE/SHRUB MATRIX (SPECIES + QTY TBD)
- MED. HEIGHT DEC. HEDGE. SPIRAEA X VAN HOUTTEI (QTY TBD)
- NEW RETAINING WALL (SEE CIVIL DWGS.)

VICTORIA TAYLOR LANDSCAPE ARCHITECT M.L.A. O.A.L.A.

240 STERLING ROAD TORONTO M6R 2B9
+1 416 837 0344 VICTORIATAYLOR.CA

PROJECT: THE WELLINGTON HOTEL
192 MAIN STREET, WELLINGTON, PEC

DRAWING: LANDSCAPE LAYOUT MASTER PLAN

DATE: DECEMBER 2021
SCALE: 1:500
DRAWN BY: VTLA

ISSUED RECORD:

No.	YY MM DD	Issued
1	21 11 08	FOR CLIENT RECORDS
2	21 12 02	FOR SITE PLAN APPROVAL
3		
4		
5		
6		
7		
8		

THIS DRAWING IS THE PROPERTY OF THE LANDSCAPE ARCHITECT AND MAY NOT BE REPRODUCED OR USED WITHOUT THE PERMISSION OF THE LANDSCAPE ARCHITECT. THE CONTRACTOR IS RESPONSIBLE FOR CHECKING AND VERIFYING ALL LEVELS AND DIMENSIONS AND SHALL REPORT ANY DISCREPANCIES TO THE LANDSCAPE ARCHITECT OR OBTAIN CLARIFICATION PRIOR TO COMMENCING WORK.

ALL MATERIALS AND WORKMANSHIP SHALL COMPLY WITH THE REQUIREMENT OF THE ONTARIO BUILDING CODE LATEST EDITION AND ALL OTHER ACTS ADMINISTERED BY ALL AUTHORITIES HAVING JURISDICTION. THESE DRAWINGS TO BE READ IN CONJUNCTION WITH ALL OTHER CONTRACT DOCUMENTS AND SPECIFICATIONS. ALL DIMENSIONS GIVEN IN MILLIMETRES UNLESS OTHERWISE STATED.

L1