

1 Site Plan
A021

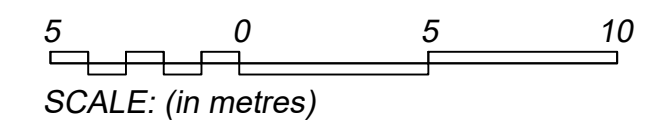

03	Re-issued for SPC	26-07-2022
02	Re-issued for SPC	25-05-2022
1	Issued for SPC	7-01-2022
Revision	Description	Date

Project
Wentworth Offices & Warehouse

Location
38 McDonald Drive
Picton, ON.

Client
Wentworth Landscapes Group

Drawing
Site Plan

Drawn by jmh/HLG	Date July 26, 2022
File Name 21121-A021	Scale 1:200
Client Project #	Drawing Number
Project # 21-	Revision # A021

KEYPLAN

REVISIONS

NO.	ISSUED FOR	DATE
00	SITE PLAN APPROVAL	22.06.15

NORTH

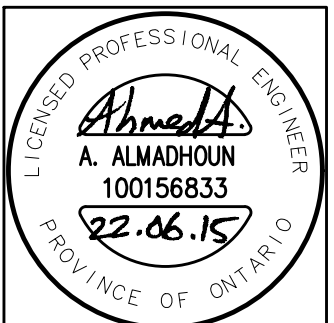
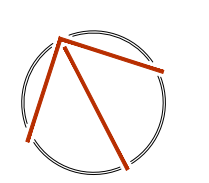

DESIGN	AT	DRAWN	AT
CHECKED	AMA	REVIEWED	AMA

PROJECT

WENTWORTH WAREHOUSE

ADDRESS

MCDONALD DRIVE,
PRINCE EDWARD, ON K0K 2T0

PROJECT NO.

CE-5384

DRAWING TITLE

SITE PLAN LIGHTING
&
PHOTOMETRICS

DRAWING NUMBER

E0 OF 1

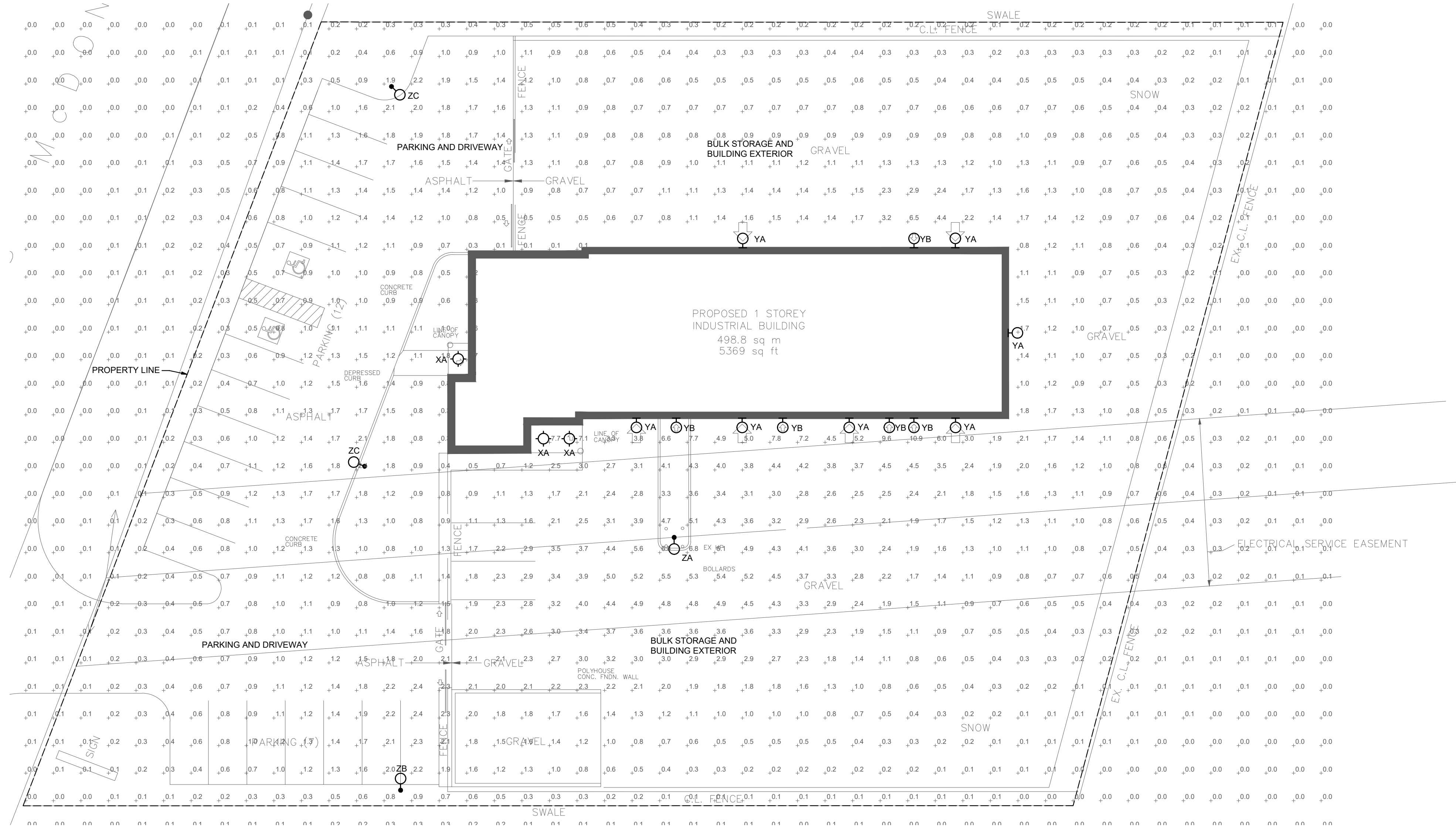

SITE PLAN LIGHTING & PHOTOMETRIC LAYOUT

SCALE: 1:200

GENERAL NOTES:

- COORDINATE BUILDING MOUNTED FIXTURE LOCATIONS WITH ARCHITECTURAL ELEVATIONS.

PHOTOMETRIC ILLUMINANCE METHOD

	Lang (ft)	Lmax (ft)	Lmin (ft)	Lmax/Lmin (ft)	Lang/Lmin (ft)
PARKING AND DRIVEWAY	1.2	2.4	0.2	12	6.0
BULK STORAGE AND BUILDING EXTERIOR	1.9	6.8	0.4	17	4.8
SOUTH ENTRANCE CANOPY	7.4	7.7	7.1	1.1	1.0
WEST ENTRANCE CANOPY	4.7	4.7	4.7	1.0	1.0

LIGHTING FIXTURE SCHEDULE

FIXTURE TAG	DESCRIPTION AND MODEL SERIES	INPUT	LIGHT SOURCE	MOUNTING
ZC	LED POLE MOUNTED PARKING LOT DARK SKY COMPLIANCE FIXTURE. FIXTURE TO BE CONTROLLED BY TIME CLOCK, PHOTOCELL AND OCCUPANCY SENSOR. LITHONIA LIGHTING: DSX2 LED OR APPROVED EQUAL	120V 140W	LED 18,964L 4000K 70 CRI TYPE 3	EXISTING POLE MOUNTED AT 6.0 METERS A.F.G.
ZB	LED POLE MOUNTED PARKING LOT DARK SKY COMPLIANCE FIXTURE CW HOUSE SIDE SHEILD. FIXTURE TO BE CONTROLLED BY TIME CLOCK, PHOTOCELL AND OCCUPANCY SENSOR. LITHONIA LIGHTING: DSX1 LED OR APPROVED EQUAL	120V 54W	LED 6984L 4000K 70 CRI TYPE 2	MOUNTED AT 6.0 METERS A.F.G.
ZC	LED POLE MOUNTED PARKING LOT DARK SKY COMPLIANCE FIXTURE CW HOUSE SIDE SHEILD. FIXTURE TO BE CONTROLLED BY TIME CLOCK, PHOTOCELL AND OCCUPANCY SENSOR. LITHONIA LIGHTING: DSX1 LED OR APPROVED EQUAL	120V 54W	LED 6967L 4000K 70 CRI TYPE 3	MOUNTED AT 6.0 METERS A.F.G.
YA	LED WALL PACK WITH DARK SKY COMPLIANCE. FIXTURE TO BE CONTROLLED BY TIMECLOCK AND PHOTOCELL. LITHONIA LIGHTING: DSXW1 LED 10C OR APPROVED EQUAL	120-277V 39W	LED 3873L 4000K 70 CRI TYPE 3	WALL MOUNTED AT 5.35 METERS A.F.G.
YB	LED WALL SCONCE WITH DARK SKY COMPLIANCE. FIXTURE TO BE CONTROLLED BY TIMECLOCK AND PHOTOCELL. LITHONIA LIGHTING: WDG1 LED OR APPROVED EQUAL	120-277V 4W	LED 1200L 4000K 80 CRI TYPE 4	WALL MOUNTED AT 2.32 METERS A.F.G.
XA	LED SQUARE CANOPY FIXTURE. FIXTURE TO BE CONTROLLED BY TIMECLOCK AND PHOTOCELL CW WET LOCATION CERTIFIED. LITHONIA LIGHTING: WF4 OR APPROVED EQUAL	120-277V 10.2W	LED 480L 4000K 80 CRI	RECESSED

- NOTES:**
- PROVIDE ALL NECESSARY MOUNTING HARDWARE FOR A COMPLETE INSTALLATION.
 - COORDINATE WITH ARCHITECTURAL CEILING PLAN TO CONFIRM CEILING MATERIAL AND MOUNTING TYPE.

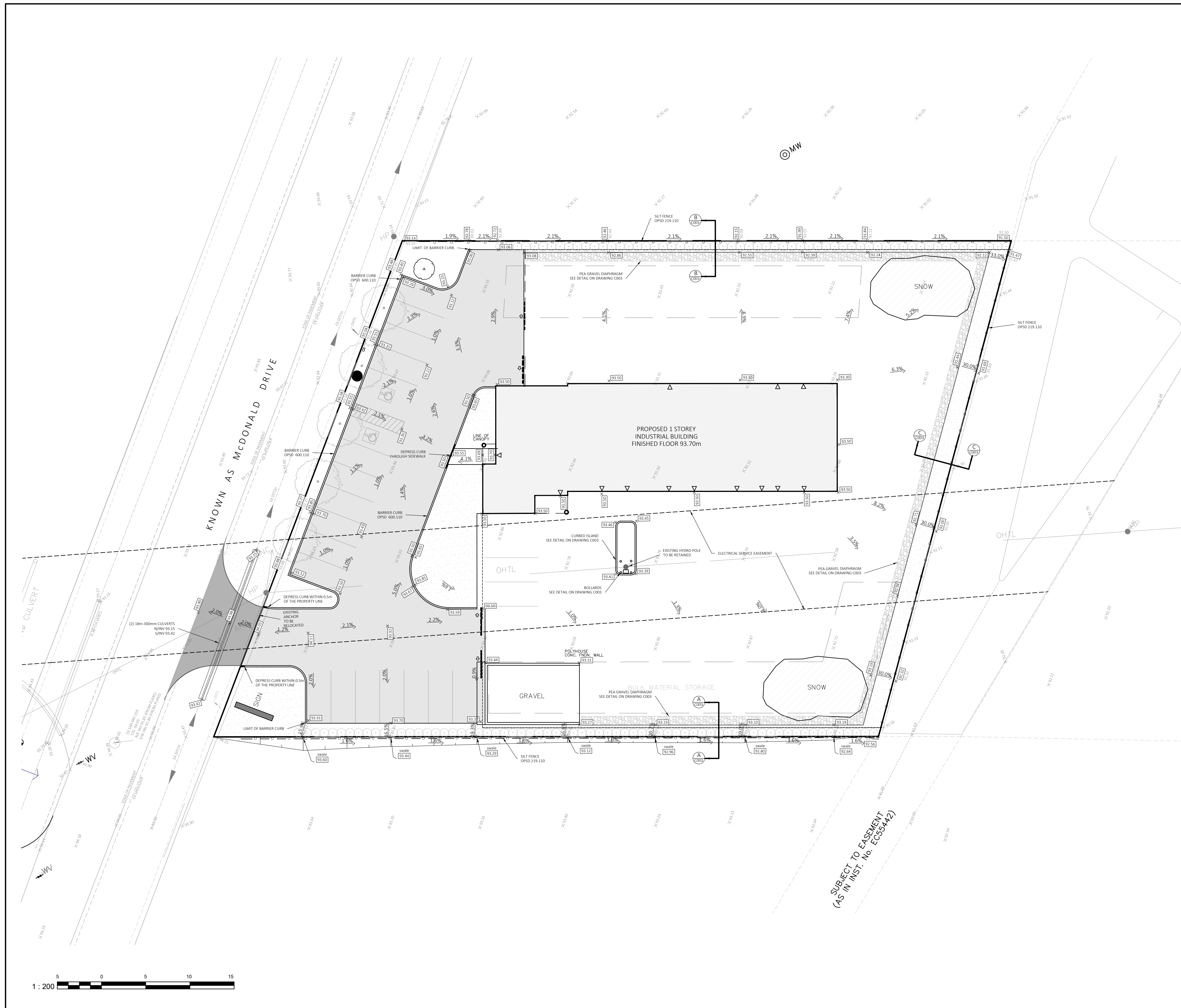

LEGEND	EXISTING	PROPOSED
NOT IN CONTRACT	N.I.C.	N.I.C.
SHOULDER	---	---
PAVEMENT	---	---
CONCRETE CURB TYPE	---	---
DITCH	---	---
STORM SEWER & MANHOLE WITH DIRECTION OF FLOW	---	---
SAN. SEWER & MANHOLE WITH DIRECTION OF FLOW	---	---
WATERMAIN AND VALVE CHAMBER	---	---
GAS METER LOCATION	---	---
GAS MAIN	---	---
CULVERT	---	---
BELL TELEPHONE CONDUIT	---	---
BELL CANADA PEDESTAL	---	---
OVERHEAD STREETLIGHT WIRING	---	---
HYDRO CONDUIT	---	---
HYDRO METER LOCATION	---	---
TRANSFORMER VAULT ON CONC. PAD	---	---
SWITCHGEAR	---	---
HYDRO STREET LIGHTING CONDUIT	---	---
SINGLE CATCH BASIN	---	---
DITCH INLET CATCH BASIN	---	---
TWIN INLET CATCH BASIN	---	---
CATCH BASIN MANHOLE	---	---
HYDRANT & VALVE BOX	---	---
BELL UTILITY POLE & ANCHOR	---	---
HYDRO UTILITY POLE & ANCHOR	---	---
STREET LIGHT	---	---
TREES	---	---
PROPERTY BOUNDARY	---	---
CENTRE LINE	---	---
EASEMENT	---	---
COSECO PEDESTAL	---	---
COSECO CABLE	---	---
EXISTING	EX	---
ROCK	---	---
STOP SIGN	---	---
STREET SIGN	---	---
FENCE	---	---
SILT FENCE	---	---
LOCATION OF TEST PITS	---	---
BENCH MARK LOCATION	---	---
COMMUNITY MAILBOX	---	---
THRUST BLOCK	---	---
EXISTING GRADE	---	---
PROPOSED GRADE	---	---
DRAINAGE DIRECTION	---	---
DOOR	---	---
ROOF DOWN SPOUT	---	---
HEAVY DUTY ASPHALT	---	---
LIGHT DUTY ASPHALT	---	---
T/WALL	---	---
B/WALL	---	---
		TOP OF RETAINING WALL
		BOTTOM OF RETAINING WALL

No.	By	Date	Revision	Checked

JE Josselyn Engineering Inc.

1225 GARDINERS ROAD
 SUITE 105
 KINGSTON, ONTARIO K7P 2R9
 TEL : 613-634-9278
 FAX : 613-634-9138
 E-MAIL : mjosselyn@josselyn.ca

OWNER: WENTWORTH LANDSCAPE INC.

PROJECT: LOT 38 McDONALD DRIVE

DRAWING TITLE: GRADING PLAN

Designed By: M.J.	Date: JULY 5, 2022	Project No. 1570	Drawing No. C001
Drawn By: N.B.	Scale: 1:200		
Checked By: M.J.			

SUBJECT TO EASEMENT
 (AS IN INST. No. EC53442)

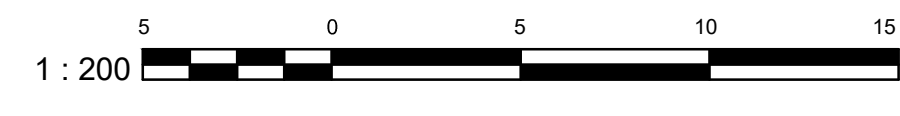

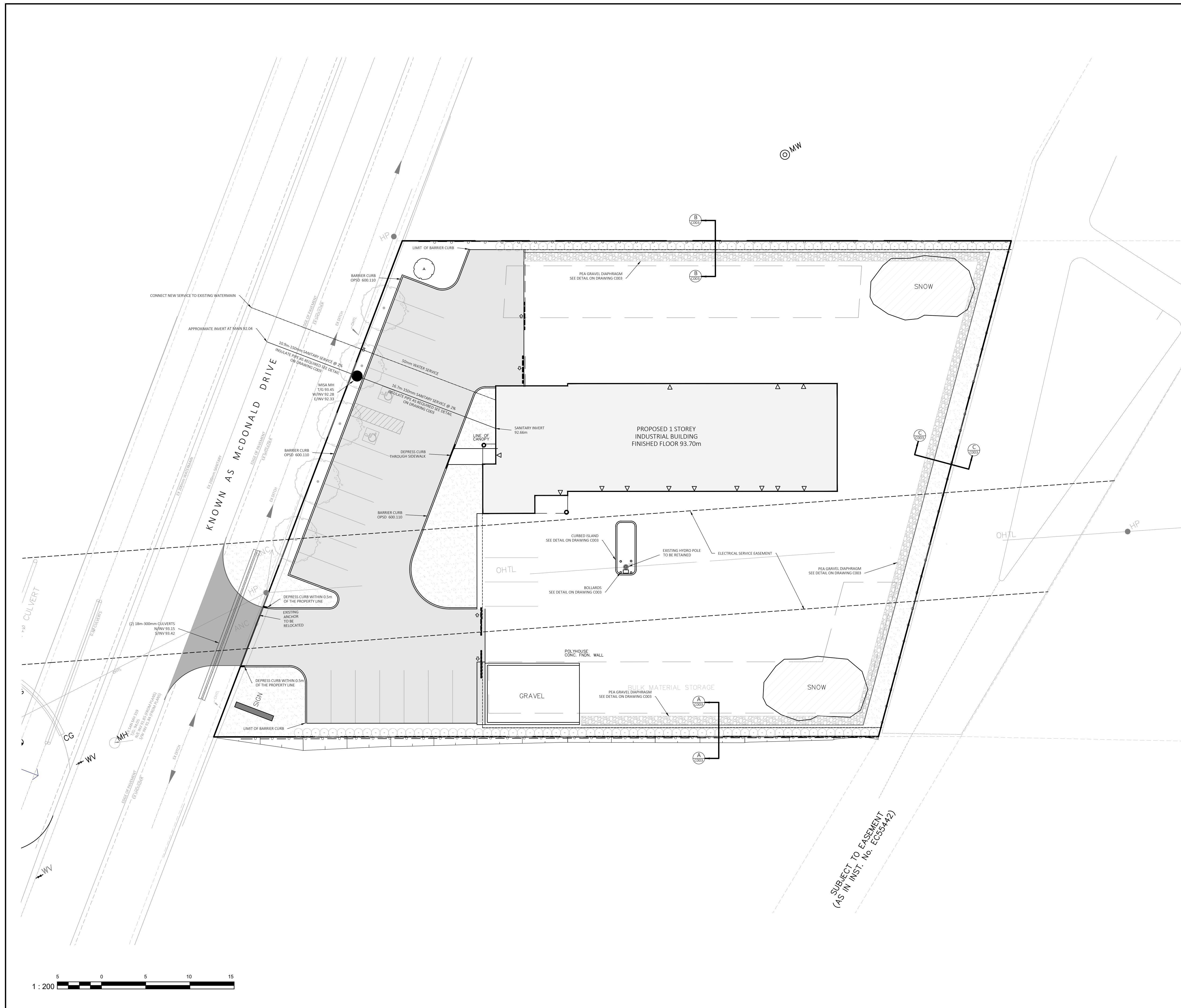

LEGEND	EXISTING	PROPOSED
NOT IN CONTRACT	N.I.C.	N.I.C.
SHOULDER	---	---
PAVEMENT	---	---
CONCRETE CURB TYPE	---	---
DITCH	---	---
STORM SEWER & MANHOLE WITH DIRECTION OF FLOW	---	---
SAN. SEWER & MANHOLE WITH DIRECTION OF FLOW	---	---
WATERMAIN AND VALVE CHAMBER	---	---
GAS METER LOCATION	---	---
GAS MAIN	---	---
CULVERT	---	---
BELL TELEPHONE CONDUIT	---	---
BELL CANADA PEDESTAL	---	---
OVERHEAD STREETLIGHT WIRING	---	---
HYDRO CONDUIT	---	---
HYDRO METER LOCATION	---	---
TRANSFORMER VAULT ON CONC. PAD	---	---
SWITCHGEAR	---	---
HYDRO STREET LIGHTING CONDUIT	---	---
SINGLE CATCH BASIN	---	---
DITCH INLET CATCH BASIN	---	---
TWIN INLET CATCH BASIN	---	---
CATCH BASIN MANHOLE	---	---
HYDRANT & VALVE BOX	---	---
BELL UTILITY POLE & ANCHOR	---	---
HYDRO UTILITY POLE & ANCHOR	---	---
STREET LIGHT	---	---
TREES	---	---
PROPERTY BOUNDARY	---	---
CENTRE LINE	---	---
EASEMENT	---	---
COSECO PEDESTAL	---	---
COSECO CABLE	---	---
EXISTING	EX	
ROCK	---	---
STOP SIGN	---	---
STREET SIGN	---	---
FENCE	---	---
SILT FENCE	---	---
LOCATION OF TEST PITS	---	---
BENCH MARK LOCATION	---	---
COMMUNITY MAILBOX	---	---
THRUST BLOCK	---	---
EXISTING GRADE	---	---
PROPOSED GRADE	---	---
DRAINAGE DIRECTION	---	---
DOOR	---	---
ROOF DOWN SPOUT	---	---
HEAVY DUTY ASPHALT	---	---
LIGHT DUTY ASPHALT	---	---
T/WALL	---	---
B/WALL	---	---
		TOP OF RETAINING WALL
		BOTTOM OF RETAINING WALL

No.	By	Date	Revision	Checked

JE Josselyn Engineering Inc.

1225 GARDINERS ROAD
 SUITE 105
 KINGSTON, ONTARIO K7P 2R9
 TEL : 613-634-9278
 FAX : 613-634-9138
 E-MAIL : mjosselyn@josselyn.ca

OWNER: WENTWORTH LANDSCAPE INC.

PROJECT: LOT 38 McDONALD DRIVE

DRAWING TITLE: SERVICING PLAN

Designed By: M.J.	Date: JULY 5, 2022	Project No. 1570	Drawing No. C002
Drawn By: N.B.	Scale: 1:200		
Checked By: M.J.			



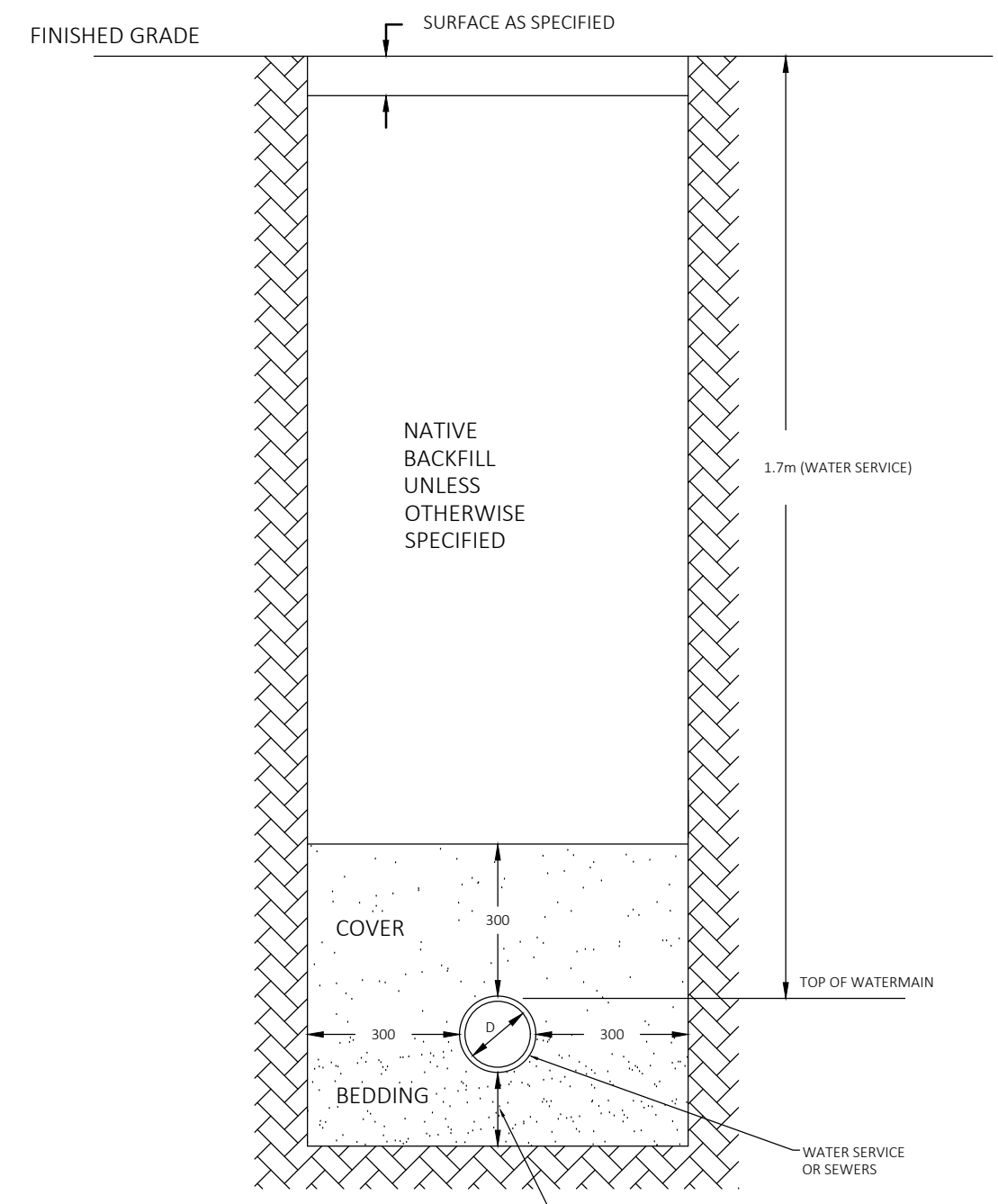

- NOTES:
1. BEDDING AND COVER TO BE GRANULAR A, COMPACTED TO 95% STANDARD PROCTOR DENSITY IN 150mm LAYERS.
 2. THE BEDDING IS TO BE CAREFULLY SHAPED TO RECEIVE THE BOTTOM OF THE PIPE.

SEWERS OR WATER SERVICE IN SINGLE TRENCH

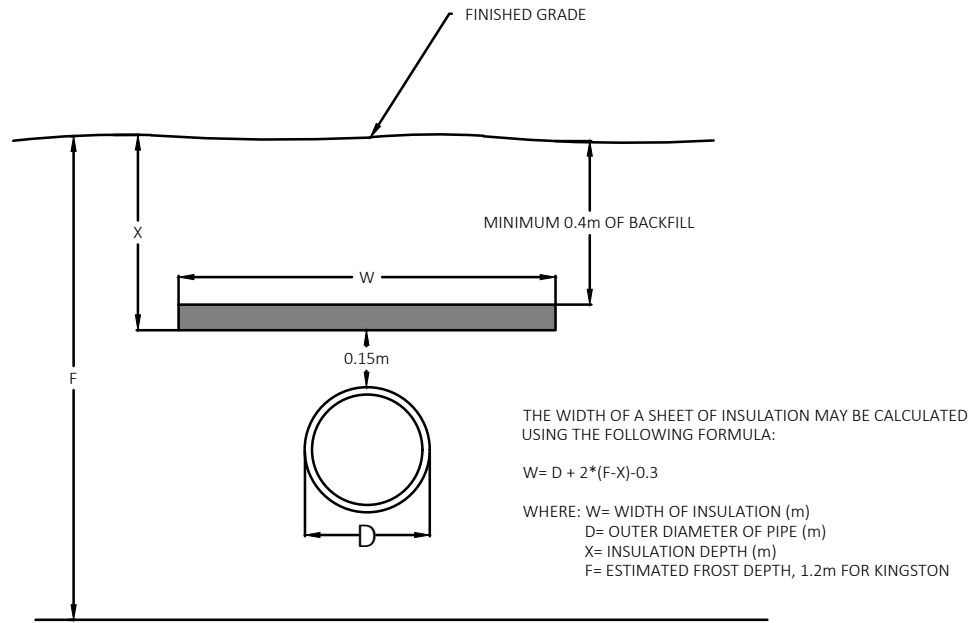

- NOTE:
1. THE INSULATION MATERIAL SHALL BE EXTRUDED POLYSTYRENE ACCORDING TO OPSD 1605 WITH A MINIMUM COMPRESSIVE STRENGTH OF 270kPa.
 2. MINIMUM INSULATION THICKNESS SHALL BE 50mm.
 3. JOINTS SHALL BE STAGGERED FOR MULTIPLE INSULATION SHEETS.

TYPICAL INSULATION DETAIL

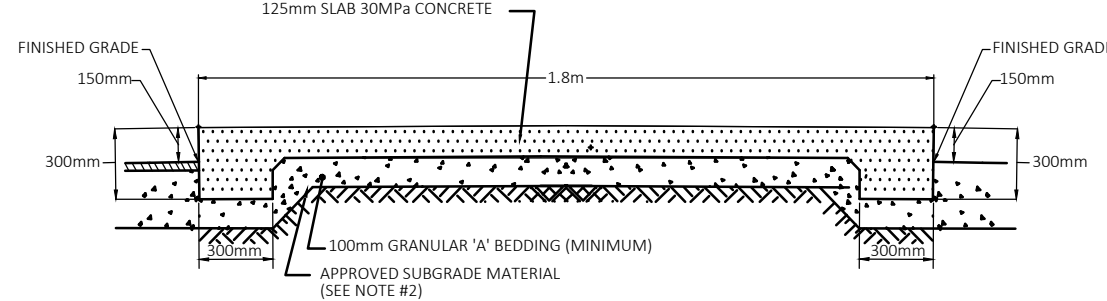

- GENERAL NOTES**
1. ALL THICKNESS DIMENSIONS ARE AFTER CONSOLIDATION TO 98% STD. PROCTOR DENSITY.
 2. SUBGRADE MATERIAL TO BE COMPACTED TO 98% STD. PROCTOR DENSITY.
 3. Concrete shall conform to the following:
 - Class of Concrete: Minimum strength: 30 MPa at 28 days
 - Coarse Aggregate: 19mm nominal maximum size
 - Air Content: 6.0% to 8.0%
 - Water: O.P.S.S. 1302
 - Aggregate - Cement - Normal Portland Type: O.P.S.S. 1303
 - Maximum Water / Cement Ratio: 0.45
 - Maximum Slump: 75mm
 - Curing Compound - White Pigmented: O.P.S.S. 1315

CONCRETE WALKWAY

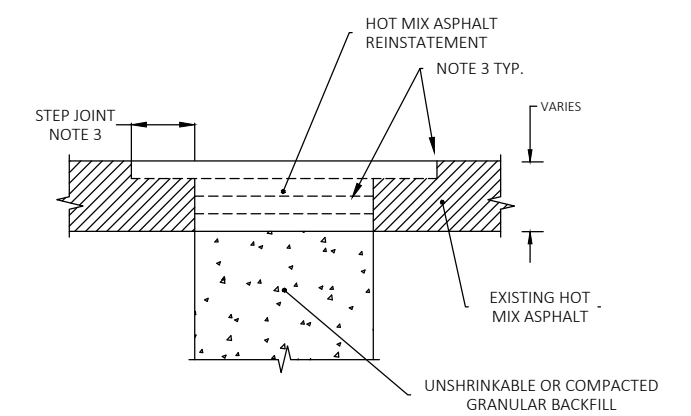

- TYPE 'A'**
1. ALL COLLECTORS AND ARTERIALS, UNLESS OTHERWISE ADVISED BY THE CITY'S ENGINEERING DEPARTMENT.
 2. LOCAL STREETS THAT HAVE BEEN RECONSTRUCTED OR OVERLAYS WITHIN THE LAST 5 YEARS.
 3. TYPE 'A' THE STEP JOINT SHALL BE 500mm MIN. WIDE AND 40mm DEEP. A STEP JOINT IS NOT REQUIRED FOR PAVEMENT DEPTHS LESS THAN 300mm.
- APPLY BERAM 3060 LM SEALANT TO THE VERTICAL SURFACES OF THE CUTS AND PROVIDE 50mm OVERLAPPING AT THE SURFACE (I.E. CRACK SEAL)
- AN INSPECTOR FROM THE CITY'S ENGINEERING DEPARTMENT MUST BE ON SITE PRIOR TO WORK.

REINSTATEMENT DETAILS

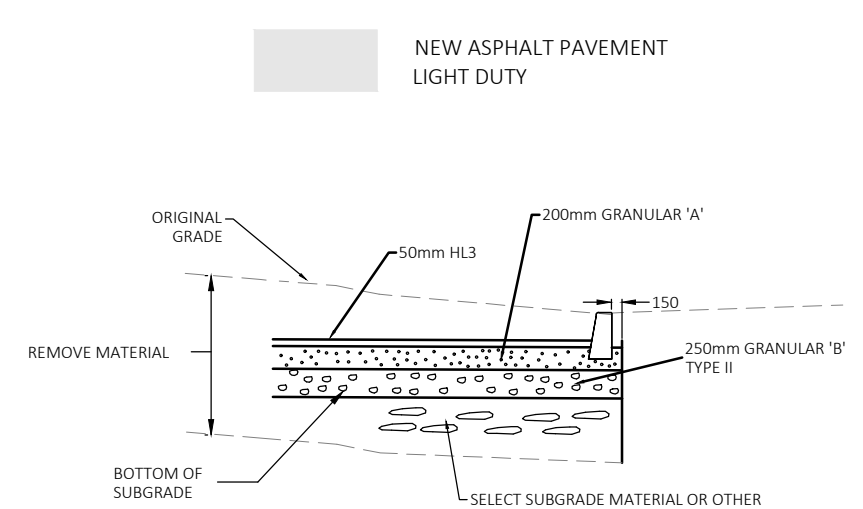

- NOTES:
- 1) COMPACT SUBGRADE TO 98% S.P.M.D.D.
 - 2) COMPACT GRANULAR SUBGRADE TO 98% S.P.M.D.D.

LIGHT DUTY PAVEMENT COMPOSITION

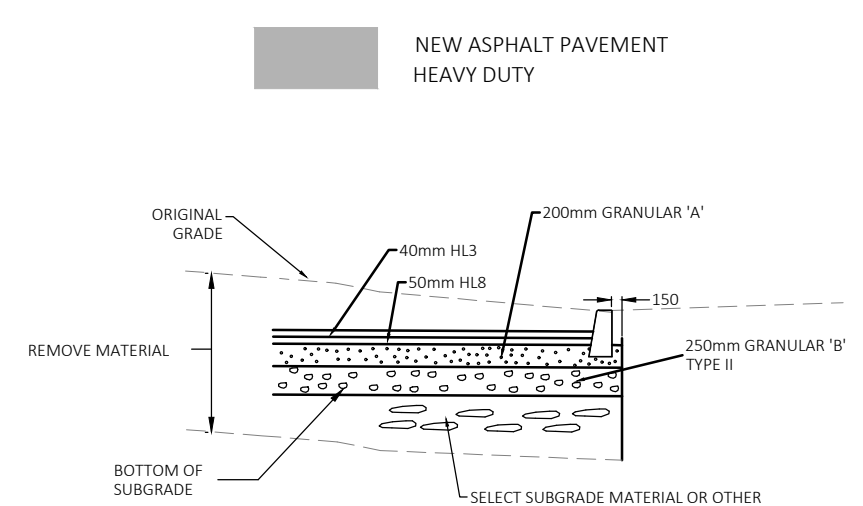

- NOTES:
- 1) COMPACT SUBGRADE TO 98% S.P.M.D.D.
 - 2) COMPACT GRANULAR SUBGRADE TO 98% S.P.M.D.D.

HEAVY DUTY PAVEMENT COMPOSITION

- NOTES:
1. THE CONTRACTOR IS TO CHECK, VERIFY AND BE RESPONSIBLE FOR ALL UNDERGROUND SERVICES, STRUCTURES AND UTILITIES. ALL EXISTING UNDERGROUND STRUCTURES, PIPES, CONDUITS, ETC TO BE EXPOSED PRIOR TO ANY CONSTRUCTION AND ANY POTENTIAL CONFLICTS TO BE REPORTED TO THE ENGINEER.
 2. FOLLOWING COMPLETION OF THE SITE WORKS, INCLUDING GRADING AND LANDSCAPING, THE SERVICING CONTRACTOR SHALL HAVE THE STORM AND SANITARY SERVICES FLOUSED, AND INSPECTED WITH CCTV CAMERA, AND A COPY OF THE CCTV INSPECTION SHALL BE PROVIDED TO THE ENGINEER FOR REVIEW. THE CONTRACTOR SHALL BE RESPONSIBLE TO CORRECT ANY DEFICIENCIES FOUND IN THE SYSTEM, AND SHALL BE RESPONSIBLE TO ENSURE THAT THE SYSTEM IS CLEAN.
 3. UNDERGROUND WORKS TO BE INSTALLED AND TESTED IN ACCORDANCE WITH THE ONTARIO PROVINCIAL STANDARD SPECIFICATIONS, ONTARIO PROVINCIAL STANDARD DRAWINGS AND THE MUNICIPAL STANDARD DRAWINGS UNLESS SPECIFIED TO THE CONTRARY ON THE PLANS. FIELD TESTING SHALL INCLUDE LOW PRESSURE AIR TESTING OF SANITARY SEWERS, DEFLECTION TESTING OF ALL PLASTIC SEWERS UP TO 325 mm, AND DEFLECTION TESTING OF SANITARY MANHOLES.
 4. A ROAD CUT PERMIT IS TO BE OBTAINED FROM THE MUNICIPALITY PRIOR TO WORK ON THE MUNICIPAL RIGHT-OF-WAY.
 5. EXISTING VEGETATION SHALL BE MAINTAINED WHEREVER POSSIBLE, AND SHALL BE PROTECTED DURING CONSTRUCTION.
 6. ALL DIMENSIONS ARE IN METRES OR MILLIMETRES UNLESS OTHERWISE SHOWN.
 7. **EROSION AND SEDIMENT CONTROL:**
 - 7.1. REGARDLESS OF SITE SPECIFIC ITEMS DETAILED ON THE PLANS, THE CONTRACTOR SHALL INSTALL EROSION CONTROL MEASURES AS SUIT THE PROPOSED WORK METHODS TO CONTROL SEDIMENT FROM RUNNING OFF OF THE SITE. FOLLOWING CONSTRUCTION, DISTURBED AREAS AS WELL AS PROPOSED GRADED AND VEGETATED SURFACES, SHALL BE REINSTATED AS SOON AS PRACTICAL.
 - 7.2. DURING CONSTRUCTION, THE EROSION CONTROL MEASURES ARE TO BE INSPECTED DAILY, AND REPAIRED AS NECESSARY TO CONTAIN ANY SEDIMENT. THIS REQUIREMENT SHALL CONTINUE UNTIL CONSTRUCTION ON THE SITE IS COMPLETE, FOLLOWING WHICH THE CONTRACTOR SHALL INSPECT THE BARRIER AS NECESSARY TO MAINTAIN ITS FUNCTION. THE OWNER SHALL REMOVE THE BARRIER ONCE THE SITE VEGETATION HAS BEEN WELL ESTABLISHED.
 8. **WATER SERVICING:**
 - 8.1. SMALL DIAMETER WATER SERVICES ARE TO BE TYPE 'C' COPPER MEETING NSF 61, OR CROSS LINKED HIGH DENSITY POLYETHYLENE MEETING NSF 14 AND 61 UNLESS OTHERWISE NOTED, AT A MINIMUM DEPTH OF 1.7 METRES. NON-CONDUCTIVE MATERIALS WILL REQUIRE TRACER WIRE. WATER SERVICES TO HAVE CORROSION PROTECTION AS FOLLOWS:
 - 8.1.1. 20mm OR 25 mm SERVICES LESS THAN 20m LONG TO HAVE A 2.3 kg ZINC ANODE
 - 8.1.2. ALL 50 mm SERVICES, OR ANY SERVICE LONGER THAN 20m LONG TO HAVE A 5.5 kg ZINC ANODE
 - 8.1.3. WATER SERVICE TO HAVE A MINIMUM DEPTH OF 1.7 METRES OF COVER.
 - 8.1.4. WATER SERVICE SHOULD CROSS ABOVE SEWERS WHEREVER POSSIBLE WHETHER THE WATER SERVICE IS ABOVE OR BELOW THE SEWER, A MINIMUM VERTICAL DISTANCE OF 500mm BETWEEN THE OUTSIDE OF THE WATER SERVICE AND THE OUTSIDE OF THE SEWER SHOULD BE PROVIDED TO ALLOW FOR PROPER BEDDING, A STRUCTURAL SUPPORT OF THE WATER SERVICE AND SEWER PIPE. SUFFICIENT STRUCTURAL SUPPORT FOR THE SEWER PIPES SHOULD BE PROVIDED TO PREVENT EXCESSIVE DEFLECTION OF THE JOINTS AND SETTLING. THE LENGTH OF WATER PIPE SHOULD BE CENTERED AT THE POINT OF CROSSING SO THAT JOINTS IN THE WATER SERVICE WILL BE EQUIDISTANT AND AS FAR FROM THE SEWER, CROSSING PERPENDICULAR IF POSSIBLE.
 9. **SANITARY SEWER:**
 - 9.1. SANITARY MAINS AND SERVICES TO BE PVC OR BS EQUAL TO CSA B142.2, CSA B142.3 OR CSA B137.3. BRANCH CONNECTIONS TO BE PRE-MANUFACTURED WYE FITTINGS (CSA CERTIFIED UNLESS OTHERWISE SPECIFIED). ALL JOINTS TO BE BELL AND SPIGOT TYPE UNLESS OTHERWISE SPECIFIED.
 - 9.2. SEWER BEDDING SHALL BE IN ACCORDANCE WITH OPSD 820 SERIES. BEDDING AND COVER SHALL CONFORM TO GRANULAR A AS PER OPSD SPECIFICATIONS.
 - 9.3. SANITARY SEWER AND SERVICES TO HAVE A MINIMUM 1.5m COVER.
 10. ALL CONCRETE CURBS TO BE BARRIER CURB OPSD-600.110 UNLESS SPECIFIED OTHERWISE. DEPRESS CURB WHERE ADJACENT TO SIDEWALK AS PER OPSD.

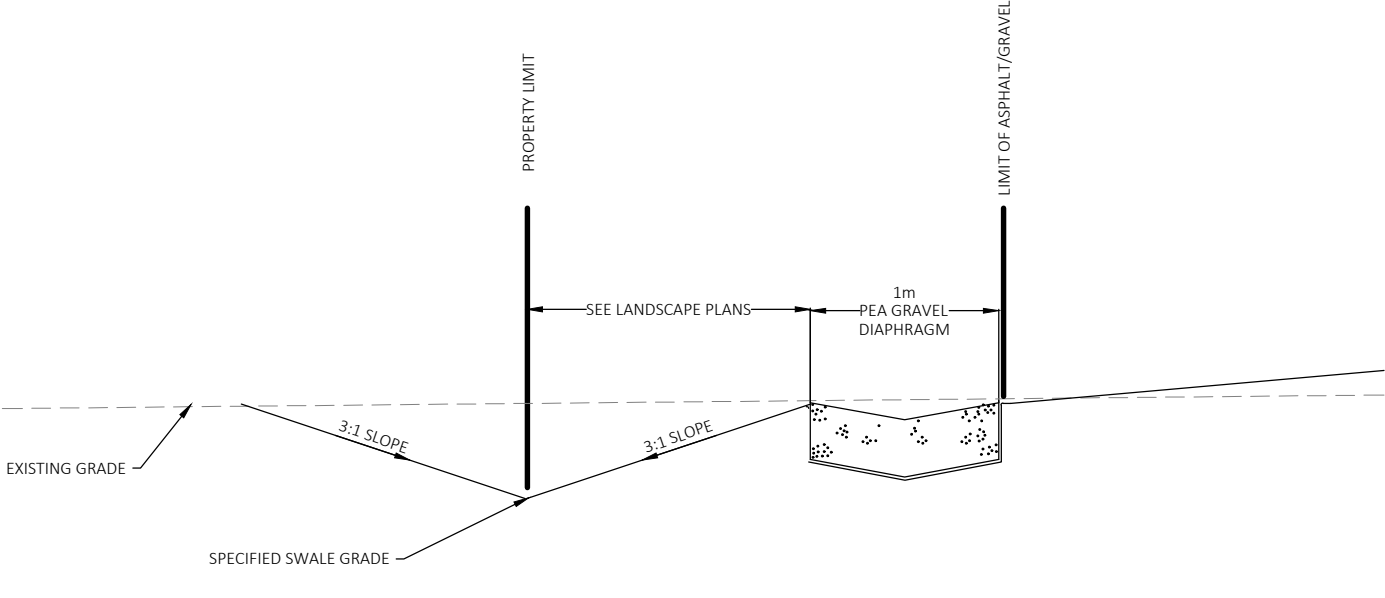

TYPICAL SECTION A-A SOUTH PROPERTY LIMIT

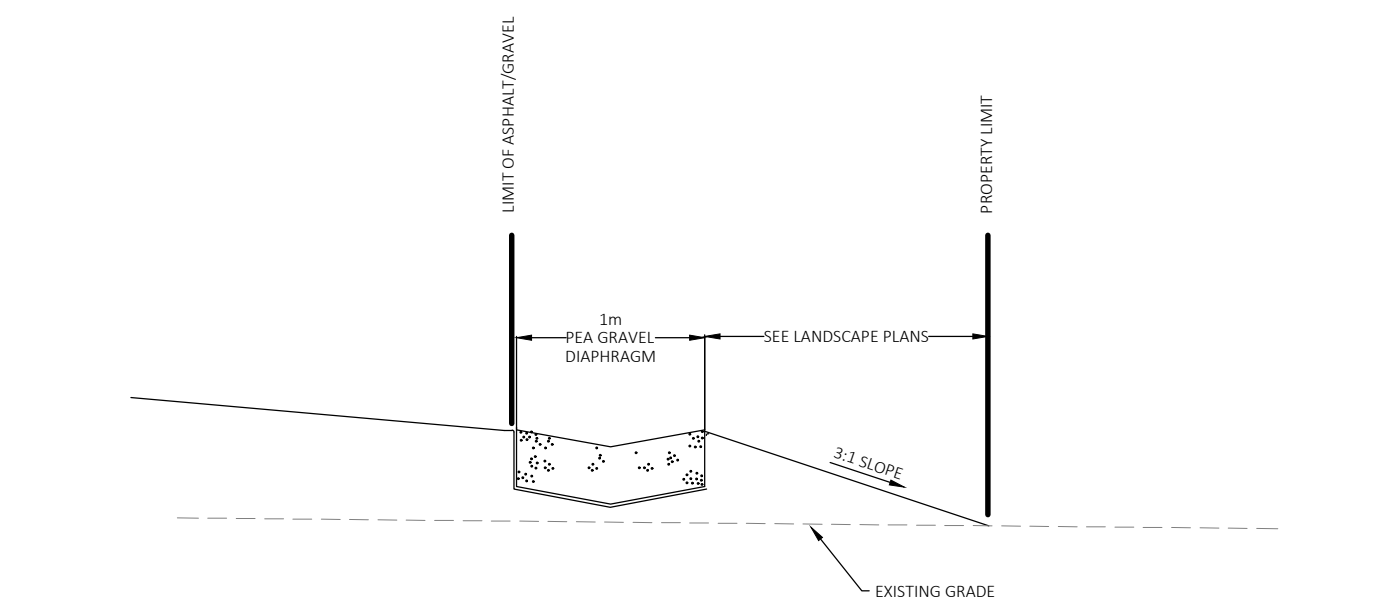

TYPICAL SECTION B-B NORTH PROPERTY LIMIT

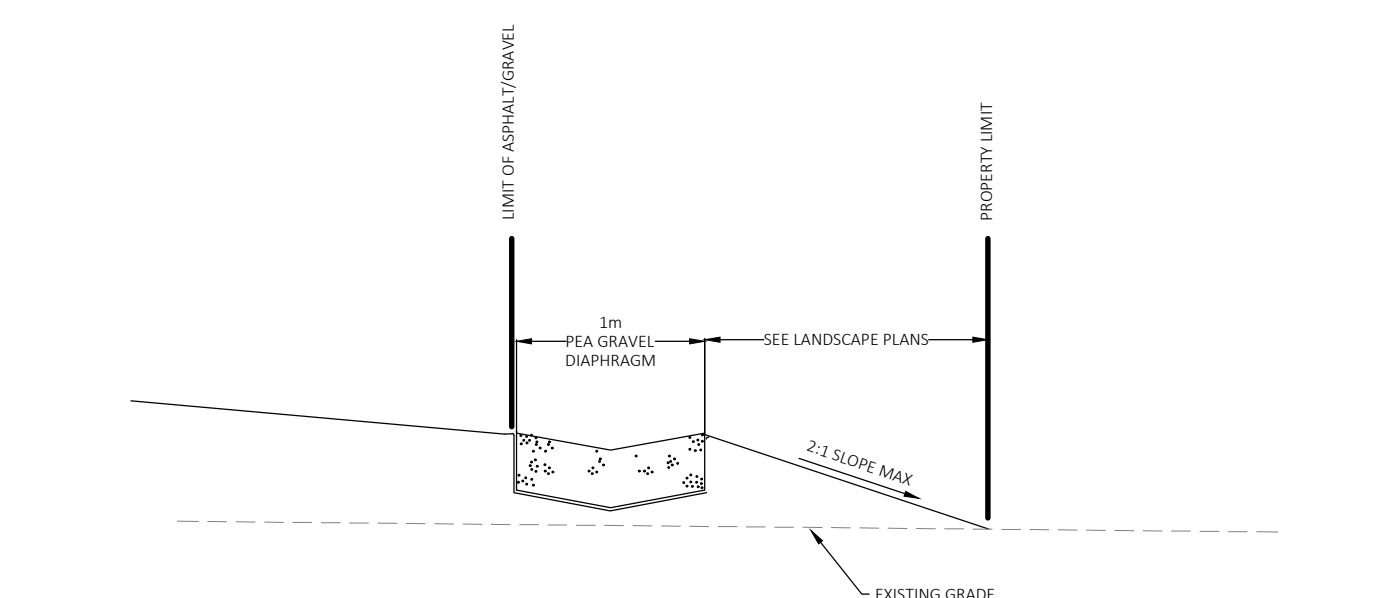

TYPICAL SECTION C-C EAST PROPERTY LIMIT

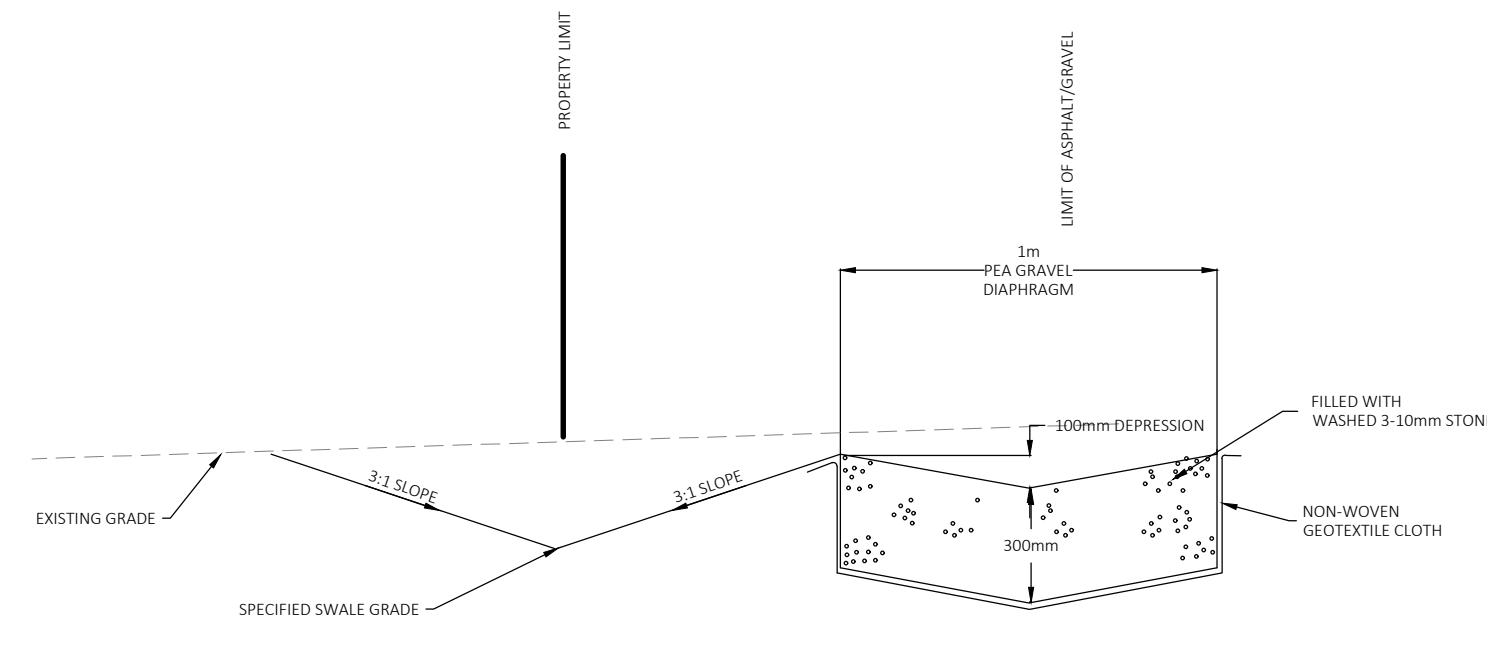

PEA GRAVEL DIAPHRAGM DETAIL

LEGEND	EXISTING	PROPOSED
NOT IN CONTRACT	N.I.C.	N.I.C.
SHOULDER		
PAVEMENT		
CONCRETE CURB TYPE		
DITCH		
STORM SEWER & MANHOLE WITH DIRECTION OF FLOW		
SAN. SEWER & MANHOLE WITH DIRECTION OF FLOW		
WATERMAN AND VALVE CHAMBER		
GAS METER LOCATION		
GAS MAIN		
CULVERT		
BELL TELEPHONE COUPLER		
BELL CANADA PEDESTAL		
OVERHEAD STREETLIGHT WIRING		
HYDRO CONDUIT		
HYDRO METER LOCATION		
TRANSFORMER VAULT ON CONC. PAD		
SWITCHGEAR		
HYDRO STREET LIGHTING CONDUIT		
SINGLE CATCH BASIN		
DITCH INLET CATCH BASIN		
TWIN INLET CATCH BASIN		
CATCH BASIN MANHOLE		
HYDRANT & VALVE BOX		
BELL UTILITY POLE & ANCHOR		
HYDRO UTILITY POLE & ANCHOR		
STREET LIGHT		
TREES		
PROPERTY BOUNDARY		
CENTRE LINE		
EASEMENT		
COSECO PEDESTAL		
COSECO CABLE		
EXISTING	EX	
ROCK		
STOP SIGN		
STREET SIGN		
FENCE		
SILT FENCE		
LOCATION OF TEST PITS		
BENCH MARK LOCATION		
COMMUNITY MAILBOX		
THRUST BLOCK		
EXISTING GRADE		
PROPOSED GRADE		
DRAINAGE DIRECTION		
DOOR		
ROOF DOWN SPOUT		
HEAVY DUTY ASPHALT		
LIGHT DUTY ASPHALT		
T/WALL		
B/WALL		
		TOP OF RETAINING WALL
		BOTTOM OF RETAINING WALL

No.	By	Date	Revision	Checked

JE Josselyn Engineering Inc.

1225 GARDINERS ROAD
SUITE 105
KINGSTON, ONTARIO K7P 2R9
TEL : 613-634-9278
FAX : 613-634-9138
E-MAIL : mjosselyn@josselyn.ca

OWNER: WENTWORTH LANDSCAPE INC.

PROJECT: LOT 38 McDONALD DRIVE

DRAWING TITLE: DETAILS

Designed By: M.J.	Date: JULY 5, 2022	Project No.	Drawing No.
Drawn By: N.B.	Scale: N.T.S	1570	C003
Checked By: M.J.			

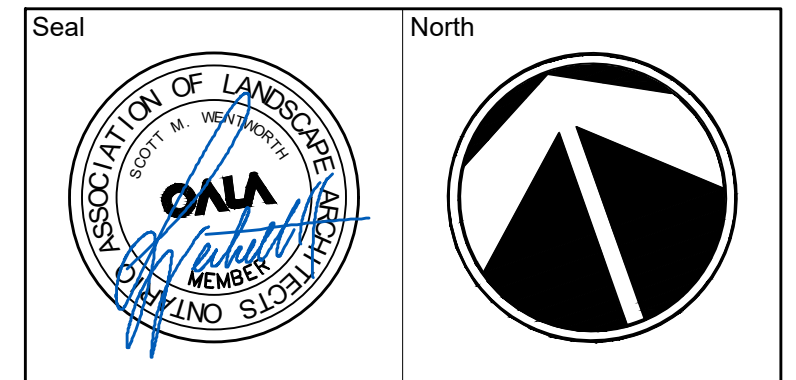

No.	Issues and Revisions	Date
1.	ISSUED FOR SITE PLAN CONTROL	2022-01-07
2.	ISSUED FOR SPC & PERMIT	2022-07-20

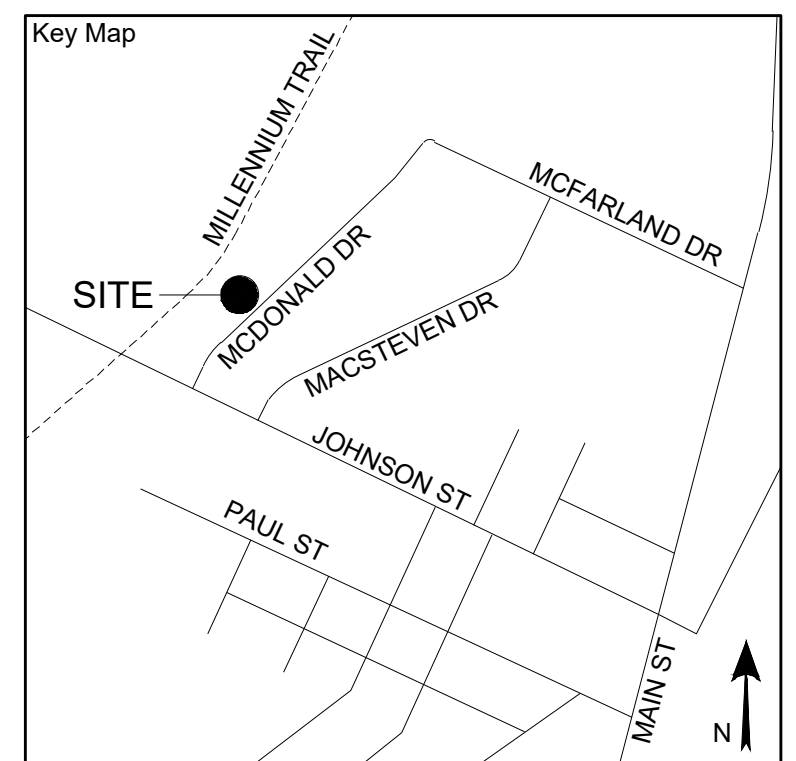

Project Notes
 This design and drawing are the property of The Scott Wentworth Landscape Group Ltd. and are not to be copied or used for construction purposes without the Landscape Architect's express written consent.
 The contractor shall check and verify all dimensions and report any discrepancies, error, or omissions to the Landscape Architect prior to commencing work.
 Survey information taken from Site Plan provided by:
 Company Name: HOPKINS CHITTY LAND SURVEYORS INC.
 Dated: 2021-11-25

Wentworth Landscapes
 13392 Loyalist Parkway R.R.1, Picton ON K0K 2T0
 613.547.3772

Consultants



Client WENTWORTH LANDSCAPES	
Project NEW OPERATIONS CENTER	
Project Location LOT 38 - MACDONALD DRIVE PICTON, ON	
Drawing Title LANDSCAPE PLAN	
Scale 1:200	
Date 2021-11-29	Plot Date 2022-07-20
Designed By SW	Drawn By DD
Approved By SW	Drawing Number
Project Number 210073-DC	L1

PLANT MATERIAL SCHEDULE						
SYMBOL	QUANTITY	BOTANICAL NAME	COMMON NAME	SIZE	CONDITION	REMARKS
Trees						
AfJ	5	Acer x freemanii	Jeffersred Maple	50cm	WB	
Po	1	Picea omorika	Serbian Spruce	150cm	WB	
Shrubs						
To	124	Thuja occidentalis	Cedar Hedge	150cm	10gal	Field Grown

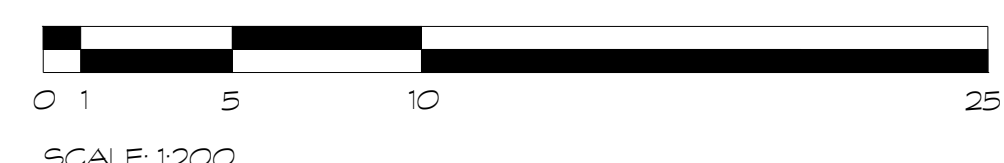
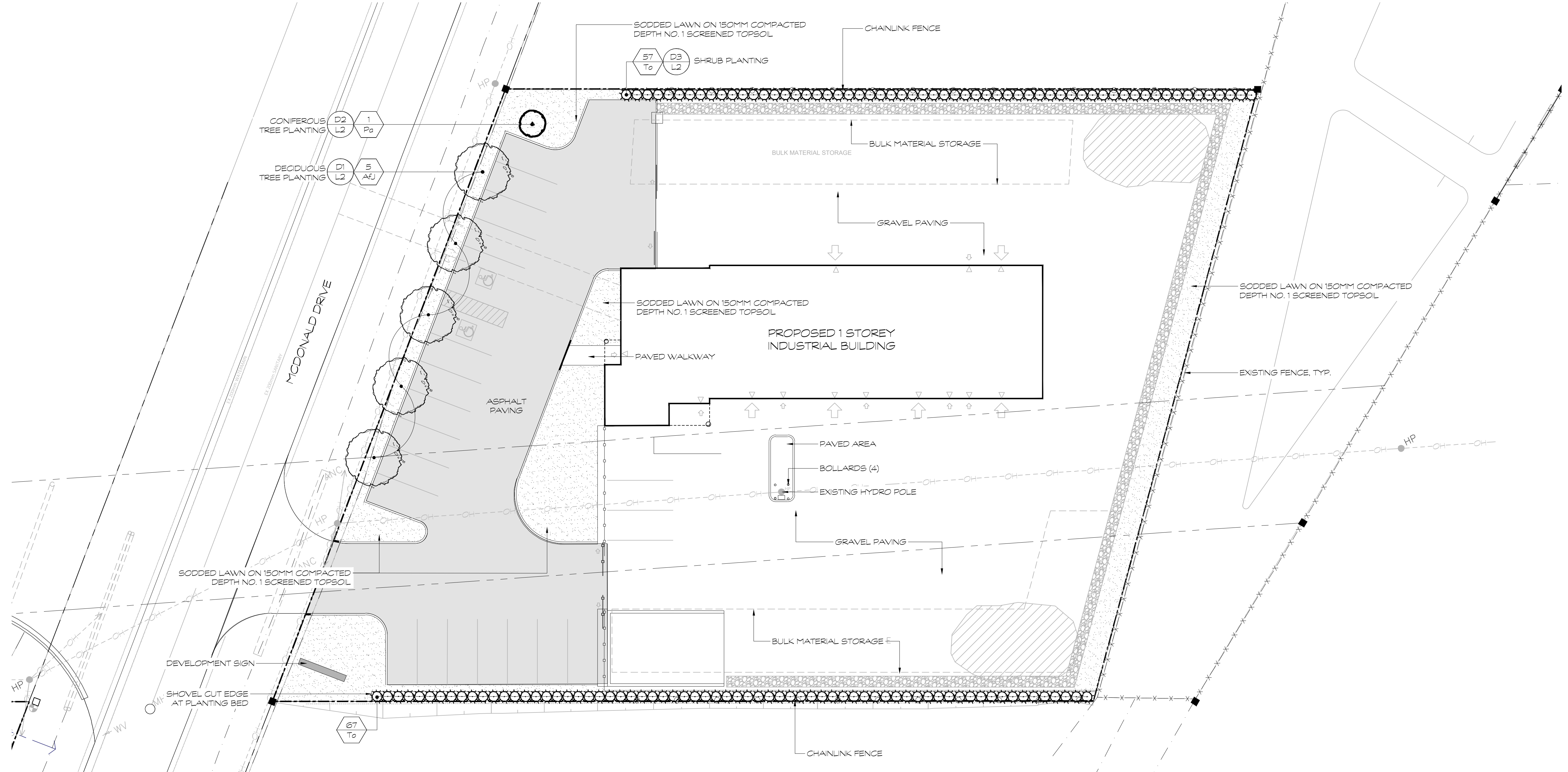

G:\Shared drives\Commercial Department\01 - PROJECTS\210073-DC - Wentworth Landscapes New Operations Center - SW\SHEET SET\210073-DC - Landscape Plan.dwg

PLANT MATERIAL QUALITY STANDARDS
ALL PLANT MATERIAL TO CONFORM TO THE LEVELS OF STANDARDS ESTABLISHED BY THE CANADIAN STANDARDS FOR NURSERY STOCK, NINTH EDITION, PUBLISHED BY THE CANADIAN NURSERY LANDSCAPE ASSOCIATION.

WATERING
ENSURE TREES ARE THOROUGHLY WATERED AT TIME OF PLANTING. CONTINUE WATERING AS REQUIRED TO PROVIDE ADEQUATE MOISTURE FOR THE DURATION OF THE SPECIFIED MAINTENANCE PERIOD.

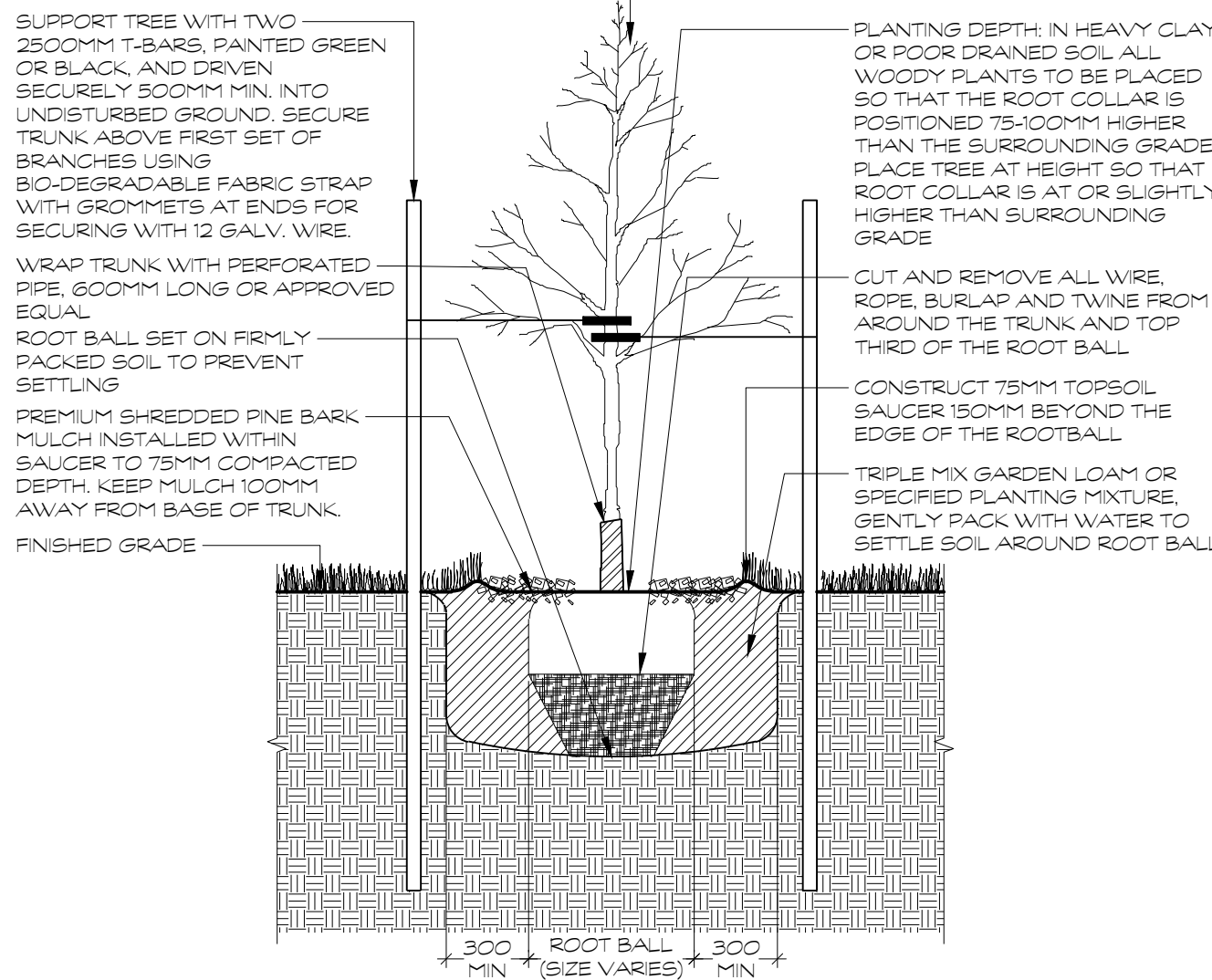
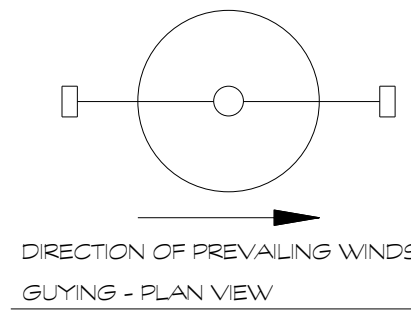

D1 DECIDUOUS TREE PLANTING
1:25

PLANT MATERIAL QUALITY STANDARDS
ALL PLANT MATERIAL TO CONFORM TO THE LEVELS OF STANDARDS ESTABLISHED BY THE CANADIAN STANDARDS FOR NURSERY STOCK, EIGHTH EDITION, PUBLISHED BY THE CANADIAN NURSERY LANDSCAPE ASSOCIATION.

WATERING
ENSURE TREES ARE THOROUGHLY WATERED AT TIME OF PLANTING. CONTINUE WATERING AS REQUIRED TO PROVIDE ADEQUATE MOISTURE FOR THE DURATION OF THE SPECIFIED MAINTENANCE PERIOD.

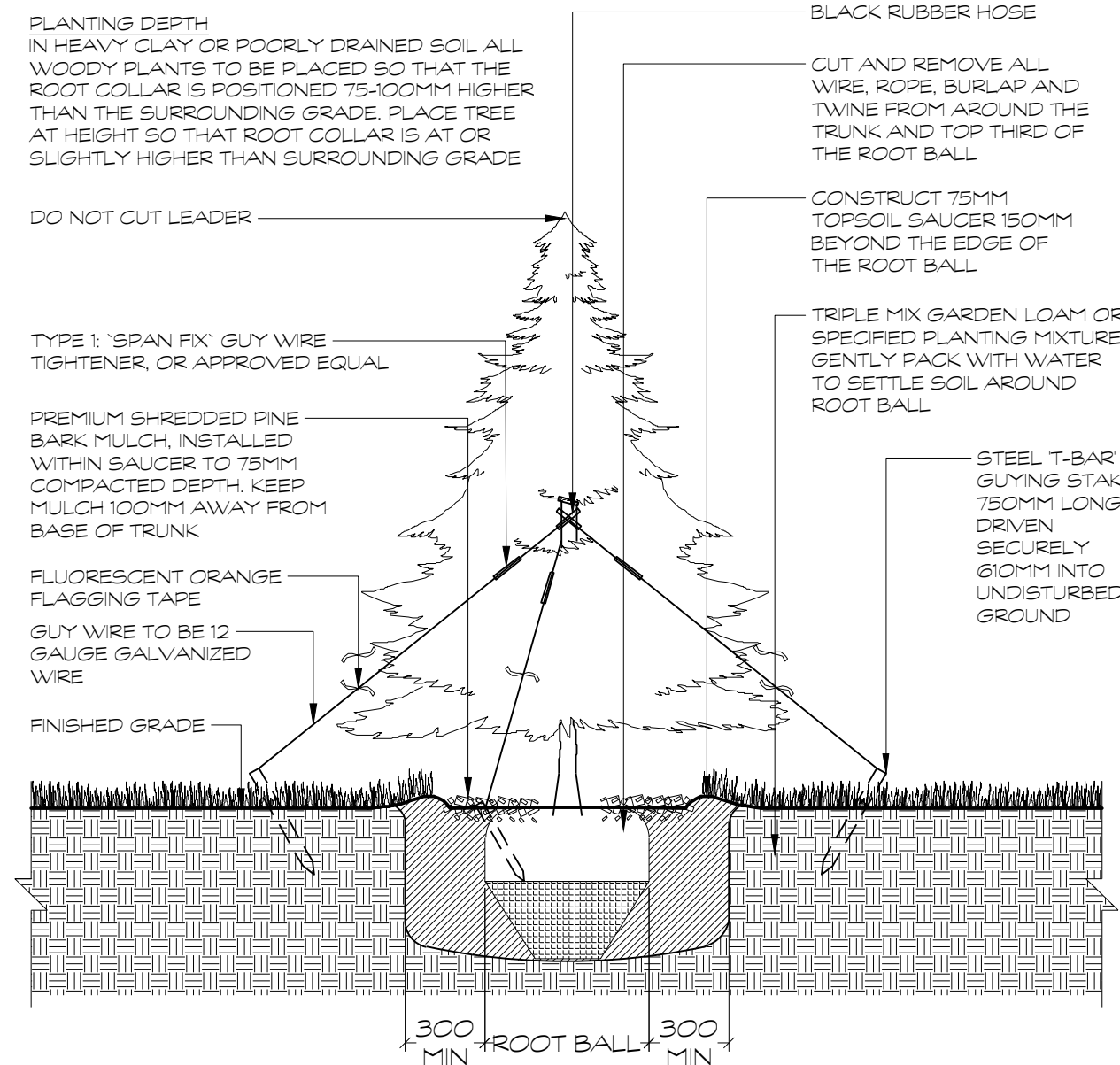

D2 CONIFEROUS TREE PLANTING
1:25

NOTES
-SHRUBS AS DETAILED REPRESENTS BOTH CONIFEROUS AND DECIDUOUS SPECIES
-PLACE MULCH TO EVEN HORIZONTAL GRADE
-SHRUBS PLANTED IN GROUPS SHALL BE SET IN CONTINUOUS PLANTING BEDS, REFER TO LANDSCAPE LAYOUT PLANS
-SHRUB BEDS TO BE BACKFILLED WITH TRIPLE MIX GARDEN LOAM PLANTING MIXTURE, OR AS SPECIFIED TO A COMPACTED DEPTH OF 450MM
-FIRMLY COMPACTED BACKFILLED PLANTING MIXTURE TO ELIMINATE AIR POCKETS AND PREVENT SETTLEMENT

PLANT MATERIAL QUALITY STANDARDS
ALL PLANT MATERIAL TO CONFORM TO THE LEVELS OF STANDARDS ESTABLISHED BY THE CANADIAN STANDARDS FOR NURSERY STOCK, NINTH EDITION, PUBLISHED BY THE CANADIAN NURSERY LANDSCAPE ASSOCIATION.

WATERING
ENSURE SHRUBS ARE THOROUGHLY WATERED AT TIME OF PLANTING. CONTINUE WATERING AS REQUIRED TO PROVIDE ADEQUATE MOISTURE FOR THE DURATION OF THE SPECIFIED MAINTENANCE PERIOD.

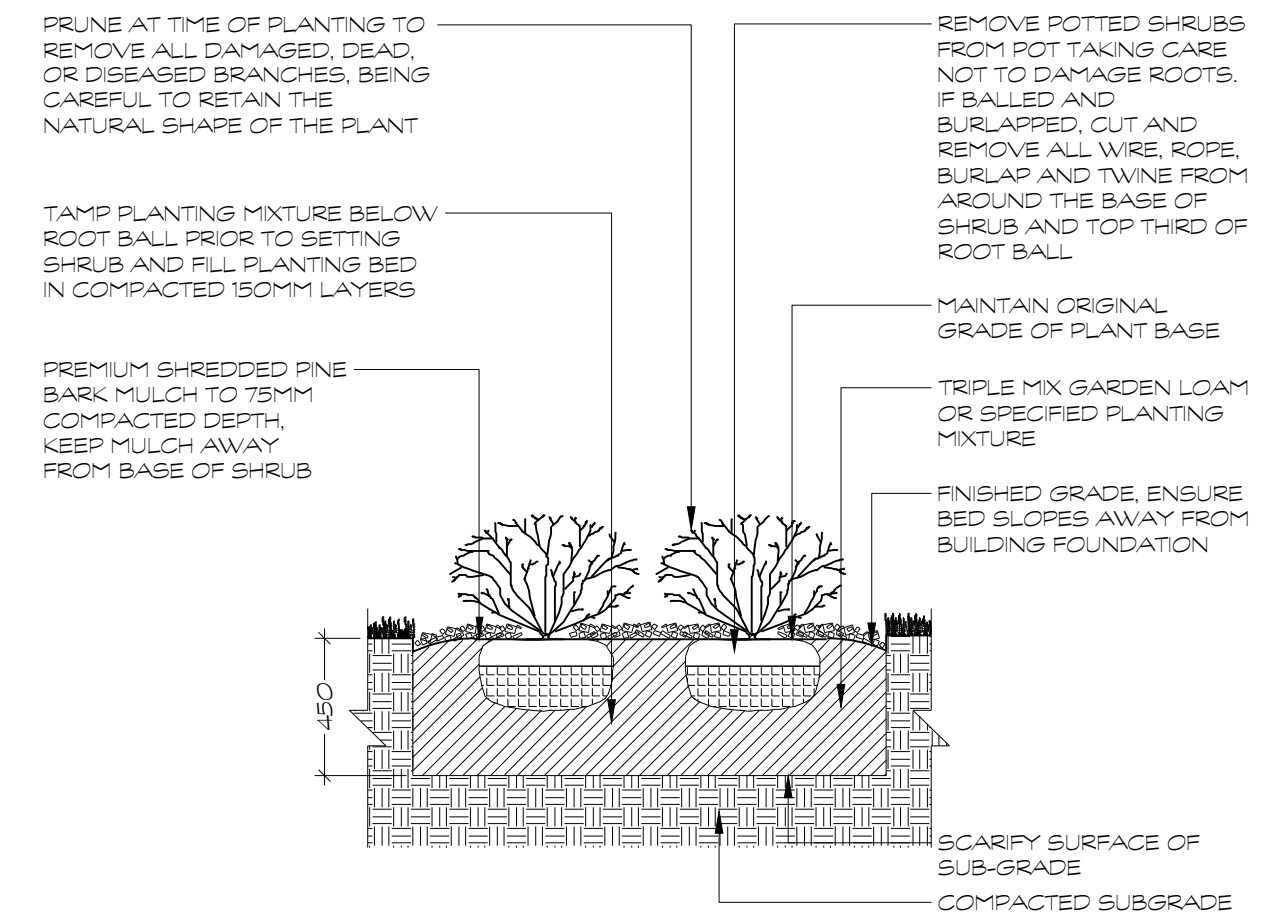

D3 SHRUB PLANTING
1:25

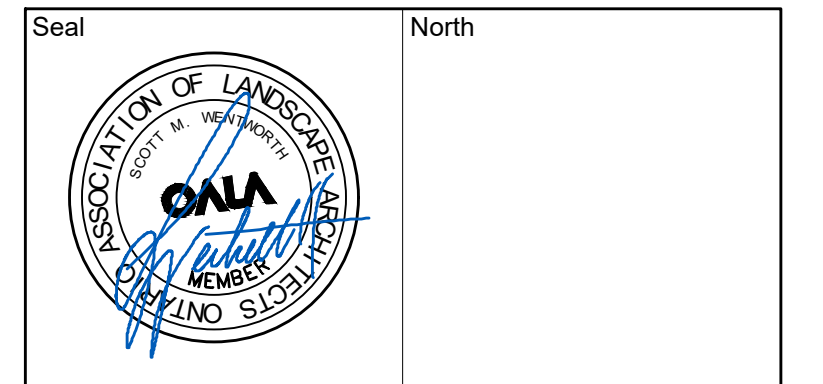

No.	Issues and Revisions	Date
1.	ISSUED FOR SITE PLAN CONTROL	2022-01-07
2.	ISSUED FOR SPC & PERMIT	2022-07-20

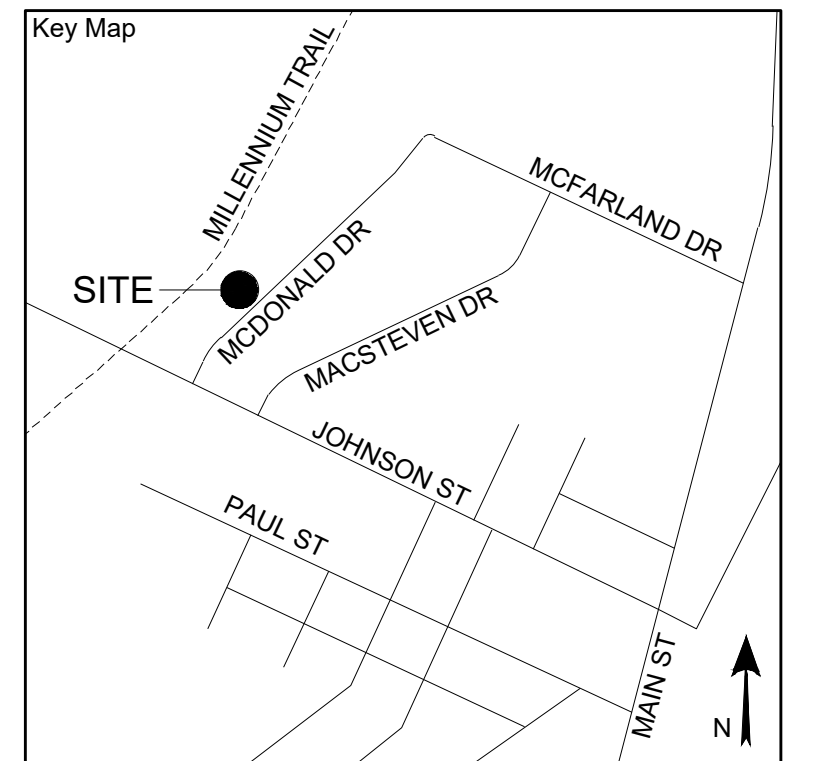

Project Notes
This design and drawing are the property of The Scott Wentworth Landscape Group Ltd. and are not to be copied or used for construction purposes without the Landscape Architect's express written consent.
The contractor shall check and verify all dimensions and report any discrepancies, error, or omissions to the Landscape Architect prior to commencing work.

Wentworth Landscapes
13392 Loyalist Parkway R.R.1, Picton ON K0K 2T0
613.547.3772

Consultants



Client WENTWORTH LANDSCAPES	
Project NEW OPERATIONS CENTER	
Project Location LOT 38 - MACDONALD DRIVE PICTON, ON	
Drawing Title SITE DETAILS	
Scale AS SHOWN	
Date 2021-11-29	Plot Date 2022-07-20
Designed By SW	Drawn By DD
Approved By SW	Drawing Number
Project Number 210073-DC	

L2