

SKETCH for SEVERANCE APPLICATION

METRIC SCALE 1 : 2500

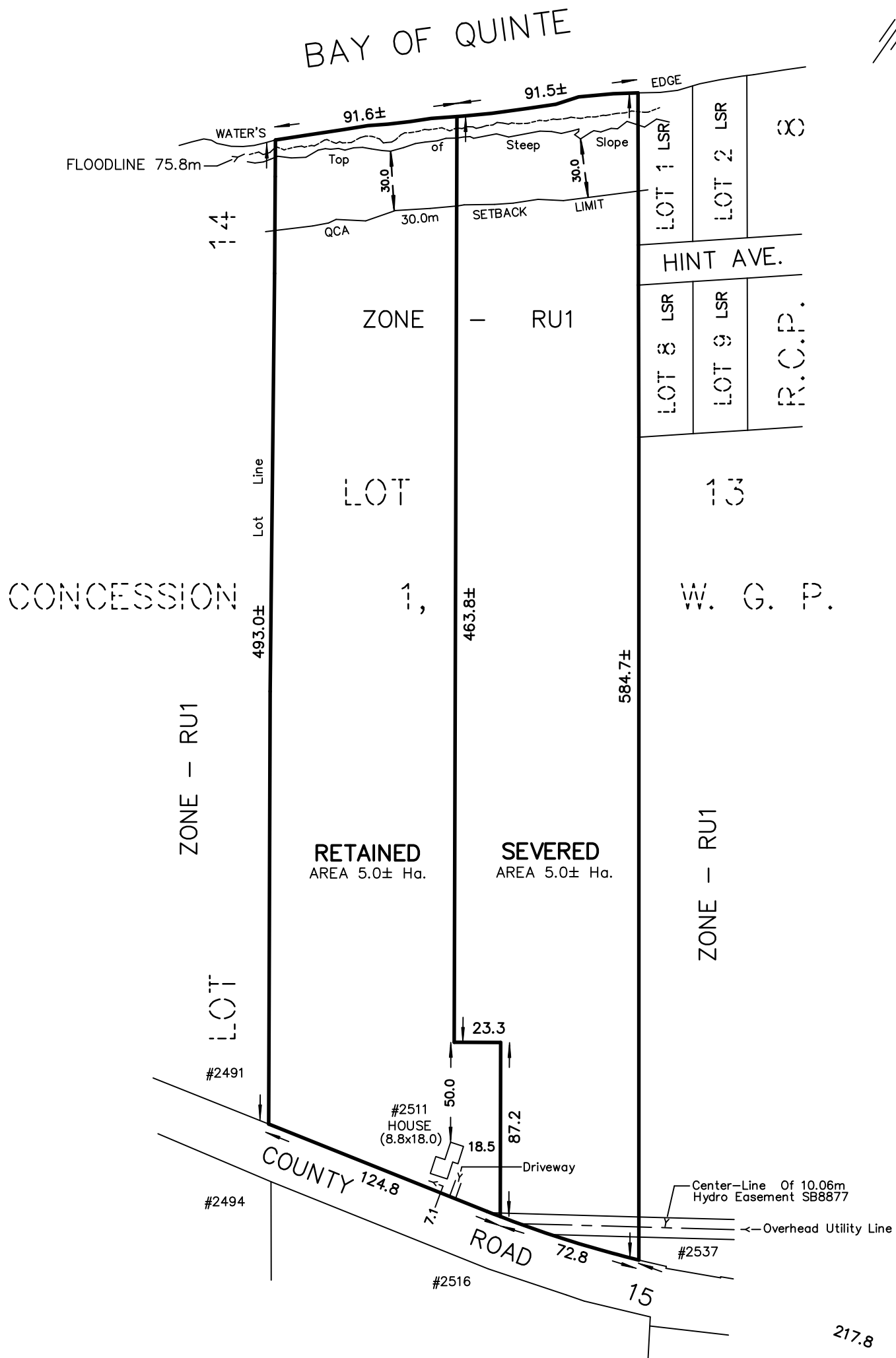
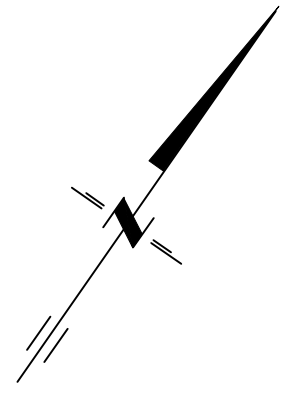

NOTES :

2511 COUNTY ROAD 15
 PART OF LOT 13
 CONCESSION 1, WEST OF GREEN POINT
 TOWNSHIP OF SOPHIASBURGH
 NOW IN THE MUNICIPALITY OF THE
 COUNTY OF PRINCE EDWARD

DIMENSIONS AND INFORMATION SHOWN ARE DERIVED FROM PLAN 254,
 47R-7797, 47R-1013 AND COMPILED PLAN 8.

75.8m FLOODLINE, STEEP SLOPE LIMIT AND 30.0m SLOPE SETBACK PROVIDED
 BY QUINTE CONSERVATION AUTHORITY - SITE VISIT REPORT-SV0182-2021

DISTANCES SHOWN ON THIS PLAN ARE IN METRES
 AND CAN BE CONVERTED TO FEET BY DIVIDING BY 0.3048.

THIS SKETCH IS AN ORIGINAL IF EMBOSSED BY THE SURVEYOR'S SEAL.

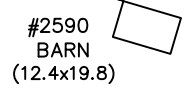

APRIL 13, 2022

CAUTION

THIS IS NOT A PLAN OF SURVEY AND SHALL NOT BE USED
 EXCEPT FOR THE PURPOSE INDICATED IN THE TITLE BLOCK

218 CHURCH STREET BELLEVILLE, ONTARIO	WATSON LAND SURVEYORS Ltd.	K8N - 3C3 (613) 962 - 9521
© Copyright WATSON LAND SURVEYORS LTD. 2022		PROJECT N ^o 13693-S-22