

SKETCH
 PART OF LOT 90
 CONCESSION 3
 TOWNSHIP OF AMELIASBURGH
 NOW IN THE MUNICIPALITY OF
 THE COUNTY OF PRINCE EDWARD
 METRIC SCALE 1 : 2000

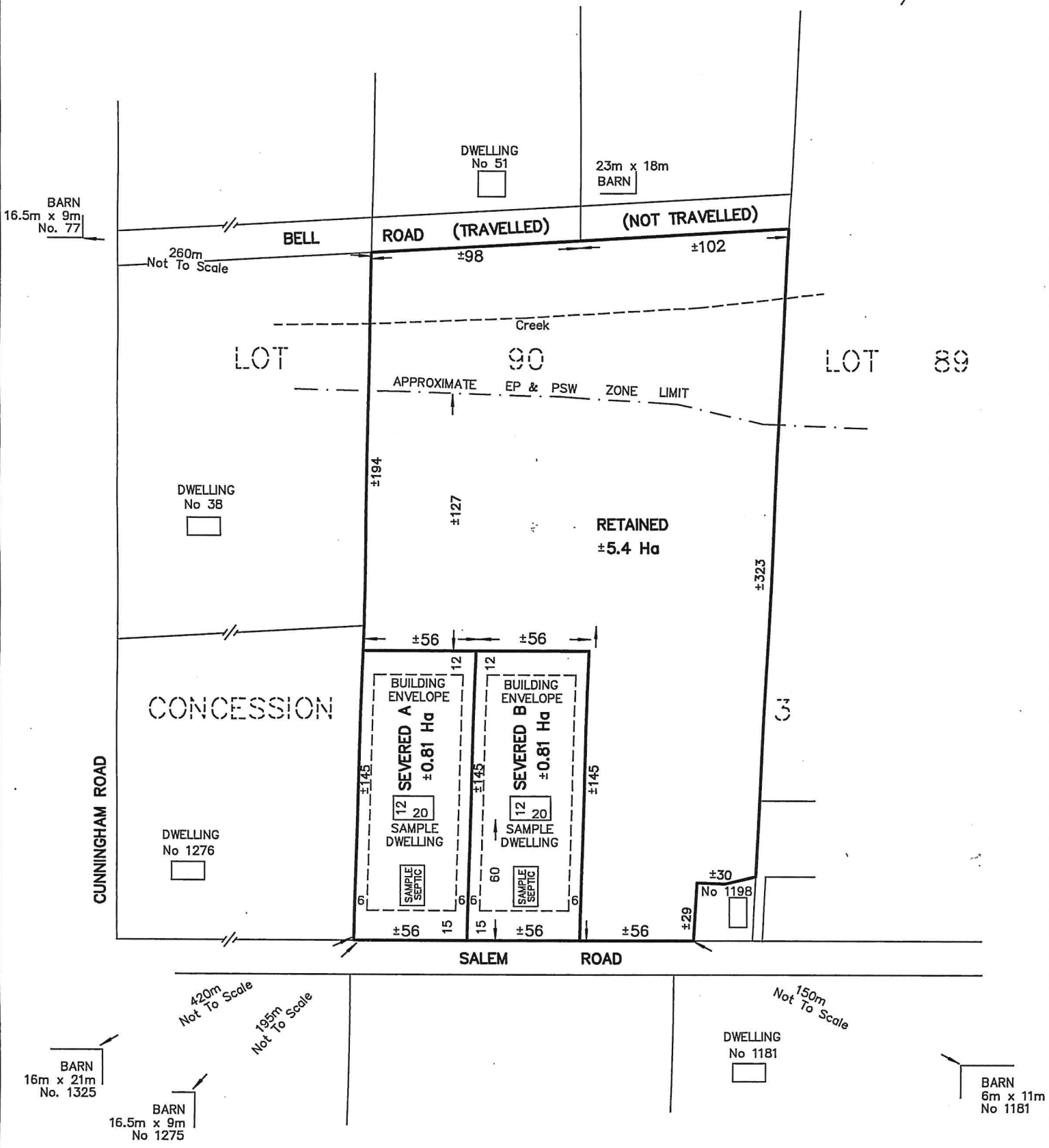

218 CHURCH STREET BELLEVILLE, ONTARIO	<h1>WATSON</h1> LAND SURVEYORS Ltd.	K8N - 3C3 (613) 962 - 9521
FEBRUARY 16, 2021	PROJECT No 12712-H-21	