

- NOTES:**
1. ALL WORK SHALL BE IN ACCORDANCE WITH RELEVANT CODES AND GUIDELINES.
 2. ALL DRAWINGS AND ADDENDA ARE TO BE READ AS, AND IN CONJUNCTION WITH THE SPECIFICATIONS.
 3. ALL EQUIPMENT SHALL BE INSTALLED AS SPECIFIED OR APPROVED EQUIVALENT.
 4. CONTRACTOR MUST CHECK AND VERIFY ALL DIMENSIONS BEFORE PROCEEDING WITH WORK AND BE RESPONSIBLE FOR SAME.
 5. CONTRACTOR MUST REPORT ANY DISCREPANCIES TO ENGINEER FOR RESOLUTION BEFORE COMMENCING THE WORK.
 6. ANY CHANGES MUST BE APPROVED BY THE ENGINEER.

A A DETAIL NO.
 B B DRAWING NO. - WHERE DETAILED

EXISTING	LEGEND	PROPOSED
	GRAVEL	N/A
	BUILDINGS	N/A
	DECKING	N/A
	GRASS	N/A
	ROAD	N/A
	SHOULDER OF ROAD	N/A
	CONCRETE SIDEWALK	N/A
	ASPHALT	N/A
	CENTRELINE	N/A
	EMERGENCY VEHICLE ROUTE/RADI	N/A
	GRAVEL OUTLINE	N/A
	FENCE LINE	N/A
	DRAINAGE PATH	N/A
	PROPERTY LINE	N/A
	SLOPE IDENTIFIER	N/A
	SEPTIC	N/A
	TREE	N/A
	TREE CANOPY	N/A
	SHRUB	N/A
	SIGNAGE	N/A
	LIGHT STANDARD	N/A
	STORM CATCHBASIN	N/A
	HYDRO POLE	N/A
	HYDRO LINE	N/A
	BELL POLE	N/A
	BELL LINE	N/A
	ANCHOR	N/A
	PARKING SPACES	N/A
	PRECAST CURBS	N/A
	BUILDING ENTRANCE	N/A
	T/G ELEVATIONS	N/A
	SWAILE ELEVATIONS	N/A
	SLOPE LABELS	N/A

REVISION	DESCRIPTION	DATE
03	RE-ISSUED FOR SITE PLAN SUBMISSION	23/08/01
02	RE-ISSUED FOR SITE PLAN SUBMISSION	23/01/10
01	ISSUED FOR SITE PLAN SUBMISSION	21/12/08

REVISION DESCRIPTION DATE

NORTH

STAMP

LICENSED PROFESSIONAL ENGINEER
 M.D. McIntosh
 100056710
 August 01 2023
 PROVINCE OF ONTARIO

PROJECT
OUTERBANKS MOTEL
 2052 COUNTY ROAD 18
 PRINCE EDWARD COUNTY, ON

FRASER YOUNG
 DRAWING TITLE
PROPOSED SITE SERVICING PLAN

DESIGNED BY
 Y. CHOKSHI

DRAWN BY
 E. L / BCF

REVIEWED BY
 A. VOLDOCK

APPROVED BY
 A. VOLDOCK

PROJECT DATE
 2021/12/06 (YYYY/MM/DD)

PROJECT #
 21-3-6509

DRAWING #
 SPCA-5

DRAWING SCALE (ISO A1)
 HOR: 1:150
 VER: X : XXX

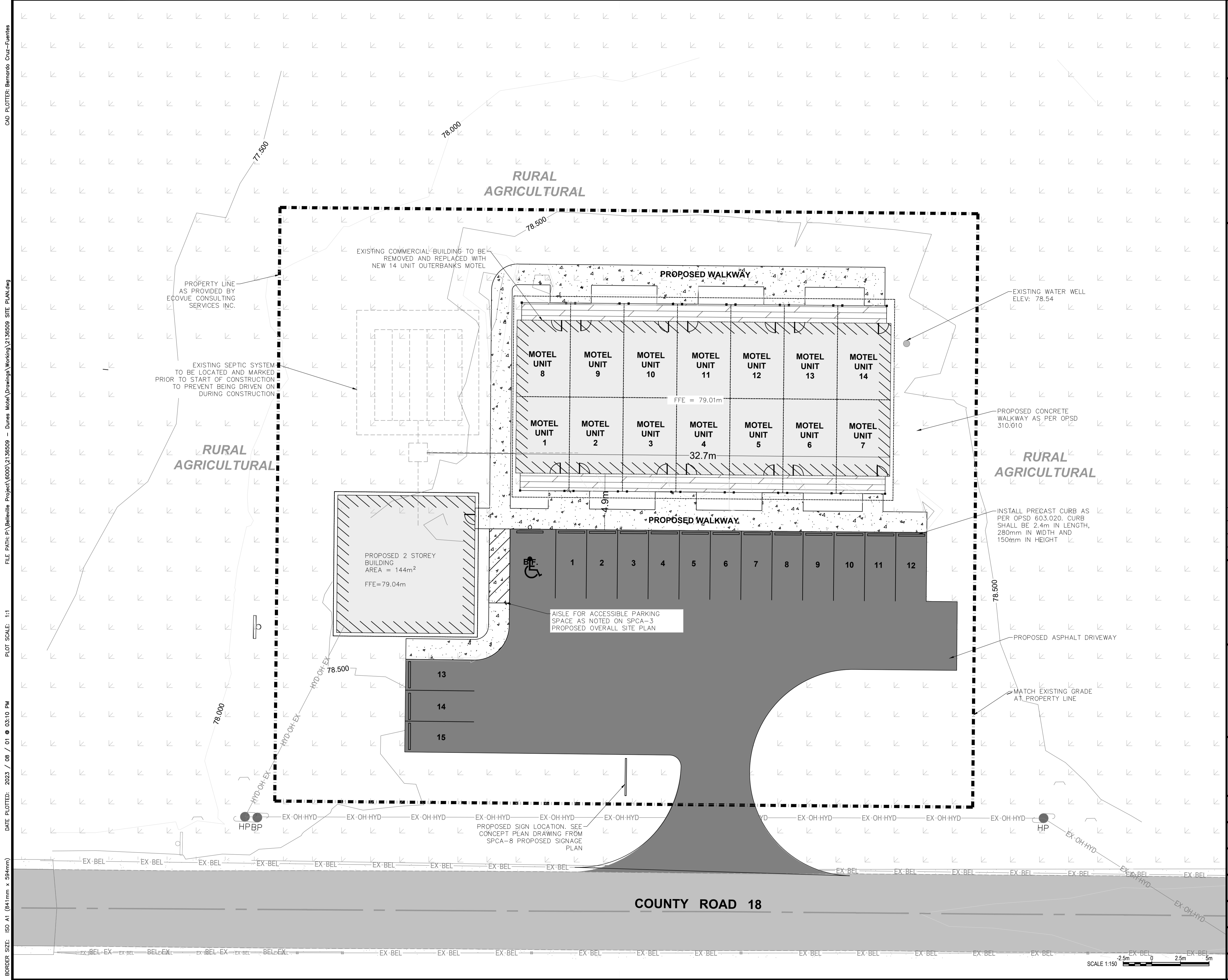

CAD PLOTTER: Bernardo Cruz-Fuentes
 FILE PATH: P:\Belleville Project\6000\2136509 - Dunes Motel\Drawings\Working\2136509 SITE PLAN.dwg
 PLOT SCALE: 1:1
 DATE PLOTTED: 2023 / 08 / 01 @ 03:10 PM
 BORDER SIZE: ISO A1 (841mm x 594mm)

(METRIC SCALE - ALL DIMS IN METERS U.N.O.)