

TOPOGRAPHIC SURVEY: GGG DUNES MOTEL-SURVEY 08/19/2021
 GEOTECHNICAL TESTING: NOT AVAILABLE
 LOCATES: ONTARIO ONE CALL - 11/14/2022

NOTE: GEOTECHNICAL CONSULTANT SHALL VERIFY THE ASPHALT DESIGN PRIOR TO CONSTRUCTION. CONTRACTOR SHALL PROOF ROLL PRIOR TO ASPHALT PLACEMENT.

GREER GALLOWAY CONSULTING ENGINEERS
 PETERBOROUGH BELLEVILLE KINGSTON
 1620 WALLBRIDGE LOYALIST ROAD
 BELLEVILLE, ONTARIO, K8N 4Z5
 PHONE: 613-966-3068
 FAX: 613-966-3087

- NOTES:
- ALL WORK SHALL BE IN ACCORDANCE WITH RELEVANT CODES AND GUIDELINES.
 - ALL DRAWINGS AND ADDENDA ARE TO BE READ AS, AND IN CONJUNCTION WITH THE SPECIFICATIONS.
 - ALL EQUIPMENT SHALL BE INSTALLED AS SPECIFIED OR APPROVED EQUIVALENT.
 - CONTRACTOR MUST CHECK AND VERIFY ALL DIMENSIONS BEFORE PROCEEDING WITH WORK AND BE RESPONSIBLE FOR SAME.
 - CONTRACTOR MUST REPORT ANY DISCREPANCIES TO ENGINEER FOR RESOLUTION BEFORE COMMENCING THE WORK.
 - ANY CHANGES MUST BE APPROVED BY THE ENGINEER.

A A DETAIL NO.
 B B DRAWING NO. - WHERE DETAILED

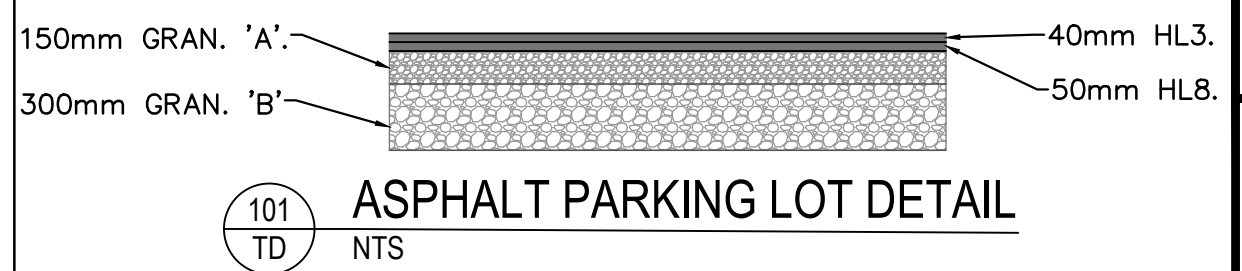

GENERAL NOTES:

- PRIOR TO COMMENCEMENT OF ANY WORKS WITHIN THE MUNICIPAL ROAD ALLOWANCE, THE OWNER IS RESPONSIBLE FOR OBTAINING ALL NECESSARY PERMITS FROM THE PUBLIC WORKS AND ENVIRONMENTAL SERVICES DEPARTMENT, THE MUNICIPALITY OF PRINCE EDWARD COUNTY, FOR THE PURPOSES OF VEHICULAR ACCESS TO THE PROPERTY, (ENTRANCE PERMIT), AND SERVICING EXCAVATIONS (ROAD OCCUPANCY PERMIT) WITHIN THE MUNICIPAL ROAD ALLOWANCE.
 - FOR FULL LANDSCAPE PLAN SEE "PROPOSED LANDSCAPING PLAN SPCA-6" AS PROVIDED BY ECOVUE CONSULTING SERVICES INC.
- SEDIMENTATION & EROSION CONTROL:**
- ALL DISTURBED AREAS TO BE RESTORED TO ORIGINAL CONDITION OR BETTER UNLESS OTHERWISE SPECIFIED.
 - LIGHT DUTY SILT FENCE (OPSD 219.110) TO BE INSTALLED ON THE DOWNSIDE PERIMETER OF ALL DISTURBED AREAS.
 - SILT CONTROLS ARE TO BE IN PLACE PRIOR TO THE START OF THE SITE WORKS, AND ARE TO BE MAINTAINED FOR THE DURATION OF CONSTRUCTION.
- CONSTRUCTION NOTES - ENVIRONMENTAL:**
- ANY WASTES OR EXCESS FILL GENERATED BY SITE TO BE MANAGED IN ACCORDANCE WITH APPLICABLE LAWS AND STANDARDS; INCLUDING O.REG 406/19
 - ANY UNUSED WATER WELLS (DRILLED OR DUG) ARE PROPERLY ABANDONED IN ACCORDANCE WITH ONTARIO REGULATION 903 - WELLS OR AS REVISED;
 - CONSTRUCTION WASTES ARE NOT TO BE BURIED WITHIN THE PROPERTY THAT IS THE SUBJECT OF THIS AGREEMENT, AND;
 - THAT THE OWNER AND THEIR CONTRACTORS REPORT ALL SPILLS TO THE MINISTRY OF ENVIRONMENTS SPILLS ACTION CENTRE (1-800-268-6060) AND TO THE MUNICIPALITY (546-4291 EXT.1368) FORTHWITH.

FILE PATH: P:\Belleville Project\6000\2136509 - Dunes Motel\Drawings\Working\2136509 SITE PLAN.dwg
 DATE PLOTTED: 2024 / 03 / 04 @ 03:47 PM
 PLOT SCALE: 1:1
 BORDER SIZE: ISO A1 (841mm x 594mm)

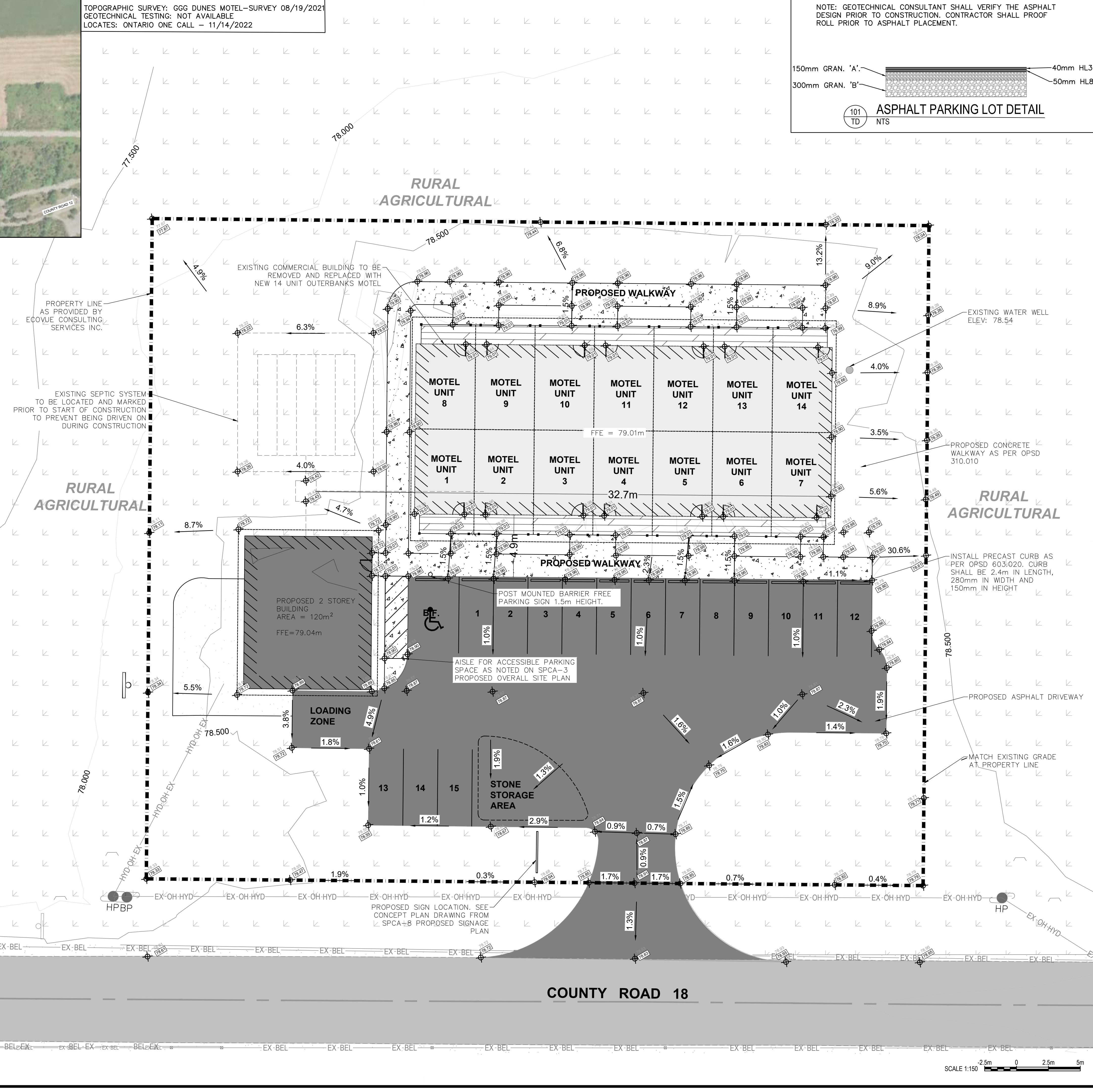
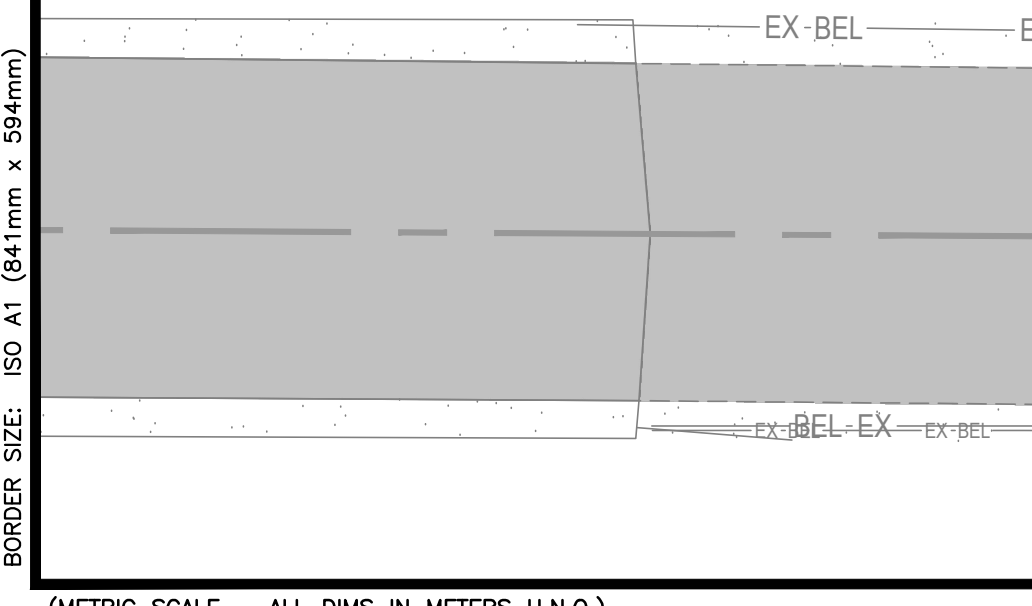

EXISTING	LEGEND	PROPOSED
[Symbol]	GRAVEL	N/A
[Symbol]	BUILDINGS	N/A
[Symbol]	DECKING	N/A
[Symbol]	GRASS	N/A
[Symbol]	ROAD	N/A
[Symbol]	SHOULDER OF ROAD	N/A
[Symbol]	CONCRETE SIDEWALK	N/A
[Symbol]	ASPHALT	N/A
[Symbol]	CENTRELINE	N/A
[Symbol]	EMERGENCY VEHICLE ROUTE/RADIUS	N/A
[Symbol]	GRAVEL OUTLINE	N/A
[Symbol]	FENCE LINE	N/A
[Symbol]	DRAINAGE PATH	N/A
[Symbol]	PROPERTY LINE	N/A
[Symbol]	SLOPE IDENTIFIER	N/A
[Symbol]	SEPTIC	N/A
[Symbol]	TREE	N/A
[Symbol]	TREE CANOPY	N/A
[Symbol]	SHRUB	N/A
[Symbol]	SIGNAGE	N/A
[Symbol]	LIGHT STANDARD	N/A
[Symbol]	STORM CATCHBASIN	N/A
[Symbol]	HYDROPOLE	N/A
[Symbol]	HYDRO LINE	N/A
[Symbol]	BELL POLE	N/A
[Symbol]	BELL LINE	N/A
[Symbol]	ANCHOR	N/A
[Symbol]	PARKING SPACES	N/A
[Symbol]	PRECAST CURBS	N/A
[Symbol]	BUILDING ENTRANCE	N/A
[Symbol]	T/G ELEVATIONS	N/A
[Symbol]	SWALE ELVATIONS	N/A
[Symbol]	SLOPE LABELS	N/A

REVISION	DESCRIPTION	DATE
03	RE-ISSUED FOR SITE PLAN SUBMISSION	24/03/04
02	RE-ISSUED FOR SITE PLAN SUBMISSION	23/01/10
01	ISSUED FOR SITE PLAN SUBMISSION	21/12/08

NORTH

STAMP

PROJECT
OUTERBANKS MOTEL
 2052 COUNTY ROAD 18
 PRINCE EDWARD COUNTY, ON

FRASER YOUNG
 DRAWING TITLE
PROPOSED GRADING PLAN

DESIGNED BY
Y. CHOKSHI

DRAWN BY
E. L / BCF

REVIEWED BY
A. VOLDOCK

APPROVED BY
A. VOLDOCK

PROJECT DATE
2021/12/06
 (YYYY/MM/DD)

PROJECT #
21-3-6509

DRAWING #
SPCA-4
 DRAWING SCALE (ISO A1)
 HOR: AS NOTED
 VER: X : XXX

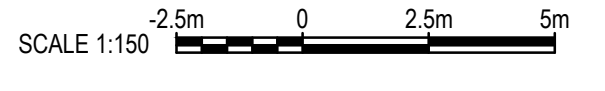

(METRIC SCALE - ALL DIMS IN METERS U.N.O.)