

WANDER THE RESORT PLANTING PLAN

LOYALIST PARKWAY
(DESIGNATED AS THE KING'S HIGHWAY No. 33 BY ORDER IN COUNCIL OC-1847/60, HIGHWAY PLAN NO. 127)
(TRANSFERRED TO THE COUNTY OF FRANCE EDWARD ORDER IN COUNCIL OC-2016-14, INSTRUMENT NO. PER/276
PIN 16550-033 (LT))

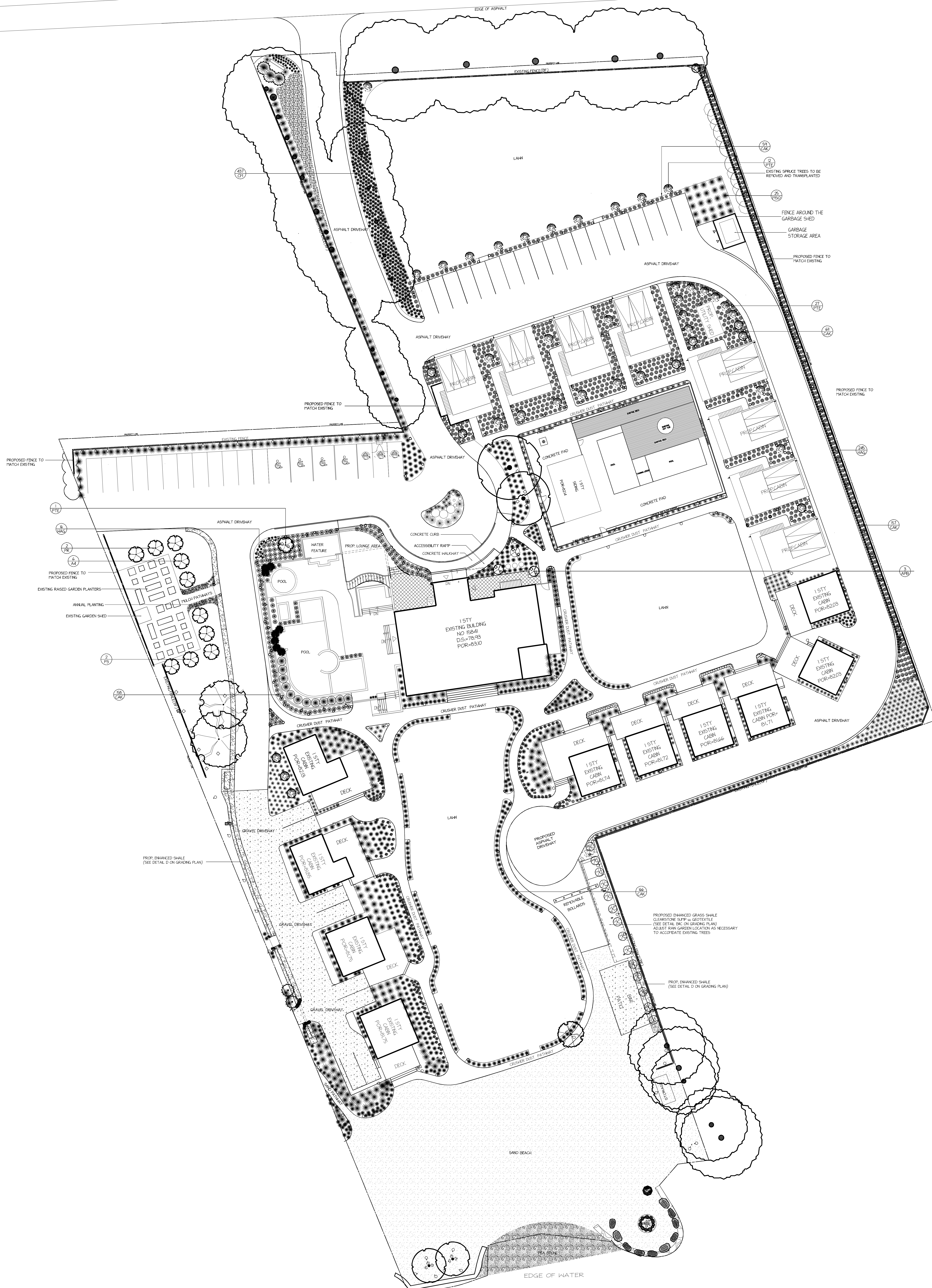

LEGEND

LANDSCAPE LIGHTING

- EXISTING ACCENT LIGHT
- EXISTING PATHLIGHT
- EXISTING IN-GROUND ACCENT LIGHT
- EXISTING CABIN SIGN DIRECTIONAL LIGHT
- PROPOSED ACCENT LIGHT
- PROPOSED PATHLIGHT
- PROPOSED UPLIGHT
- PROPOSED CABIN SIGN DIRECTIONAL LIGHT
- LOW VOLTAGE TRANSFORMER
- OUTDOOR SPEAKER
- OUTDOOR SUBWOOFER
- GFI RECEPTACLE

RESORT SIGNAGE

- WANDER THE RESORT MONUMENT SIGN
- WAY FINDING BOARD
- CABIN SIGNAGE
- ELECTRIC VEHICLE CHARGER
- STAFF ACCESS ONLY
- GARDEN
- SALINA
- BEACH RULES
- POOL RULES
- NO PARKING FIRE ROUTE

RESORT PLANTING

- EXISTING ORNAMENTAL GRASS
- EXISTING ORNAMENTAL GRASS
- EXISTING ORNAMENTAL GRASS
- EXISTING SHEDDISH COLLIFFAR ASPEN
- EXISTING GROUNDCOVER
- EXISTING COLLIFFAR SPRUCE
- PROPOSED ORNAMENTAL GRASS
- PROPOSED ORNAMENTAL GRASS
- PROPOSED SHEDDISH COLLIFFAR ASPEN
- PROPOSED JAPANESE MAPLE

client:
WANDER THE RESORT
15841 LOYALIST PKWY
BLOOMFIELD, ONT

PLANTING PLAN

scale: 1:250
date: FEB. 2024

project #: 2022-9762
drawing #: PP-01J

drawn by: TJ
checked by: TD

