

NEW TYPE A BED CALCULATIONS
CALCULATIONS AS PER ONTARIO BUILDING CODE PART 8
DAILY SEWAGE FLOW DETERMINATION

(8) 2 BEDROOM DWELLINGS / FIXTURES-20 / FLOOR AREA < 200m²
 2 BEDROOM = 1100L/DAY X 8 = 8,800 L/DAY

SWIMMING & BATHING FACILITIES (OBC 8.2.1.3.B.(23))
 - 80 PEOPLE @ 40 L/DAY PER PERSON = 3,200 L/DAY

PROPOSED EXPANSION TOTAL (Q) = 12,000 L/DAY

NEW SEPTIC TANK SIZING
 - RESIDENTIAL 12,000 L/DAY X 2 = 24,000 L/DAY

PROPOSED NEW SEPTIC TANK VOLUME = 24,000L

LOADING
 EXISTING SOIL:
 T-TIME > 50 (CLAY)

TYPE A BED CALCULATIONS
 FLOW RATE > 3000L/DAY
 THEREFORE USE Q/50

STONE AREA = 247m² → $\frac{247 \times 12000}{300} = 240m^2$ (REQ'D)

SAND AREA = 1,516m² → $\frac{1,516 \times 12000}{300} = 1,500$ (REQ'D)

| EXISTING SYSTEM | TANK SIZE | BED TYPE |
|-----------------|-----------|---|
| #1 | 3650L | 6 ABSORPTION TRENCHES 1.5m WIDE, 20m LONG |
| #2 | 4720L | 8 ABSORPTION TRENCHES 1.5m WIDE, 15.25m LONG |
| #3 | 4915L | 6 ABSORPTION TRENCHES 1.5m WIDE, 15.25m LONG |
| #4 | 4815L | 6 ABSORPTION TRENCHES 1.5m WIDE, 15.25m LONG |
| #5 | 5115L | 6 ABSORPTION TRENCHES 1.5m WIDE, 15.25m LONG |
| #6 | 5115L | 6 ABSORPTION TRENCHES 1.5m WIDE, 15.25m LONG |

LEGEND

- MONITORING WELL ⊗
- PROPERTY LINE - - - - -
- CLEANOUT ○

GROUNDWORK ENGINEERING LIMITED
 GEOTECHNICAL • CIVIL • STORMWATER • ONSITE WASTEWATER

UNIT 640 - 654 NORRIS COURT
 KINGSTON ONTARIO
 OFFICE (613) 634-1789
 www.groundengineer.ca

Client / Land Owner: SHANNON HUNTER

Project: WANDER THE RESORT

WELLINGTON ONTARIO

Drawing Title: SEPTIC PLAN

Drawn by: J.H.

Checked By: M.H.B.

Page Size: 24"x36"

Scale: 1:500

Date: FEBRUARY 26, 2024

Project Number: GW-21002-54

Drawing Number: C-101

SHEET 1 of 2

REVISIONS

| No. | Description | Date |
|-----|---------------------------------------|------------|
| 08 | UPDATED NITREX SYSTEM LAYOUT | 2023/08/28 |
| 09 | UPDATED SEWER DISTRIBUTION | 2023/10/13 |
| 10 | ADDED 2ND ECOFLO (POLISHING UNIT) | 2023/11/27 |
| 11 | UPDATED SITE PLAN - 6IX DESIGN | 2023/12/20 |
| 12 | RELOCATED SPA PC - AS PER 6IX DESIGN | 2024/1/11 |
| 13 | UPDATED SITE PLAN - AS PER 6IX DESIGN | 2024/2/12 |
| 14 | ISSUED FOR SUBMISSION | 2024/2/26 |

BENCHMARK:

| No. | DESCRIPTION | ELEVATION |
|-----|-------------|-----------|
| | | |

PROFESSIONAL ENGINEER
 M. H. BURGER
 LICENSED PROFESSIONAL ENGINEER
 PROVINCE OF ONTARIO

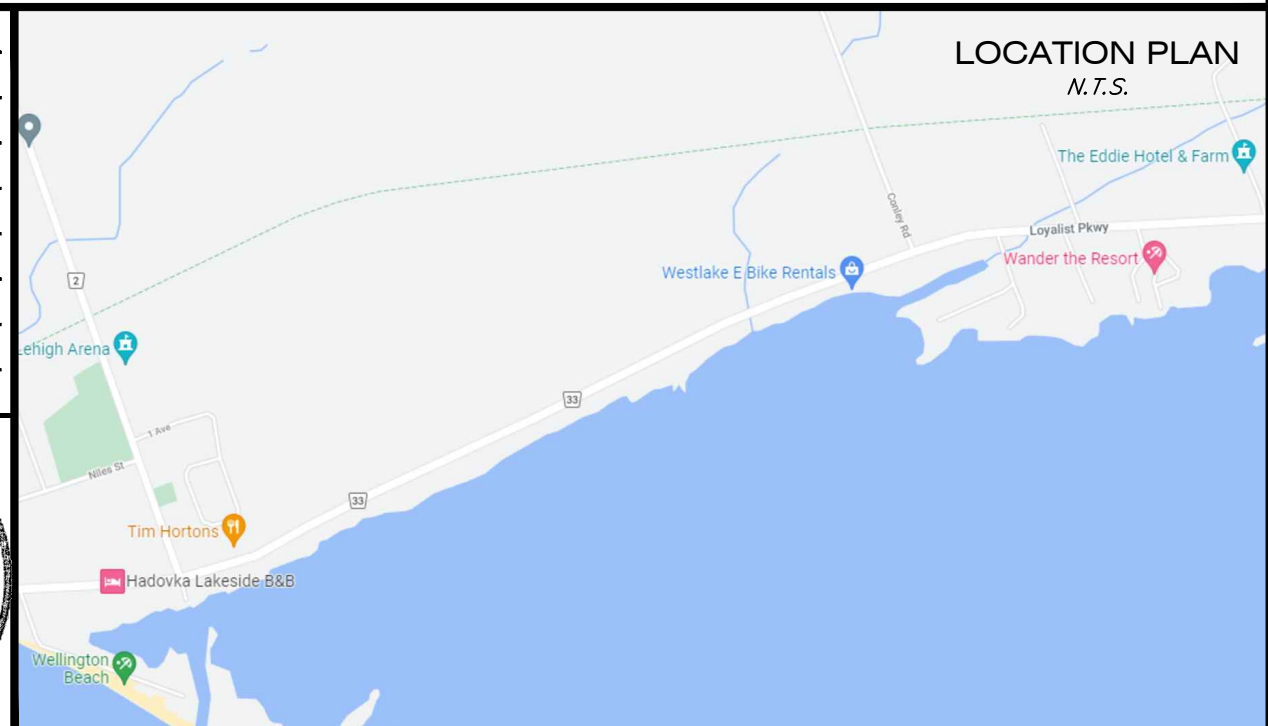

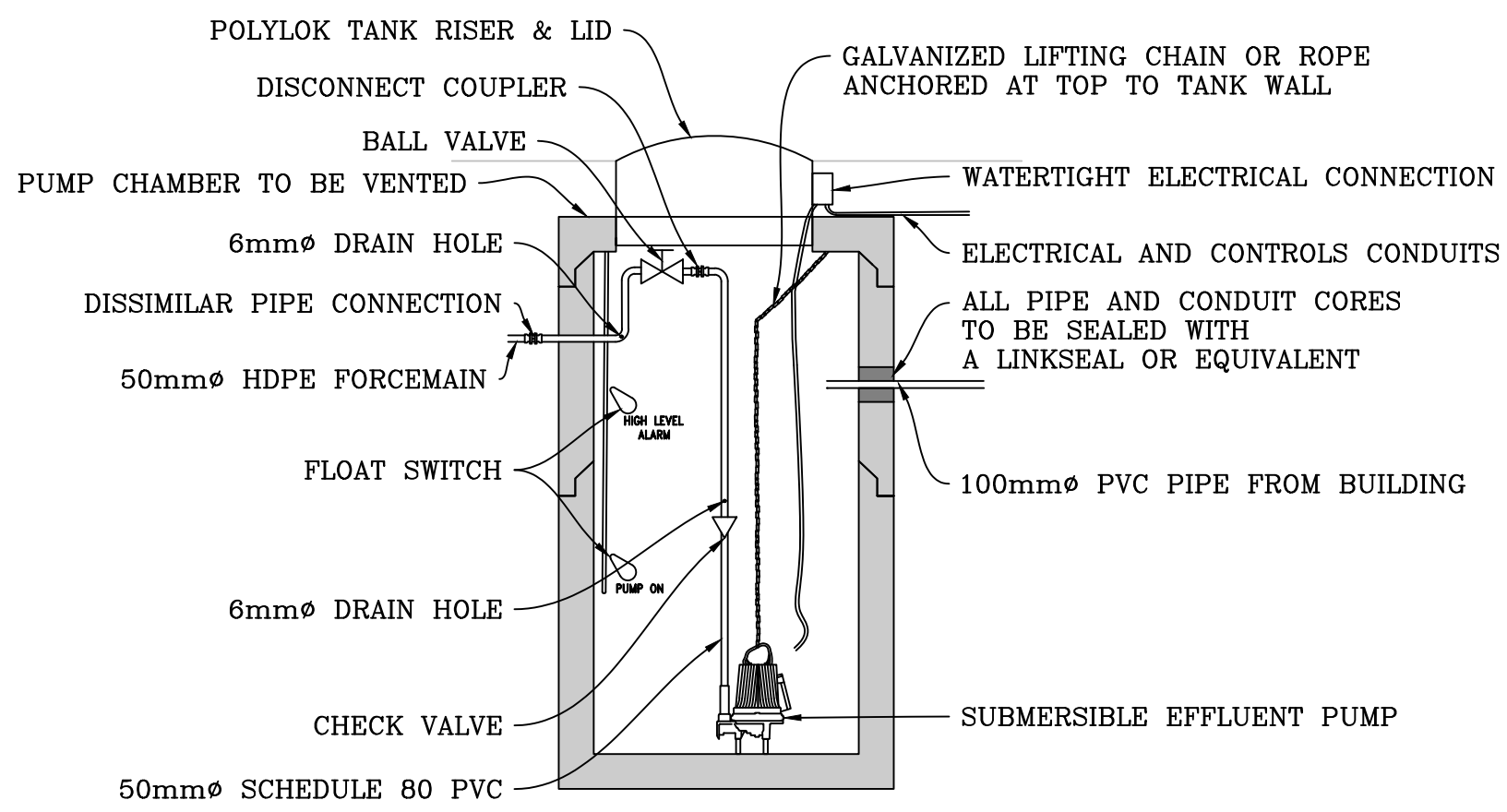

1 TYPICAL PUMP CHAMBER
C-102 N.T.S.

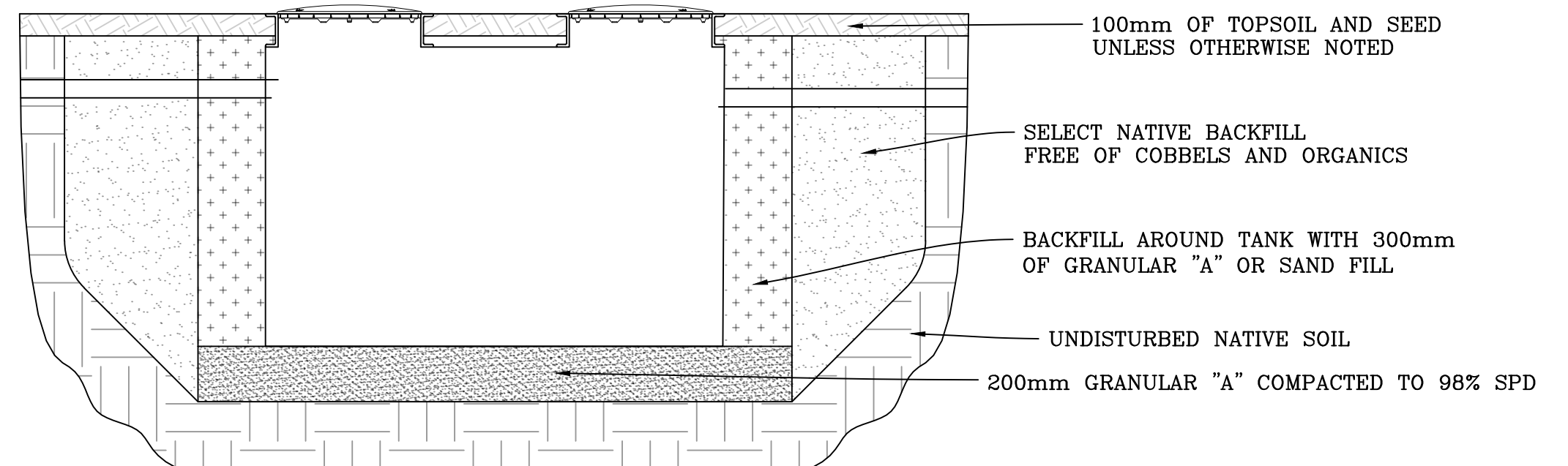

2 TYPICAL TANK INSTALLATION
C-102 N.T.S.

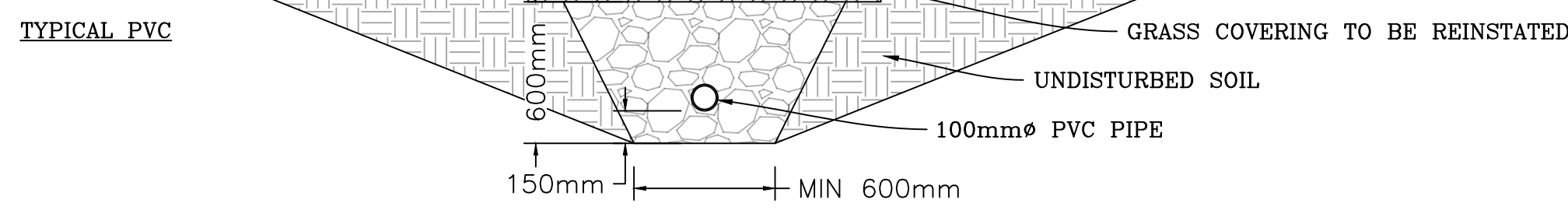
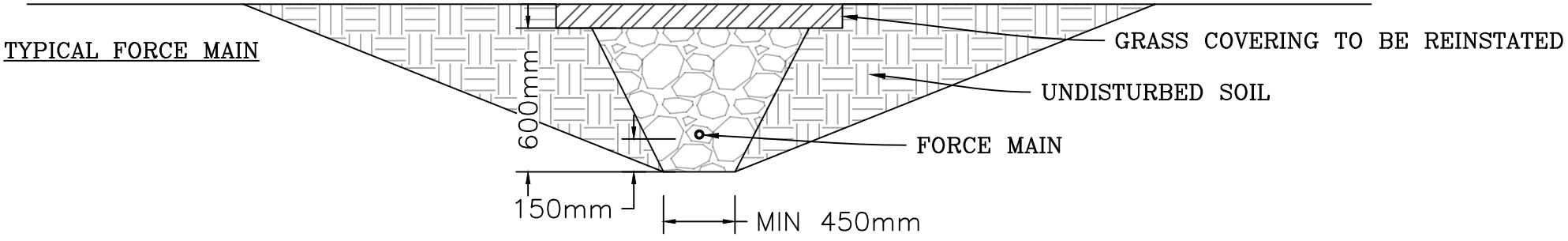

3 TYPICAL TRENCH DETAILS
C-102 N.T.S.

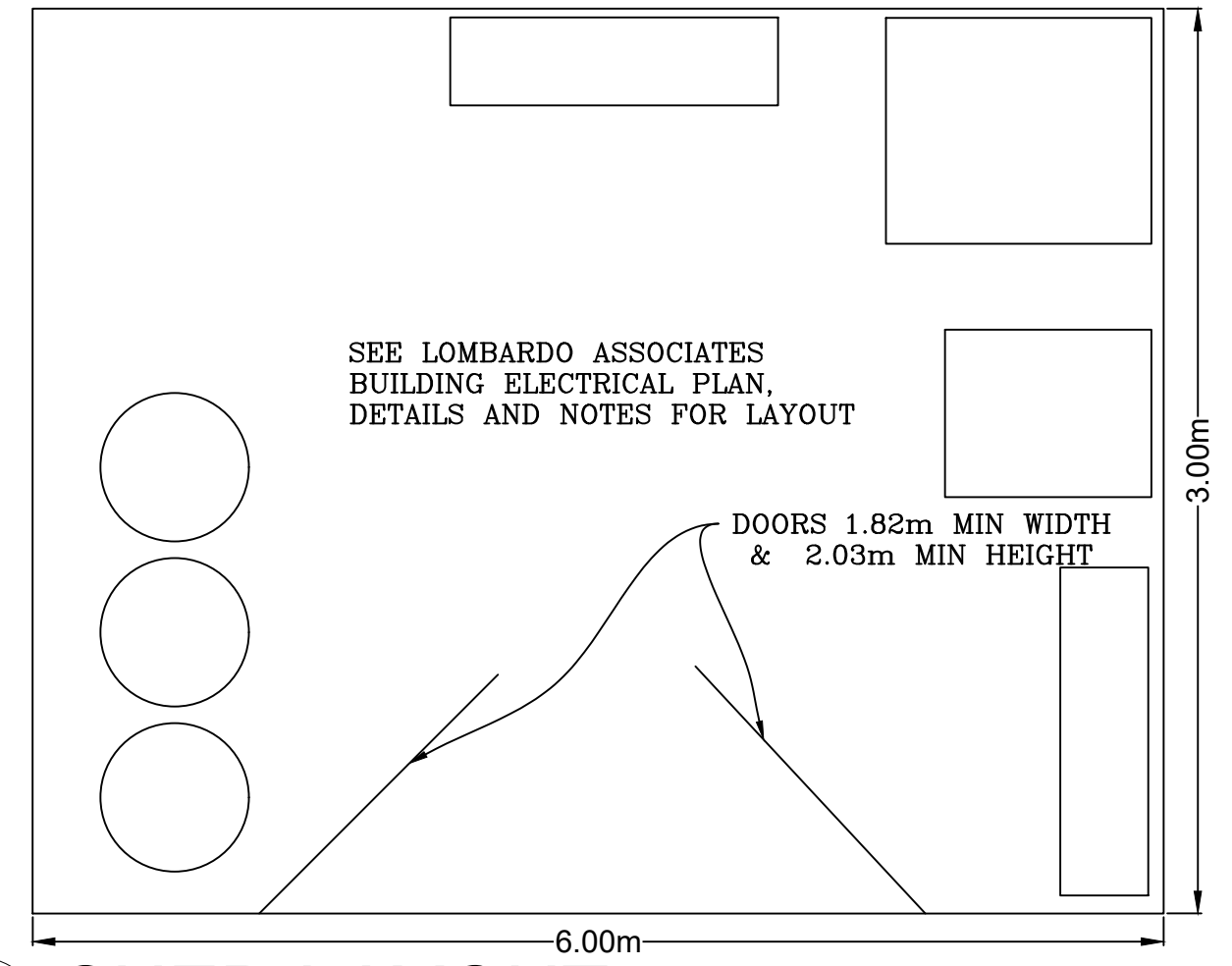

4 SHED LAYOUT
C-102 N.T.S.

PIPING AND ELECTRICAL LAYOUT PROVIDED BY NITREX SYSTEM DESIGNER (LOMBARDO & ASSOCIATES)

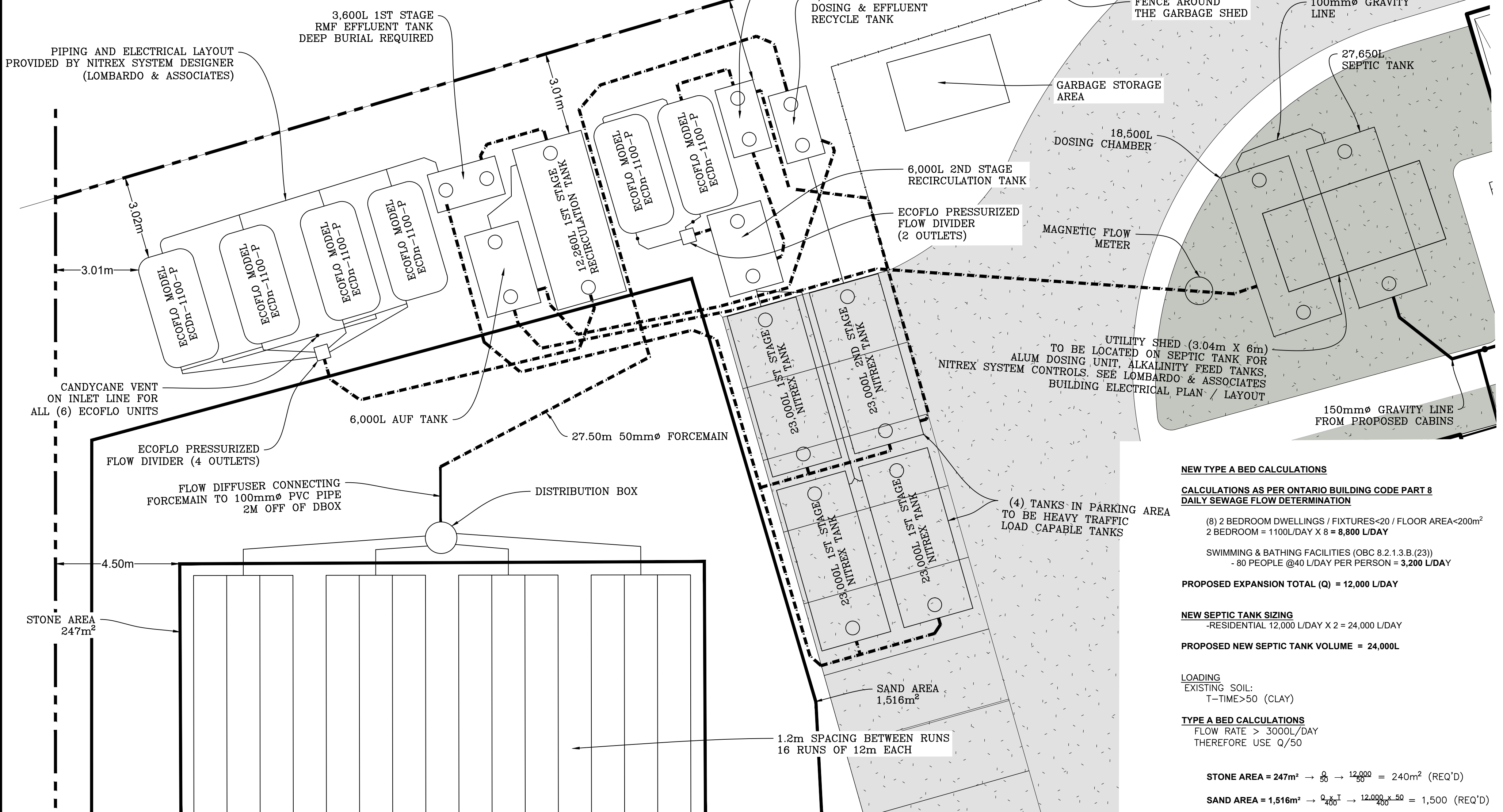

5 TREATMENT SYSTEM DETAILS
C-102 1:100

NEW TYPE A BED CALCULATIONS
CALCULATIONS AS PER ONTARIO BUILDING CODE PART 8 DAILY SEWAGE FLOW DETERMINATION
(8) 2 BEDROOM DWELLINGS / FIXTURES < 20 / FLOOR AREA < 200m²
2 BEDROOM = 1100L/DAY X 8 = 8,800 L/DAY
SWIMMING & BATHING FACILITIES (OBC 8.2.1.3 B. (23))
- 80 PEOPLE @ 40 L/DAY PER PERSON = 3,200 L/DAY
PROPOSED EXPANSION TOTAL (Q) = 12,000 L/DAY

NEW SEPTIC TANK SIZING
RESIDENTIAL 12,000 L/DAY X 2 = 24,000 L/DAY
PROPOSED NEW SEPTIC TANK VOLUME = 24,000L

LOADING
EXISTING SOIL:
T-TIME > 50 (CLAY)

TYPE A BED CALCULATIONS
FLOW RATE > 3000L/DAY
THEREFORE USE Q/50

STONE AREA = 247m² → $\frac{12,000}{50} = 240m²$ (REQ'D)
SAND AREA = 1,516m² → $\frac{24,000}{50} = 480m²$ (REQ'D)

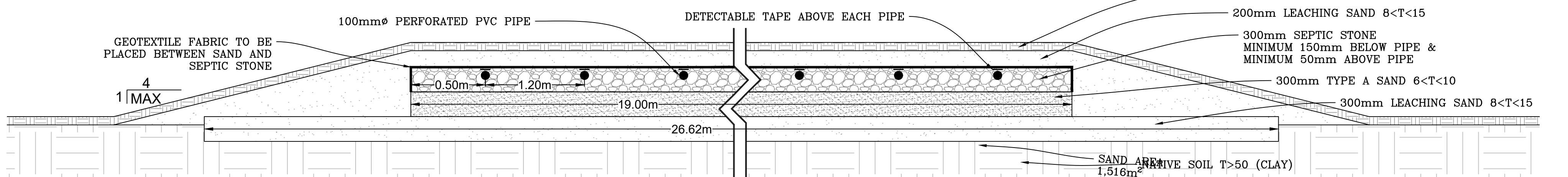

6 TYPE A DISPERSAL BED SECTION VIEW
C-102 NTS

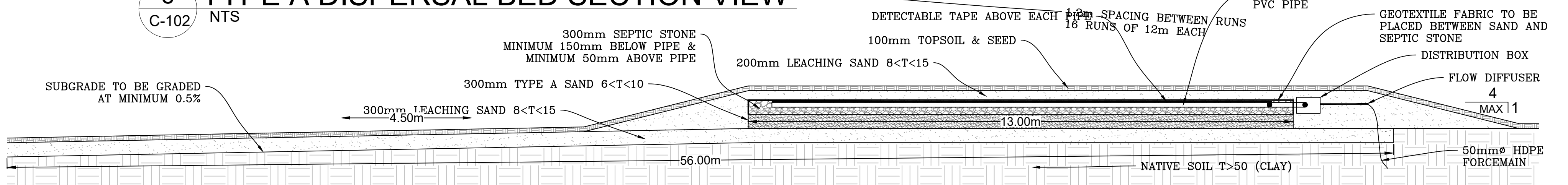

7 TYPE A DISPERSAL BED PROFILE VIEW
C-102 NTS

GROUNDWORK ENGINEERING LIMITED
GEO-TECHNICAL • CIVIL • STORMWATER • ONSITE WASTEWATER

UNIT 640 - 654 NORRIS COURT
KINGSTON ONTARIO
OFFICE (613) 634-1789
www.groundengineer.ca

| | |
|---|--------------------------------|
| Client / Land Owner: SHANNON HUNTER | |
| Project: WANDER THE RESORT | |
| WELLINGTON | ONTARIO |
| Drawing Title: DETAILS | |
| Drawn by: J.H. | Project Number: GW-21002-54 |
| Checked By: M.H.B. | Drawing Number: C-102 |
| Page Size: 24"x36" | Scale: AS NOTED |
| Date: FEBRUARY 26, 2024 | SHEET 2 of 2 |

| REVISIONS | | |
|-----------|--------------------------------------|------------|
| No. | Description | Date |
| 08 | UPDATED NITREX SYSTEM LAYOUT | 2023/08/28 |
| 09 | UPDATED SEWER DISTRIBUTION | 2023/10/13 |
| 10 | ADDED 2ND ECOFLO (POLISHING UNIT) | 2023/11/27 |
| 11 | UPDATED SITE PLAN - 6IX DESIGN | 2023/12/20 |
| 12 | RELOCATED SPA PC - AS PER 6IX DESIGN | 2024/1/11 |
| 13 | RELOCATED SPA PC - AS PER 6IX DESIGN | 2024/1/11 |
| 14 | ISSUED FOR SUBMISSION | 2024/2/26 |

BENCHMARK:
No. DESCRIPTION ELEVATION

M. H. BURGER
LICENSED PROFESSIONAL ENGINEER
PROVINCE OF ONTARIO

