

# SKETCH for MINOR VARIANCE APPLICATION

METRIC SCALE 1 : 300

BAY OF QUINTE

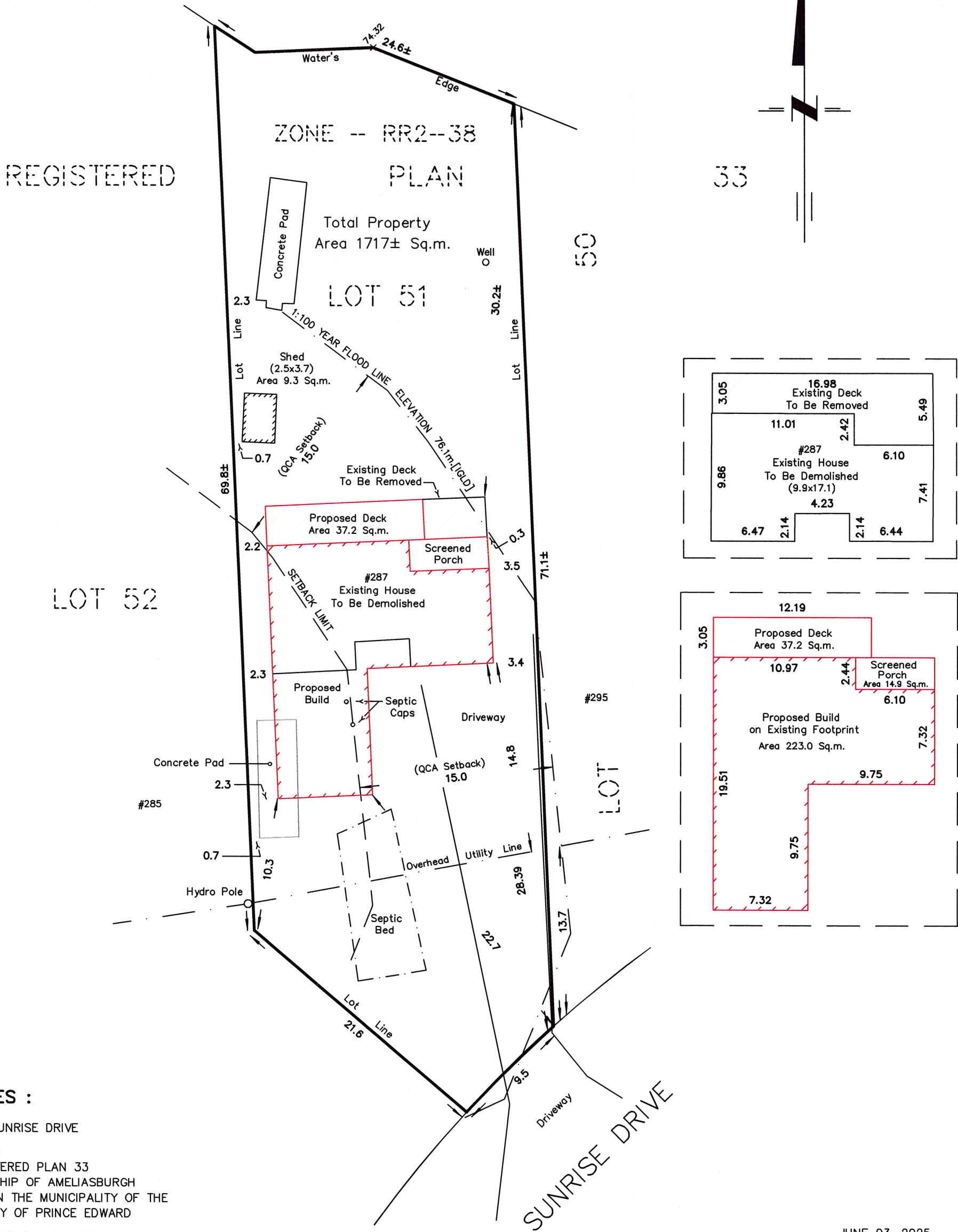

**NOTES :**

287 SUNRISE DRIVE  
 LOT 51  
 REGISTERED PLAN 33  
 TOWNSHIP OF AMELIASBURGH  
 NOW IN THE MUNICIPALITY OF THE  
 COUNTY OF PRINCE EDWARD

DIMENSIONS AND INFORMATION SHOWN ARE DERIVED FROM REGISTERED PLAN 33 AND FIELD WORK.

BY-LAY 1816-2006, ZONE RR2-38: MINIMUM INTERIOR SIDE YARD SETBACK-3.0m.

1:100 YEAR FLOOD LINE ELEVATION-76.1m.[IGLD] AND THE 15.0m. SETBACK - PER QUINTE CONSERVATION.

EXTERIOR OPENINGS, ELECTRICAL & HEATING EQUIPMENT & F.F.E. ALL ABOVE 77.0m. DEVELOPED AREA, INCLUDING SEPTIC TANKS & WEEPING BEDS ABOVE 75.9m.

DISTANCES SHOWN ON THIS PLAN ARE IN METRES AND CAN BE CONVERTED TO FEET BY DIVIDING BY 0.3048.

SEPTIC SERVICES SHOWN ON THIS SKETCH WERE MADE BY BEST OBSERVABLE FIELD EVIDENCE.

JUNE 03, 2025

**CAUTION**

THIS IS NOT A PLAN OF SURVEY AND SHALL NOT BE USED EXCEPT FOR THE PURPOSE INDICATED IN THE TITLE BLOCK

218 CHURCH STREET  
 BELLEVILLE, ONTARIO

**WATSON**  
 LAND SURVEYORS Ltd.

K8N - 3C3  
 (613) 962 - 9521