

NOTES: COORDINATE EXACT ANCHORING REQUIREMENTS AND CONCRETE BASE DIAMETER WITH POLE MANUFACTURER

DETAIL #1 - AREA LIGHT FIXTURE POLE BASE DETAIL  
SCALE: NTS

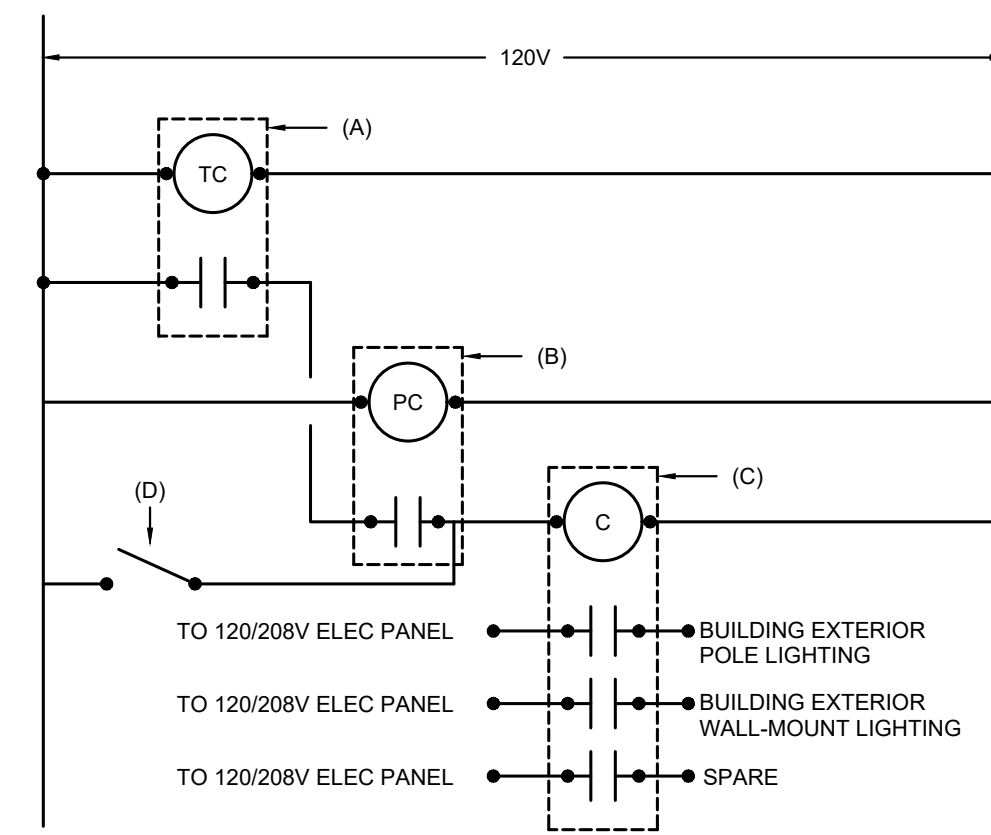

- A. 7 DAY, 24 HOUR PROGRAMMABLE TIMECLOCK, SPST, 120V COIL, 10A RATED CONTACTS
- B. PHOTO CELL, 120V, 2000W RATED MOUNTED ON EXTERIOR OF BUILDING
- C. LIGHTING CONTACTOR, 120V COIL, 20A 120V RATED CONTACTS IN TYPE 1 ENCLOSURE
- D. 20A, 120V SPST SWITCH

SITE LIGHTING CONTROL SCHEMATIC  
SCALE: NTS

LIGHTING FIXTURES SCHEDULE				
FIXTURE TAG	DESCRIPTION AND MODEL SERIES	INPUT	LIGHT SOURCE	MOUNTING
ZA	DARK SKY COMPLIANT POLE MOUNTED LED AREA LIGHTING FIXTURE C/W MOTION SENSOR. OUTPUT TO 50% WHEN VACANCY IS DETECTED. PROVIDE LITHONIA POLE AND MOUNTING KIT. LITHONIA: DSX1 SERIES OR APPROVED EQUIVALENT	120V 184W	LED 21,066L 3000K 80CRI T2M HS	POLE MOUNTED @ 6.1m (~20'-0")
ZB	DARK SKY COMPLIANT POLE MOUNTED LED AREA LIGHTING FIXTURE C/W MOTION SENSOR. OUTPUT TO 50% WHEN VACANCY IS DETECTED. PROVIDE LITHONIA POLE AND MOUNTING KIT. LITHONIA: DSX1 SERIES OR APPROVED EQUIVALENT	120V 184W	LED 22,613L 3000K 80CRI T5W	POLE MOUNTED @ 6.1m (~20'-0")
YA	DARK SKY COMPLIANT EXTERIOR LED WALL LUMINAIRE C/W PHOTOCELL. LITHONIA: WDGE2 SERIES OR APPROVED EQUIVALENT	120V 19W	LED 1,963L 3000K 80CRI T2M	WALL MOUNTED @ 3.2m (~10'-6")
YB	DARK SKY COMPLIANT EXTERIOR LED WALL LUMINAIRE C/W PHOTOCELL. LITHONIA: WDGE2 SERIES OR APPROVED EQUIVALENT	120V 47W	LED 4,065L 3000K 80CRI T3M	WALL MOUNTED @ 3.2m (~10'-6")
YC	DARK SKY COMPLIANT EXTERIOR LED WALL LUMINAIRE C/W PHOTOCELL. LITHONIA: WDGE2 SERIES OR APPROVED EQUIVALENT	120V 47W	LED 3,978L 3000K 80CRI T4M	WALL MOUNTED @ 3.2m (~10'-6")
YD	DARK SKY COMPLIANT EXTERIOR LED WALL LUMINAIRE C/W PHOTOCELL. LITHONIA: WDGE2 SERIES OR APPROVED EQUIVALENT	120V 47W	LED 4,002L 3000K 80CRI TFTM	WALL MOUNTED @ 3.2m (~10'-6")

NOTES:  
 • PROVIDE ALL NECESSARY MOUNTING HARDWARE FOR A COMPLETE INSTALLATION.  
 • DISTRIBUTION TYPE(S) COMMENTS:  
 • HS DENOTES "HOUSESIDE SHIELD"  
 • T5W DENOTES "TYPE 5 WIDE DISTRIBUTION OPTICS"  
 • T2M DENOTES "TYPE 2 MEDIUM"  
 • T3M DENOTES "TYPE 3 MEDIUM"  
 • T4M DENOTES "TYPE 4 MEDIUM"  
 • TFTM DENOTES "TYPE 'FORWARD THROW' MEDIUM"

**Callidus Engineering**  
We Make Buildings Work

LONDON: 1385 North Routledge Park, Unit 9  
London, ON N6H 5N5 P 519.472.7640

KINGSTON: 1471 John Counter Blvd. Unit 301  
Kingston, ON K7M 8S8 P 613.900.0845

KITCHENER: 210-137 Glasgow Street, Office #141  
Kitchener, ON N2G 4X6 P 519.472.7640  
W www.callidus.ca E info@callidus.ca

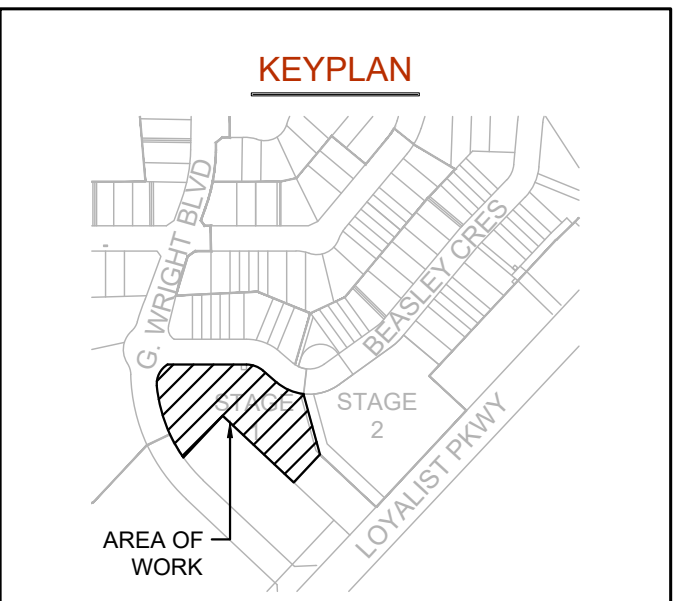

**PRELIMINARY  
NOT FOR  
CONSTRUCTION**

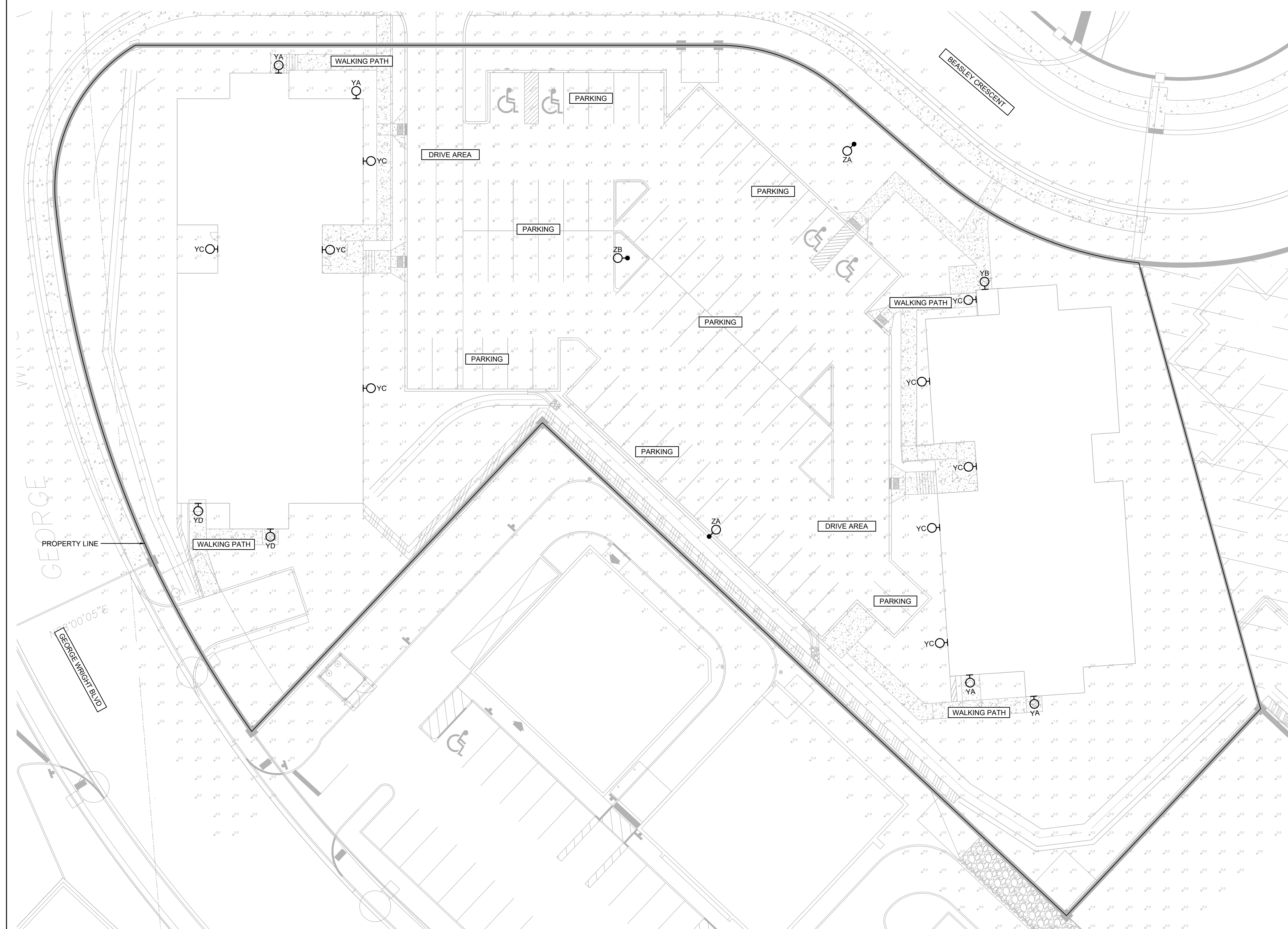

PHOTOMETRIC ILLUMINANCE STATISTICS						
LOCATION	SYMBOL	Lavg (fc)	Lmax (fc)	Lmin (fc)	Lmax/Lmin (fc)	Lavg/Lmin (fc)
DRIVE AREA	✕	2.1	3.0	0.8	3.8	2.6
PARKING	◇	1.8	4.0	0.5	8.0	3.5
WALKING PATHS	✕	2.6	7.6	0.6	12.7	4.3

LIGHTING LEGEND	
SYMBOL	DESCRIPTION
○	POLE LIGHT
♀	WALL MOUNT LIGHT FIXTURE

REVISIONS		
NO.	ISSUED FOR	DATE
00	COORDINATION	AUG 1, 2024
01	CLIENT REVIEW	DEC 13, 2024
02	CLIENT REVIEW	MAY 27, 2025
03	CLIENT REVIEW	SEP 19, 2025
04	SITE PLAN CONTROL	SEP 25, 2025

**NORTH**

**L. T. A. NGUYEN**  
100183976  
25.09.25  
PROFESSIONAL ENGINEER  
PROVINCE OF ONTARIO

DESIGN	DL	DRAWN	DL
CHECKED	LN	REVIEWED	LN

**PROJECT**  
WEST MEADOWS PH.2  
EXTERIOR LIGHTING

**ADDRESS**  
LOYALIST & COUNTY RD. 4,  
PICTON, ONTARIO

**PROJECT NO.**  
CE-5121d

**DRAWING TITLE**  
ELECTRICAL  
SCHEDULES, DETAILS &  
PHOTOMETRIC SITE PLAN

**DRAWING NUMBER**  
E0.0 OF 1

SITE PLAN - PHOTOMETRICS  
SCALE: 1:250