

COMMERCIAL UNIT-RENOVATION

170, County Road 29 Consecon, ON K0K 1T0

AUG 25/2025
RAJ.BALASUNDARAM
BCIN:116014

THE UNDERSIGNED HAS REVIEWED AND TAKES RESPONSIBILITY FOR THIS DESIGN, AND HAS THE QUALIFICATIONS AND MEETS THE REQUIREMENTS SET OUT IN THE ONTARIO BUILDING CODE TO BE DESIGNER.
QUALIFICATION INFORMATION:
REQUIRED UNLESS DESIGN IS EXEMPT UNDER 3.2.5.1 OF THE BUILDING REGISTRATION INFORMATION:
REQUIRED UNLESS DESIGN IS EXEMPT UNDER 3.2.5.1 OF THE BUILDING REGISTRATION INFORMATION:
REQUIRED UNLESS DESIGN IS EXEMPT UNDER 3.2.5.1 OF THE BUILDING REGISTRATION INFORMATION:

DRAWING SETS ISSUED	No.	DATE (DD,MM,YY)	BY
ISSUED FOR PRE REVIEW	1.	2024 OCT 7TH	
ALL PREVIOUS ISSUES OF THIS DRAWING ARE SUPERSEDED			

CONTRACTOR MUST CHECK AND VERIFY ALL DIMENSIONS AND JOB CONDITIONS BEFORE PROCEEDING WITH WORK.
ALL DRAWINGS MAY BE TO BE SUBJECT TO CHANGE DUE TO COMMENTS FROM MUNICIPAL DEPARTMENTS AND OTHER AGENCIES WITH AUTHORITY.
DO NOT SCALE.
REPORT DISCREPANCIES.

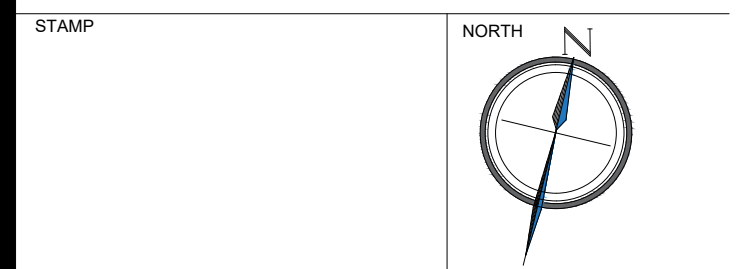

R+A DESIGN
BCIN205650
14 RIVERMERE CRT.
BRAMPTON ON, L7A 1R4, CANADA
PHONE: 647 528 4209
E.MAIL: ra.arch.ca@gmail.com

PROJECT
COMMERCIAL UNIT

PROJECT ADDRESS
170, County Road 29
Consecon, ON K0K 1T0

PAGE TITLE

CLIENT









SCALE N.T.S



DATE 14 AUG 2025

PROJECT No.

DRAWING NUMBER

DOOR SCHEDULE				EQUIPMENT LEGEND			
DOOR NO.	TYPE	SIZE	REMARK	NO	SPECIFICATION	SIZE	QTY.
D1	INTERIOR DOOR	3'8" X 7'	GLASS DOOR				
D2	INTERIOR DOOR	2'6" X 7'	DOOR T/B FIN IN PL-1, S.S. PLATE ON PUSH SIDE, B.F. D-PULL ON PULL SIDE WITH SPRING ACTION HINGES INWARDS, KICK PLATE.	1	GRIDDLE	2'-6" X 2'-6"	1
ED3	EXTERIOR DOOR	5'0" X 7'	DOOR-WEATHER STRIP	2	SINGLE FRYER	1'-6" X 2'-6"	2
D3	INTERIOR DOOR	2'6" X 7'	WOODEN DOOR	3	BURGER GRILL	2'-6" X 2'-6"	1
				4	PREP TABLE		1

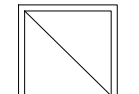
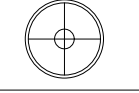
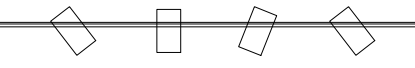
WALL TYPE SCHEDULE		LEGEND:	
EXTERIOR WALL TYPES		 WALL TO BE DEMOLISHED	
	EXISTING DEMISING WALL - 8" CMU	 EXISTING WALL	
INTERIOR WALL TYPES		 NEW WALL	
WALL TYPE MARK	DESCRIPTION		
	EXISTING EXTERIOR WALL (2Hr FRR)		
	PROPOSED 1/2" GYP BD ON 1/2" RESILIENT FURRING CHANNELS @ 16" O.C.		
	EXISTING 1/2" GYP BD ON 1/2" RESILIENT FURRING CHANNELS @ 16" O.C.		
	1 h FRR DEMISING WALL		

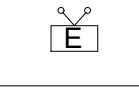
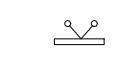
LIGHTING LEGEND		
SYMBOL	NO	SPECIFICATION
	LT-01	2'X2' T- BAR LIGHT
	LT-02	PENDANT LIGHT
	LT-03	6' TRACK LIGHT WITH 3 HEADS
	LT-04	2" PIN LIGHTS
	LT-05	4" POT LIGHT
	LT-06	EXIT LIGHT C/W EMERGENCY LIGHT
	LT-07	EMERGENCY LIGHT

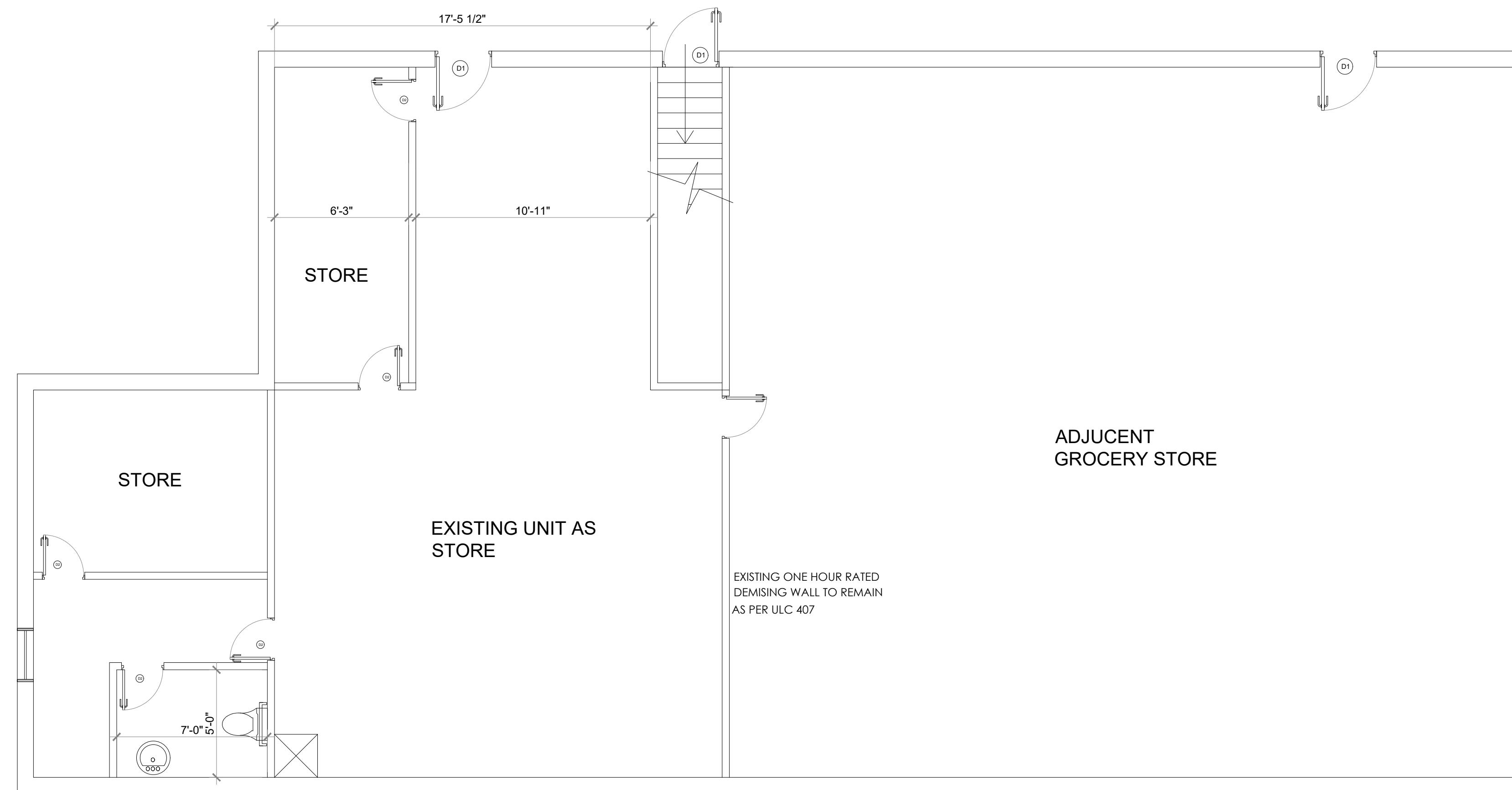

1 EXISTING PLAN
A103 3/8" = 1'0"

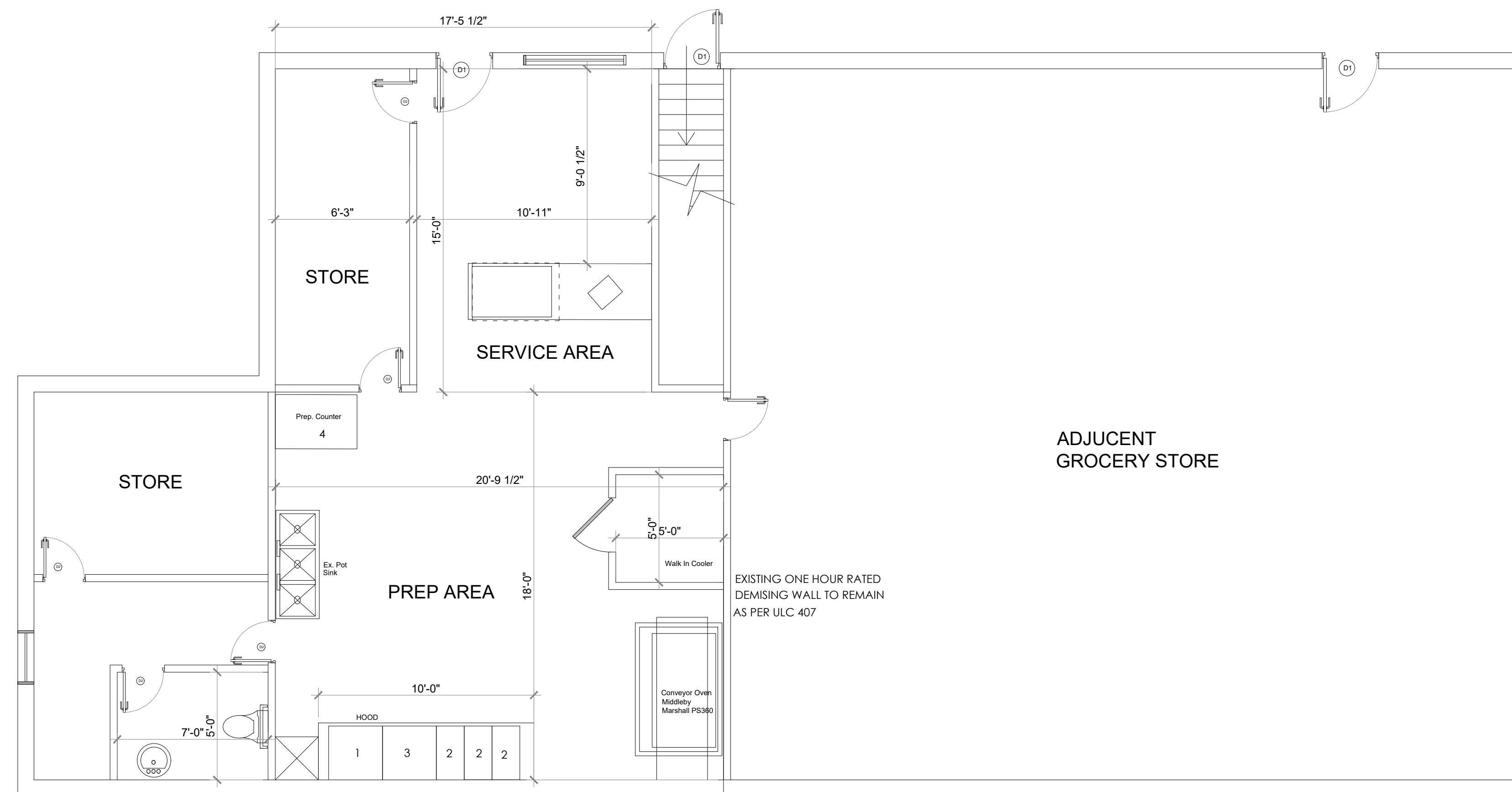

2 PROPOSED PLAN
A103 3/8" = 1'0"

Raj AUG 25/2025
RAJ.BALASUNDARAM
 BCIN:116014

THE UNDERSIGNED HAS REVIEWED AND TAKES RESPONSIBILITY FOR THIS DESIGN, AND HAS THE QUALIFICATIONS AND MEETS THE REQUIREMENTS SET OUT IN THE ONTARIO BUILDING CODE TO BE DESIGNER.
 QUALIFICATION INFORMATION:
 REQUIRED UNLESS DESIGN IS EXEMPT UNDER 3.2.5.1 OF THE BUILDING REGISTRATION INFORMATION:
 REQUIRED UNLESS DESIGN IS EXEMPT UNDER 3.2.5.1 OF THE BUILDING REGISTRATION INFORMATION:

DRAWING SETS ISSUED	DATE No. (DD,MM,YY)	BY
ISSUED FOR PRE REVIEW	1, 2024 OCT 7TH	

ALL PREVIOUS ISSUES OF THIS DRAWING ARE SUPERSEDED
 CONTRACTOR MUST CHECK AND VERIFY ALL DIMENSIONS AND JOB CONDITIONS BEFORE PROCEEDING WITH WORK
 ALL DRAWINGS MAY BE TO BE SUBJECT TO CHANGE DUE TO COMMENTS FROM MUNICIPAL DEPARTMENTS AND OTHER AGENCIES WITH AUTHORITY
 DO NOT SCALE
 REPORT DISCREPANCIES.

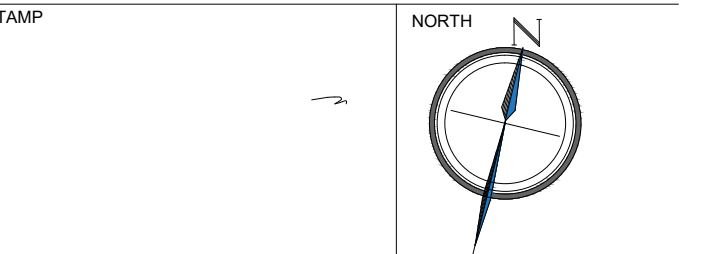

R+A DESIGN
 BCIN205650
 14 RIVERMERE CRT.
 BRAMPTON ON, L7A 1R4, CANADA
 PHONE: 647 528 4209
 E.MAIL: ra.arch.ca@gmail.com

PROJECT
PIZZA SHOP

PROJECT ADDRESS
 170, County Road 29
 Consecn, ON K0K 1T0

PAGE TITLE
FLOOR PLAN

CLIENT

SCALE

DATE 14 AUG 2025

PROJECT No.

DRAWING NUMBER

A1.03