



Y:\project\files\2021\12\1-14\_redtail\_vineyard\_consecon\3\_production\02\_drawings\03\_CAD\sheets\1-14\_Redtail\_Vineyard\_Consecon\_SPCA6\_Landscape\_Plan.dwg

PLOT DATE: March 27, 2028

**PLANTING SCHEDULE**

ITEM	BOTANICAL NAME	COMMON NAME	SIZE/CONDITION	SPACING (mm)	QTY
<b>DECIDUOUS TREES</b>					
AS	<i>Acer saccharum</i>	Silver Maple	45mm WB	-	-
RESERVED					
LL	<i>Larix laricina</i>	Tamarack	45mm WB	-	-
PT	<i>Populus tremuloides</i>	Trembling Aspen	250cm 15g	-	-
QR	<i>Quercus rubra</i>	Red Oak	45mm WB	-	-
<b>CONIFEROUS TREES</b>					
PB	<i>Pinus banksiana</i>	Jack Pine	150cm WB	-	-
PG	<i>Picea glauca</i>	White Spruce	150cm WB	-	-
PS	<i>Pinus strobus</i>	Eastern White Pine	150cm WB	-	-

BOTANICAL NAME	COMMON NAME	QTY	BOTANICAL NAME	COMMON NAME	QTY
<b>SEED MIX: Rural Ontario Roadside Native Seed Mixture (8145)</b>					
<i>Elymus canadensis</i>	Canada Wild Rye	24%	<i>Verbena hastata</i>	Blue Vervain	2%
<i>Elymus virginicus</i>	Virginia Wild Rye	22%	<i>Penstemon digitalis</i>	Foxglove/Beardtongue	2%
<i>Sorghastrum nutans</i>	Indiangrass	20%	<i>Aster novae-angliae</i>	New England Aster	2%
<i>Schizachyrium scoparium</i>	Little Bluestem	20%	<i>Eupatorium perfoliatum</i>	Boneset	1%
<i>Desmodium canadense</i>	Showy Tick Trefoil	3%	<i>Liatris spicata</i>	Dense Blazing Star	1%
<i>Rudbeckia hirta</i>	Black Eyed Susan	2%	<i>Monarda fistulosa</i>	Wild Bergamot	1%

**Landscape Buffer Planting Schedule**

2  
NTS  
SPCA-6.3

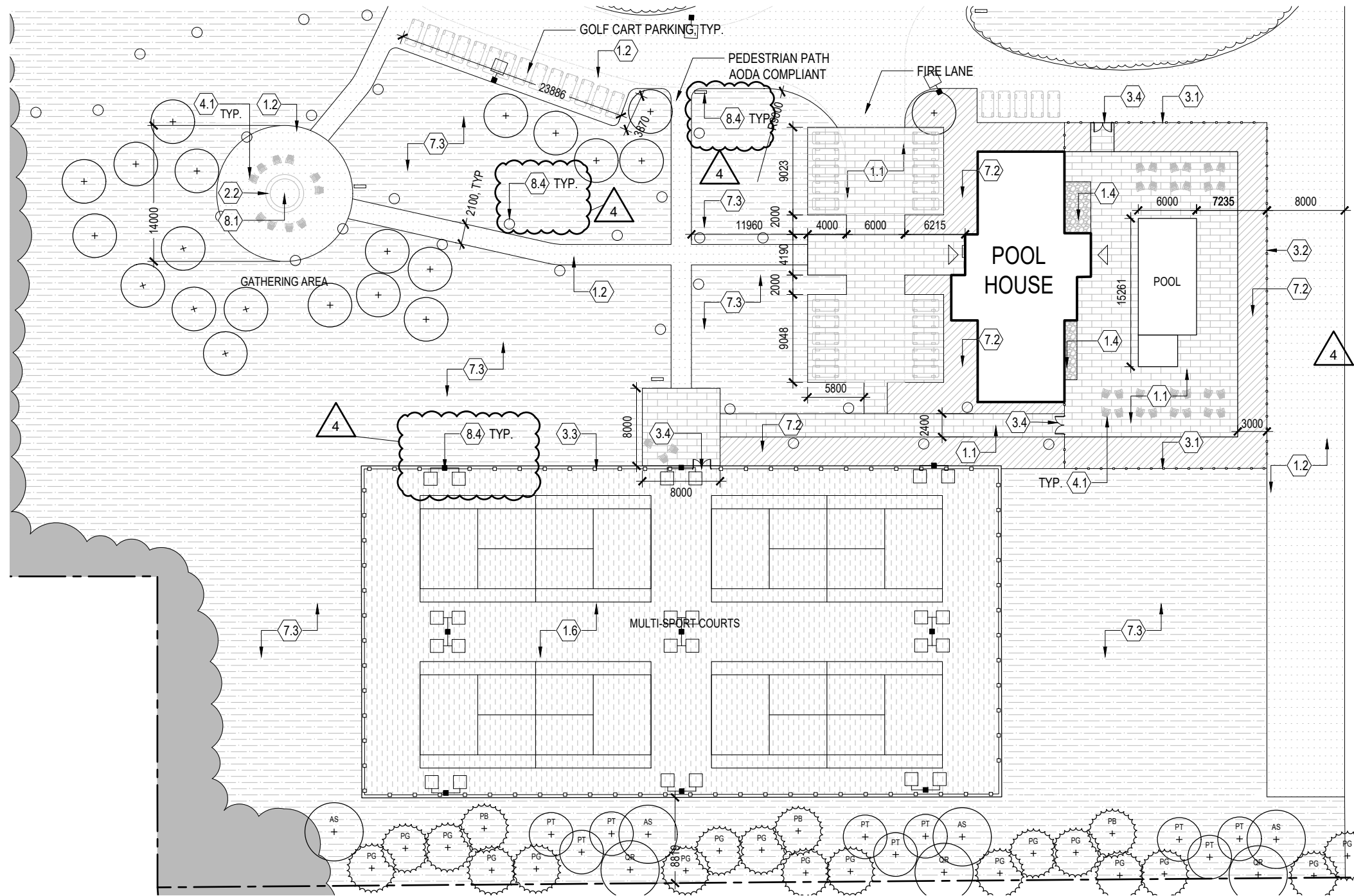

**Recreation Area Landscape Plan - Proposed**

1  
1:500  
SPCA-6.3

**SITE DETAIL KEY NOTES**

- 1.0 PAVEMENTS**
  - 1.1 UNIT PAVING
  - 1.2 CRUSHED LIMESTONE SCREENINGS (STABILIZED & REINFORCED)
  - 1.3 RESERVED
  - 1.4 RIVER STONE
  - 1.5 CAST-IN-PLACE CONCRETE CURB
  - 1.6 LIGHT DUTY ASPHALT (WITH ACRYLIC TOPPING)
- 2.0 SITE WALLS / EMBANKMENTS**
  - 2.1 MASONRY FREE STANDING SCREEN WALL (240MM HEIGHT)
  - 2.2 MASONRY SEAT WALL (500MM HEIGHT)
- 3.0 FENCES AND RAILINGS**
  - 3.1 TIMBER FENCE 1830MM
  - 3.2 TIMBER FENCE 1500MM
  - 3.3 METAL CHAIN LINK FENCE (3000MM HEIGHT)
  - 3.4 FENCE GATE
- 4.0 SITE FURNITURE**
  - 4.1 OUTDOOR CHAIR
- 7.0 SOFTSCAPE**
  - 7.1 SOD
  - 7.2 PLANTING BED
  - 7.3 MEADOW, HYDROSEEDDED
  - 7.4 NATURALIZED UNDERSTORY PLANTING
- 8.0 MISCELLANEOUS SITE FEATURES**
  - 8.1 FIRE PIT
  - 8.2 PARKING CURB STOP (72")
  - 8.3 BARRIER-FREE PARKING SIGN ON POST
  - 8.4 SITE LIGHTING (REFER TO ELEC)

**LEGEND**

- 1.0 PAVEMENTS**
  - UNIT PAVING
  - LIGHT DUTY ASPHALT (WITH ACRYLIC TOPPING)
  - CRUSHED LIMESTONE
  - RIVERSTONE
- 7.0 SOFTSCAPE**
  - SOD
  - PLANTING BED
  - MEADOW
  - NATURALIZED UNDERSTORY PLANTING

This drawing is the property of E.R.A. Architects Inc. and may not be used or reproduced without expressed approval. Refer to Engineering drawings before proceeding with work. The Contractor shall verify all dimensions and levels on site and report any discrepancies to E.R.A. before beginning work. Do not scale from the drawings. Use figured dimensions only. The Contractor is responsible for any changes made to the drawings without E.R.A.'s approval.

NO.	DATE	ISSUED FOR
1	2025-05-26	SPCA
2	2025-09-15	SPCA R1
3	2025-12-17	SPCA R1 - ADDENDUM 1
4	2026-03-26	SPCA R2

**NOT FOR CONSTRUCTION**

**LEGEND**

- EXISTING
- PROPOSED

**RECREATION AREA LANDSCAPE NOTES:**

- REFER TO ARCHITECTURAL DRAWINGS FOR POOL HOUSE AND POOL DETAILS.
- REFER TO CIVIL FOR STORMWATER MANAGEMENT FACILITIES AND SERVICING DETAILS.

**E R A**  
 info@erasarch.ca | www.erasarch.ca  
 T 416.963.4497 | F 416.963.8761  
 625 Church Street, Suite 600  
 Toronto, ON, Canada, M4Y 2G1  
**E.R.A. Architects Inc.**

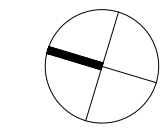

Project  
**Redtail East Hotel and Nordic Spa**  
 Address Con. 3, Loyalist Pkwy., Consecon, ON  
 For Blocknote Canada Inc.  
 Project no. 21-114  
 Scale at 11x17 1:1000  
 Drawn by KK, SC, JW  
 Reviewed by KK, SL, RF  
 Drawing title

**Recreation Area Landscape Plan - Proposed**

Sheet no.

**SPCA-6.3**